

T-6269

WATER RIGHTS TRANSFER
APPLICATION MAP

for:

ROBERT E. FLOWEREE

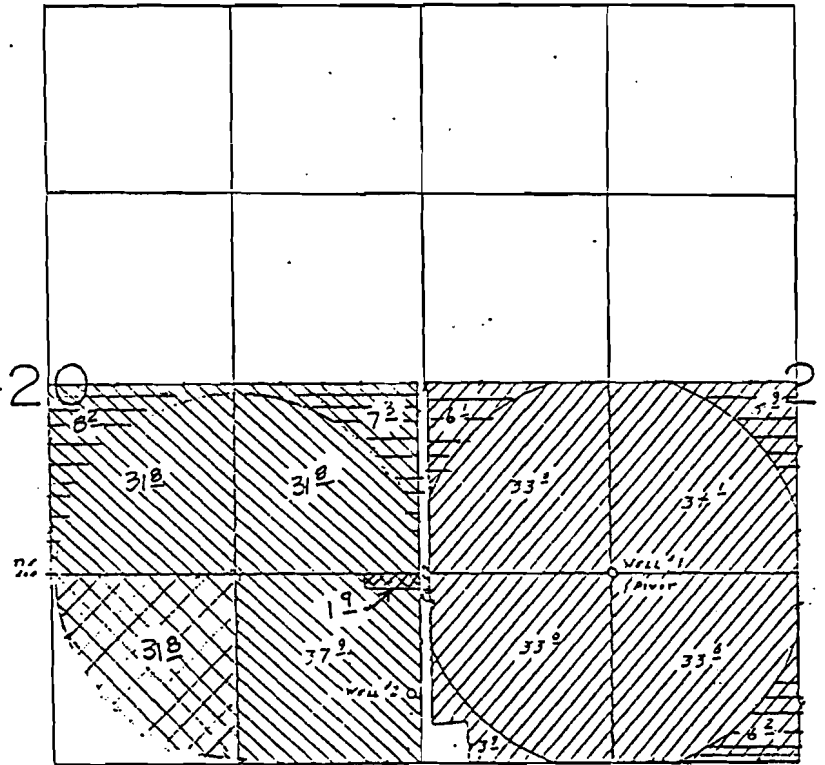

TOWNSHIP 27 SOUTH, RANGE 18 EAST
LAKE COUNTY, OREGON

RECEIVED
JUL 25 1988
WATER RESOURCES DIV.
G-7849
53145
63838
T6269
75551
T6673
76470
T8331
7647
T6673
T8331



Wells Loc: "1- 1320' N. of 1330' E.; "2- 490' N. of 110' W. BORN FROM SE COR. SEC 20

Scale: 1"=1320'

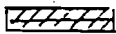
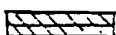
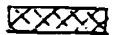
-  Well No.1
-  Well No.2
-  Well No 1 to Well No 2
-  Well No 2 relocated
-  Place of proposed use

THIS MAP IS TO BE USED
FOR WATER RIGHTS
PURPOSES ONLY.



6/23/89

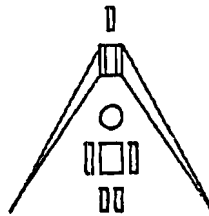

TERRASCOPE, INC.
1900 N.E. DIVISION
109 WHISTLE STOP
BEND, OR 97701
PH: (503) 382-3365

G-7849-

T.27S., R.18E., W.M.

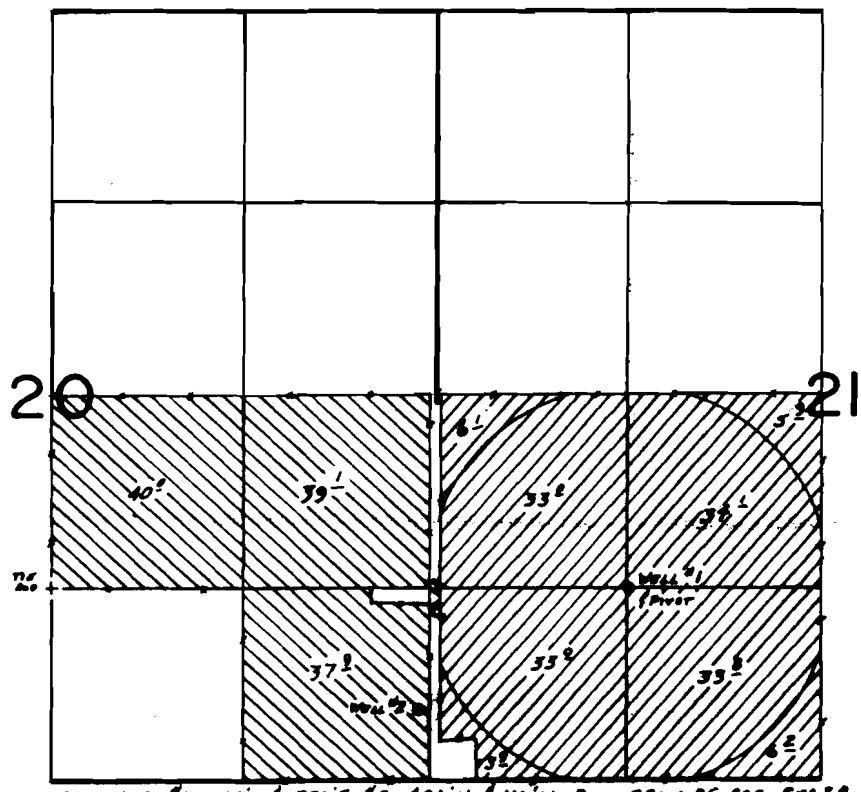
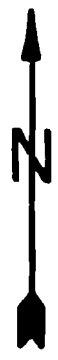

WELLS LOC: #1- 1320' N. & 1330' E.; #2- 490' N. & 110' W., BOTH FROM SE COR. SEC. 20

Scale: 1" = 1320'

- Well No. 1
- Well No. 2

See previous page
T6269

FINAL PROOF SURVEY UNDER

Application No. G-8197... Permit No. G-7849.....
IN NAME OF

WILLIAM W. & LAURENA Z. SCHMIDT

Surveyed OCT. 27... 19.84, by B.W. BISHOP.....