

T. 2 S., R. 1 W., W. M.

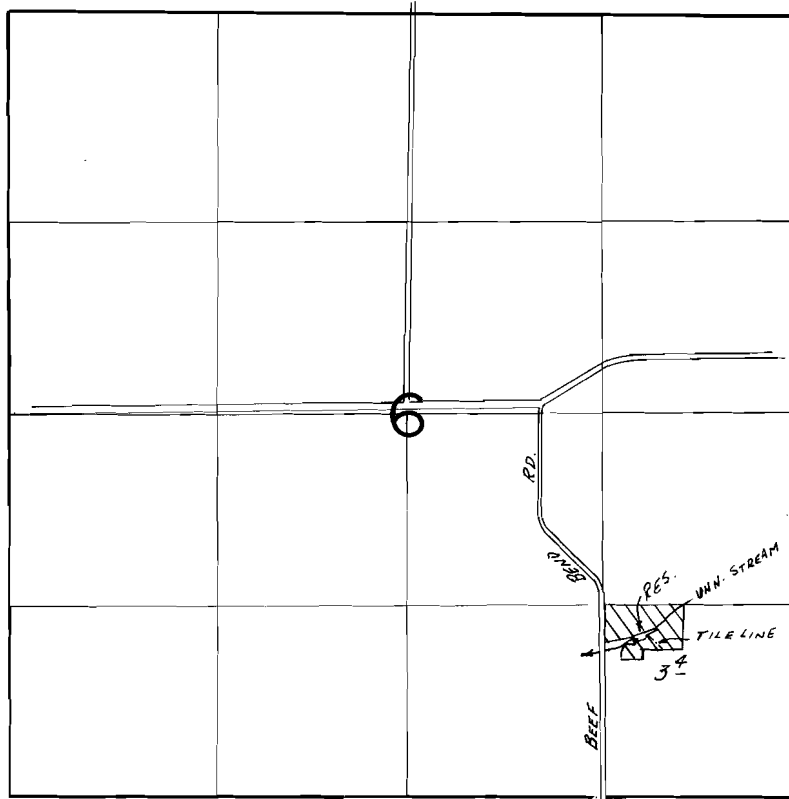

Div. Pt. Loc.: 1070' N. & 1100' W. FROM SE COR. SEC. 6.

SCALE: 1" = 1320'

FINAL PROOF SURVEY
UNDER

R-59747 R-8181
Application No. 59746... Permit No. 45190.....
IN NAME OF

.....DON ROSHAK.....

Surveyed Sept. 24, 1984, by B.W. BISHOP.....