

T. 10 S., R. 6 W., W. M.

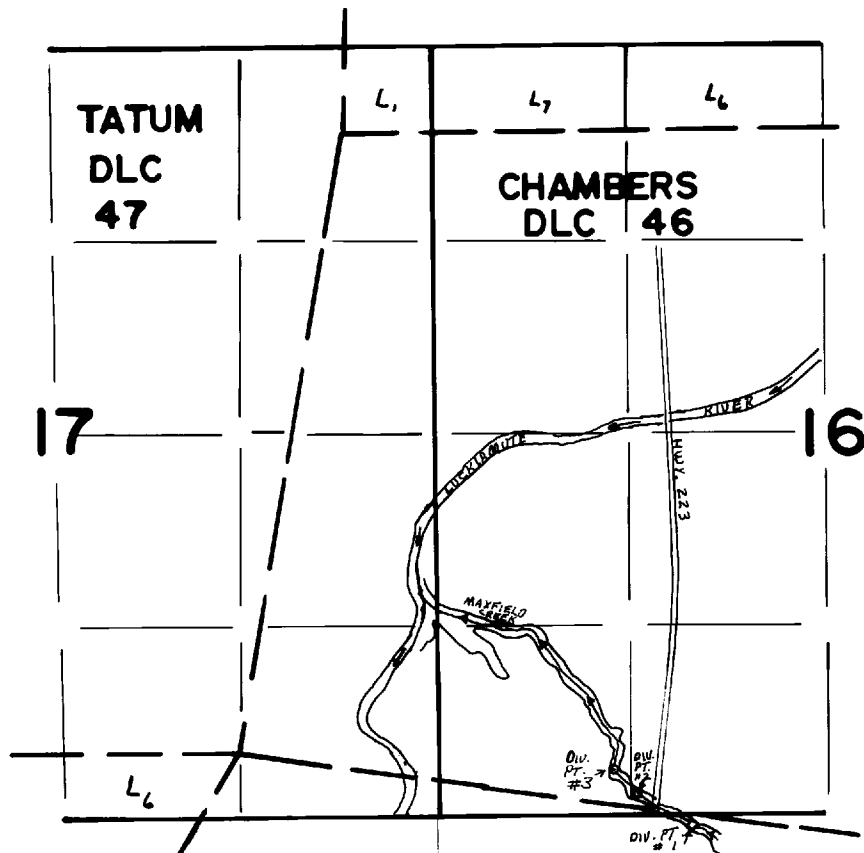

Div. Pt. 3 Loc.: 300' N. & 1220' E. from SW Cor. Sec. 16.

FINAL PROOF SURVEY

UNDER

TRANSFER 4584

Application No. Permit No.
IN NAME OF

.....**GEORGE F. STOVALL**.....

Surveyed **JUNE 10, 1983**, by**L. TOLL**.....