

35968
76447
74837
76495 N

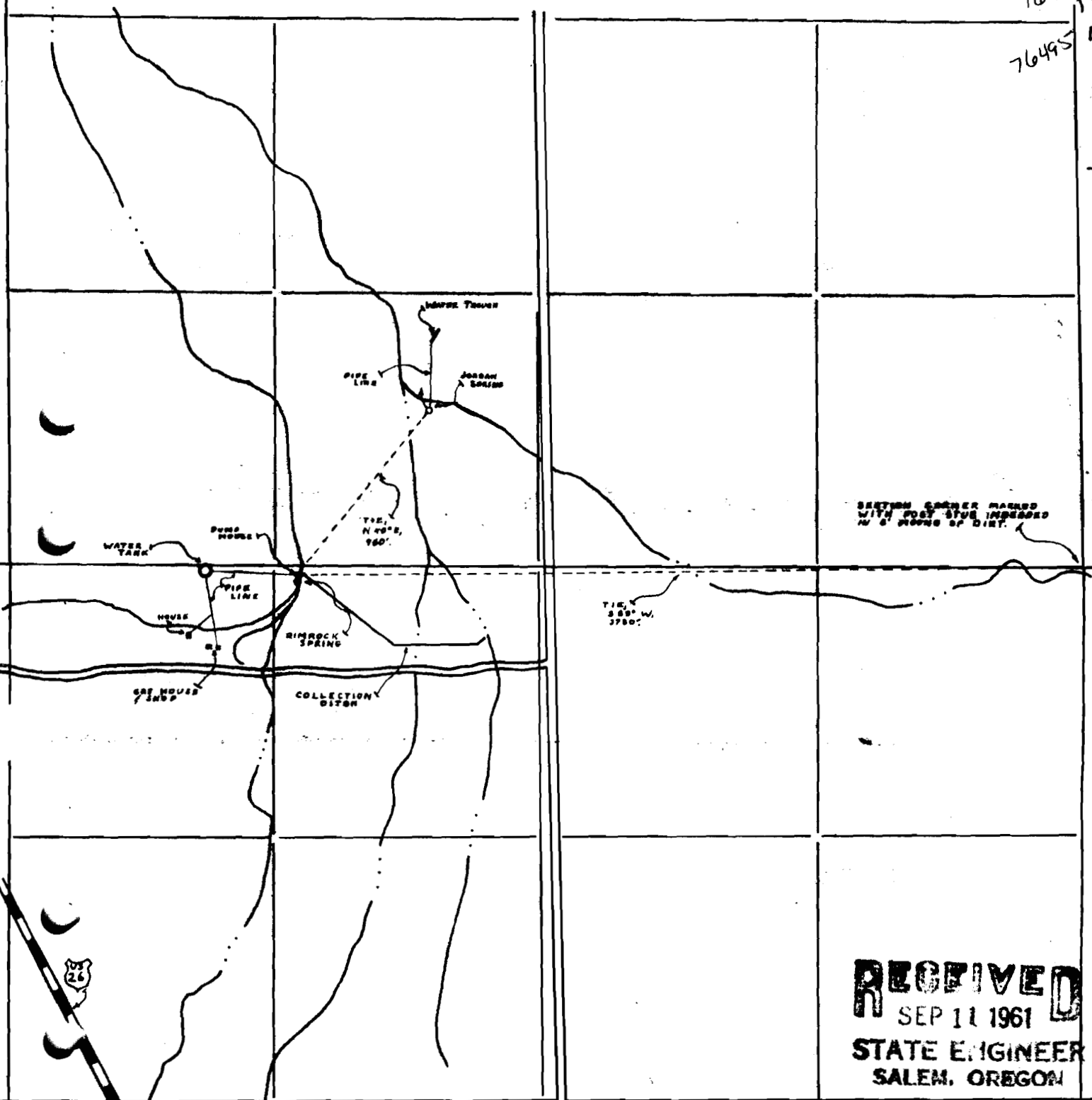

RECEIVED
 SEP 11 1961
 STATE ENGINEER
 SALEM, OREGON

Application No. **35020**
 Permit No. **27531**
CAMP SPRINGS

Drawn by: B Flint

Date 10-10-60

- LEGEND -

Intermittent Stream
 Roads

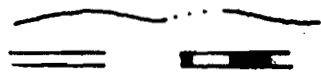

SCALE - 8 IN = 1 MI

27531