

Reference File: R-81090
Permit Number: R-11976

N
RECEIVED

APR 17 2000

WATER RESOURCES DEPT.
SALEM, OREGON

MEASUREMENT
S to N = 90'
W to E = 60'
(along top)

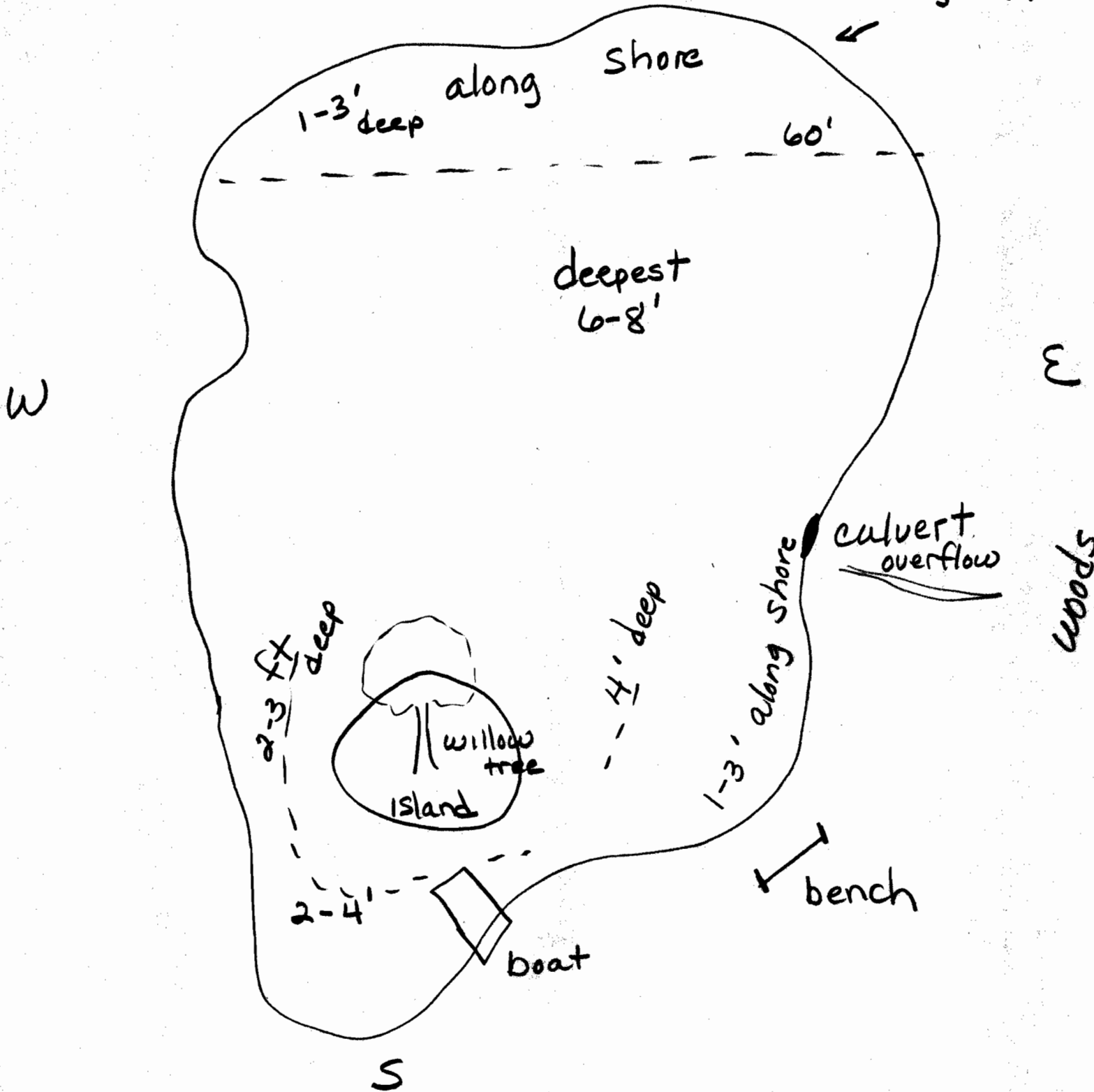

140'
150'
160
160
260
260
270
270
270
275
189
189
280

SEE MAP 37

SEE MAP 37 6 5

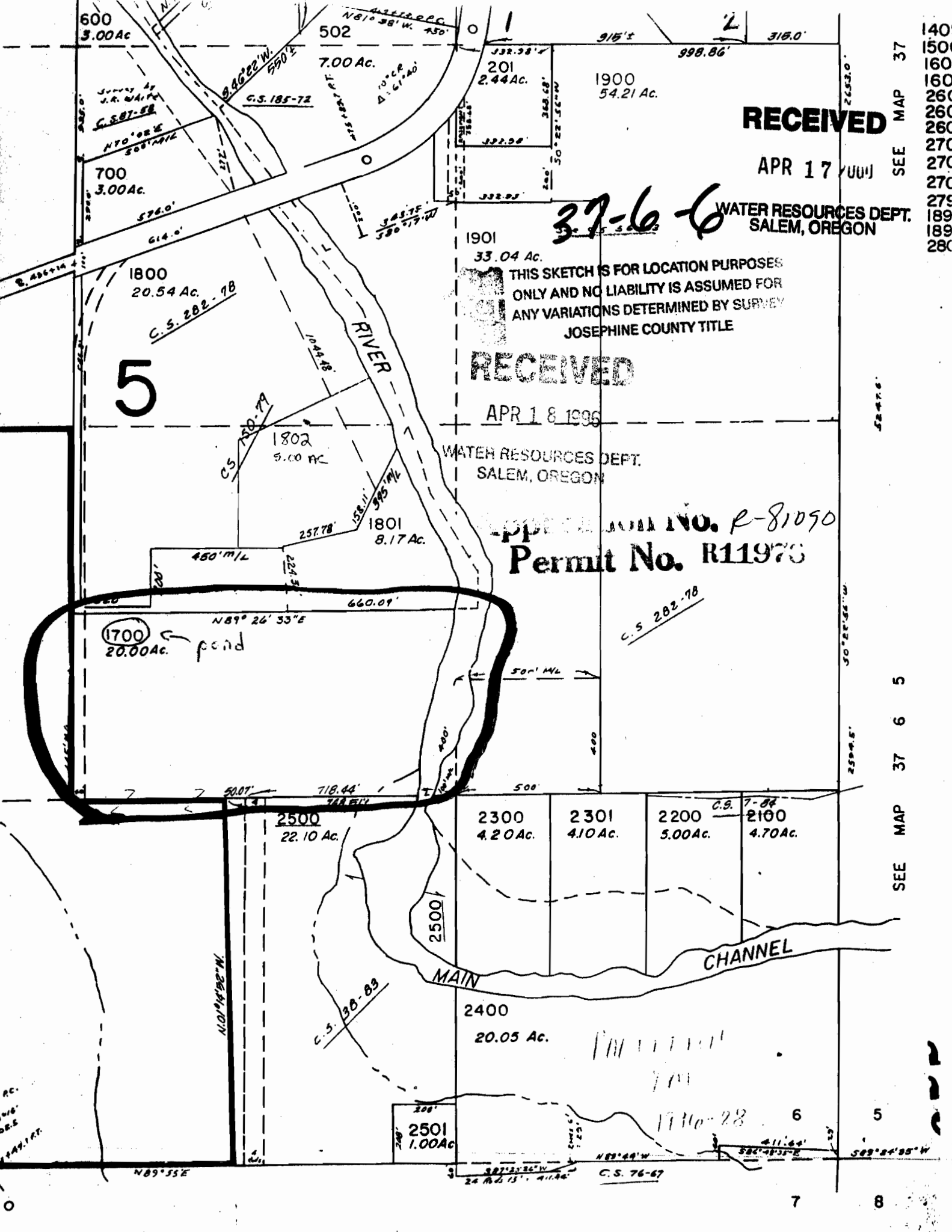

RECEIVED

APR 17 1901

WATER RESOURCES DEPT.
SALEM, OREGON

THIS SKETCH IS FOR LOCATION PURPOSES
ONLY AND NO LIABILITY IS ASSUMED FOR
ANY VARIATIONS DETERMINED BY SURVEY
JOSEPHINE COUNTY TITLE

RECEIVED

APR 18 1906

WATER RESOURCES DEPT.
SALEM, OREGON

APPLIC. NO. R-81050
Permit No. R11973

5

1700
20.00 Ac.
pond

37-6-6

CHANNEL

MAIN

6

5

7

8