

# T.4 S. R. I E. W.M.

RECEIVED

NOV 17 1999

RECORDS DEPT  
SALEM, OREGON

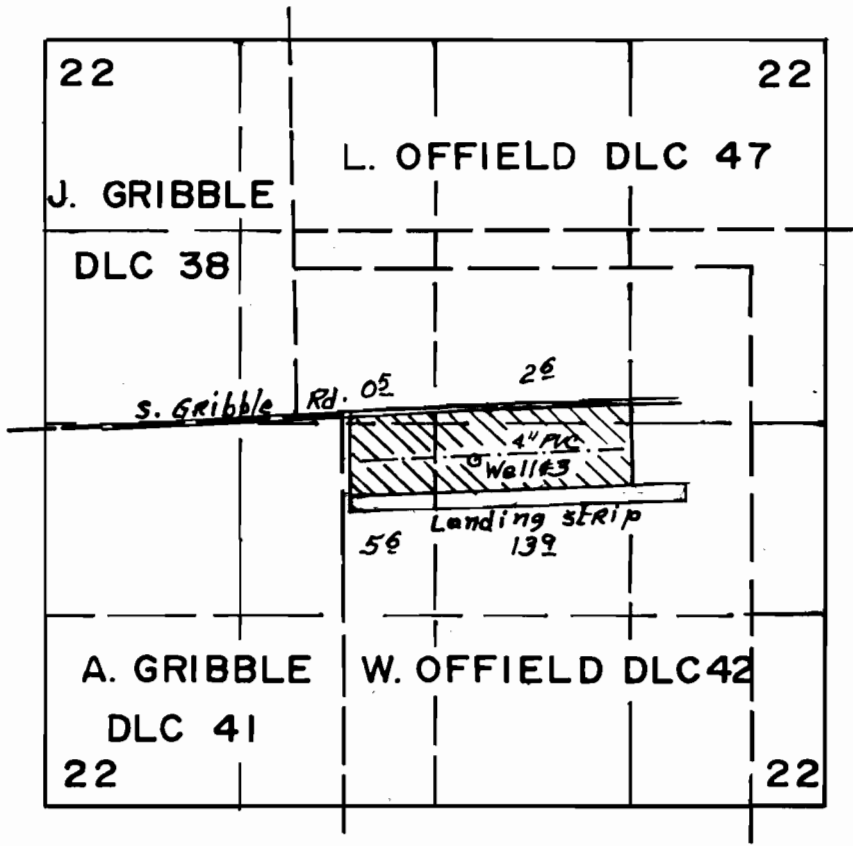

Scale  
4" = 1 Mi.

Well #3 loc: 290'S & 905'E From NE Cor. DLC 41

## FINAL PROOF SURVEY UNDER

Transfer No. T-8037  
Application No. G-1409 Permit No. G-12872..  
IN NAME OF

WORKMAN'S AIRPARK WATER ASSOCIATION, INC.

THIS MAP WAS PREPARED FOR THE PURPOSE OF IDENTIFYING THE LOCATION OF A WATER RIGHT ONLY AND IS NOT INTENDED TO PROVIDE LEGAL DIMENSIONS OR LOCATION OF PROPERTY OWNERSHIP LINES.

Surveyed Sept. 15, 1999, by .....

