

SECTION 8, T.2S., R.2W., W.M.

WASHINGTON COUNTY OREGON

RECORD

APPLICATION	PERMIT	Ac.	
G-11588	G-10863	27.0	WELL #1
G-11914	G-11064	26.9	WELL #1 #2



SCALE: 1" = 400'

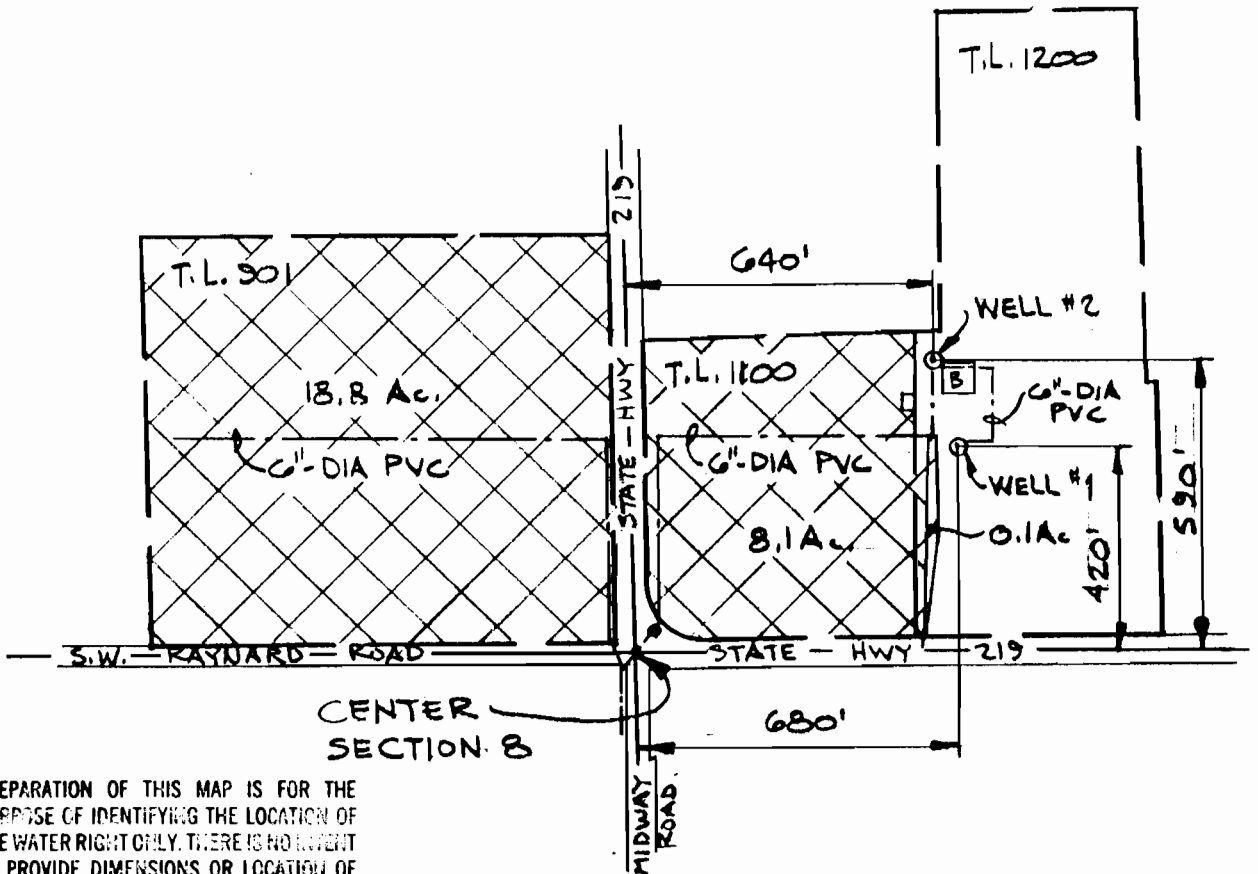

PREPARATION OF THIS MAP IS FOR THE PURPOSE OF IDENTIFYING THE LOCATION OF THE WATER RIGHT ONLY. THERE IS NO INTENT TO PROVIDE DIMENSIONS OR LOCATION OF PROPERTY OWNERSHIP LINES.

FINAL PROOF SURVEY

FOR

APPLICATIONS	PERMITS
G-11588	G-10863
G-11914	G-11064
SURVEYED JUNE 8, 1993	

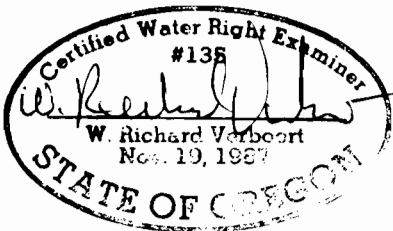

VERBOORT ENGINEERING
 AGRICULTURE - CIVIL - WATER RESOURCES
 HILLSBORO, OREGON

by date
 designed WRY 6-8-93
 drawn JER 6-27-93
 checked WRY 6-27-93
 drawing no. 93-A08
 sheet no. 1/1

GLENN WALTERS NURSERY, INC.
 (N.W. FARM CREDIT SERVICES)
 P.O. BOX 280
 BANKS, OR 97106