

SECTION 8, T.2S., R.2W., W.M.
WASHINGTON COUNTY, OREGON

6 5



7 8

1/4 COR.

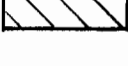

SCALE: 1" = 400'

MAP BASE: TAX ASSESSORS
MAP
1991 SCALED
PHOTO

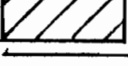
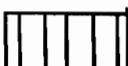
APPLICATION	PERMIT
 R-71698	R-11425
 S-71699	51390
 R-70334	R-11266
 S-70335	51137
 CERTS. G-9363, G-11225	

FINAL PROOF SURVEY
SURVEYED APRIL 28, 1993

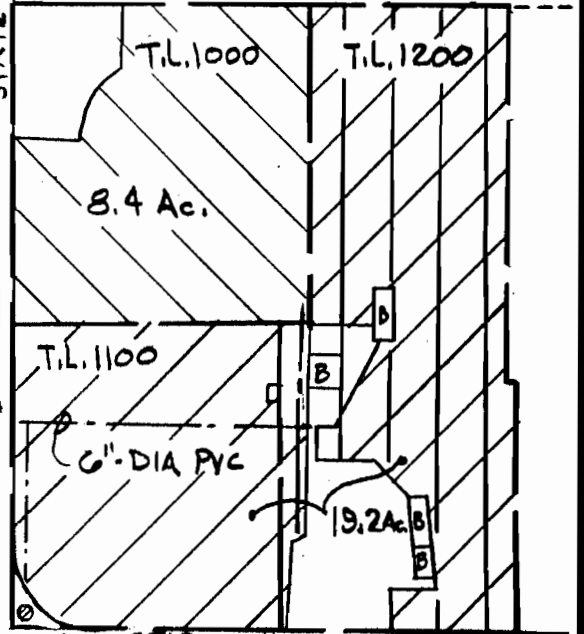
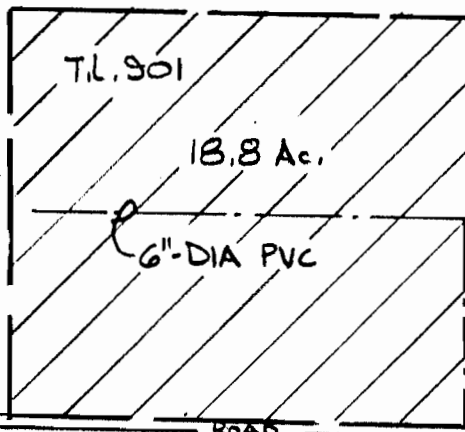

RAYNARD ROAD

ROAD

STATE HWY 219

1/4 COR

T.L. 2300

T.L. 2301

T.L. 900

8.7 Ac.

9.7 Ac.

8" DIA PVC

6" DIA PVC

13.6 Ac. RESERVOIR

8" DIA PVC

PUMP PLANT

3.5 Ac.

6" DIA PVC

6.4 Ac.

2325'

4.8 Ac.

4" DIA PVC



PREPARATION OF THIS MAP IS FOR THE
PURPOSE OF IDENTIFYING THE LOCATION OF
THE WATER RIGHT ONLY. THERE IS NO INTENT
TO PROVIDE DIMENSIONS OR LOCATION OF
PROPERTY OWNERSHIP LINES.

REVISED 6-24-93

VERBOORT ENGINEERING
AGRICULTURE • CIVIL • WATER RESOURCES
HILLSBORO, OREGON

	by	date
designed	WRV	5-11-93
drawn	JER	5-11-93
checked	WRV	5-11-93
drawing no.	93-B-11	
sheet no.	1/1	

GLENN WALTERS NURSERY, INC.
(NORTHWEST FARMS CREDIT SERVICE)
NURSERY MAILING ADDRESS:
P.O. BOX 280
BANKS, OR 97106

18

17

1/4 COR