

T.3N. R.28E. W.M.

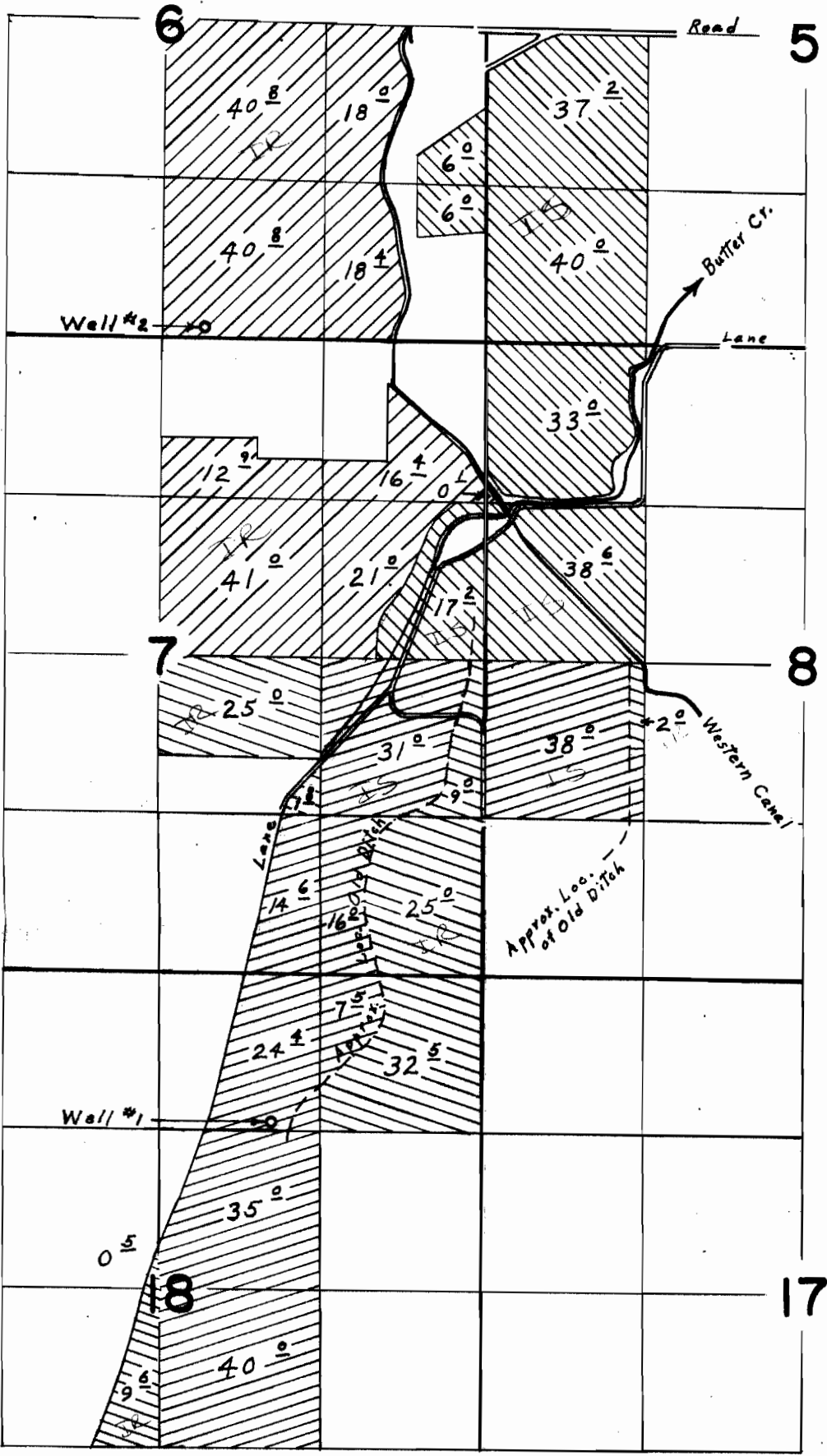

Well # 1 located 1220' S. & 1760' W. from N.E. Corner Section 18
 Well # 2 located 80' N. & 350' E. from S. $\frac{1}{4}$ Corner Section 6

Well #1 Primary	
Well #1 Supplemental	
Well #2 Primary	
Well #2 Supplemental	

FINAL PROOF SURVEY

UNDER

Application No. G-3939 Permit No. G-3530

IN NAME OF

STONE MACHINERY CO.

Surveyed April 14, 1973, by L. E. Gould