

# T.3N. R.28E. W.M.

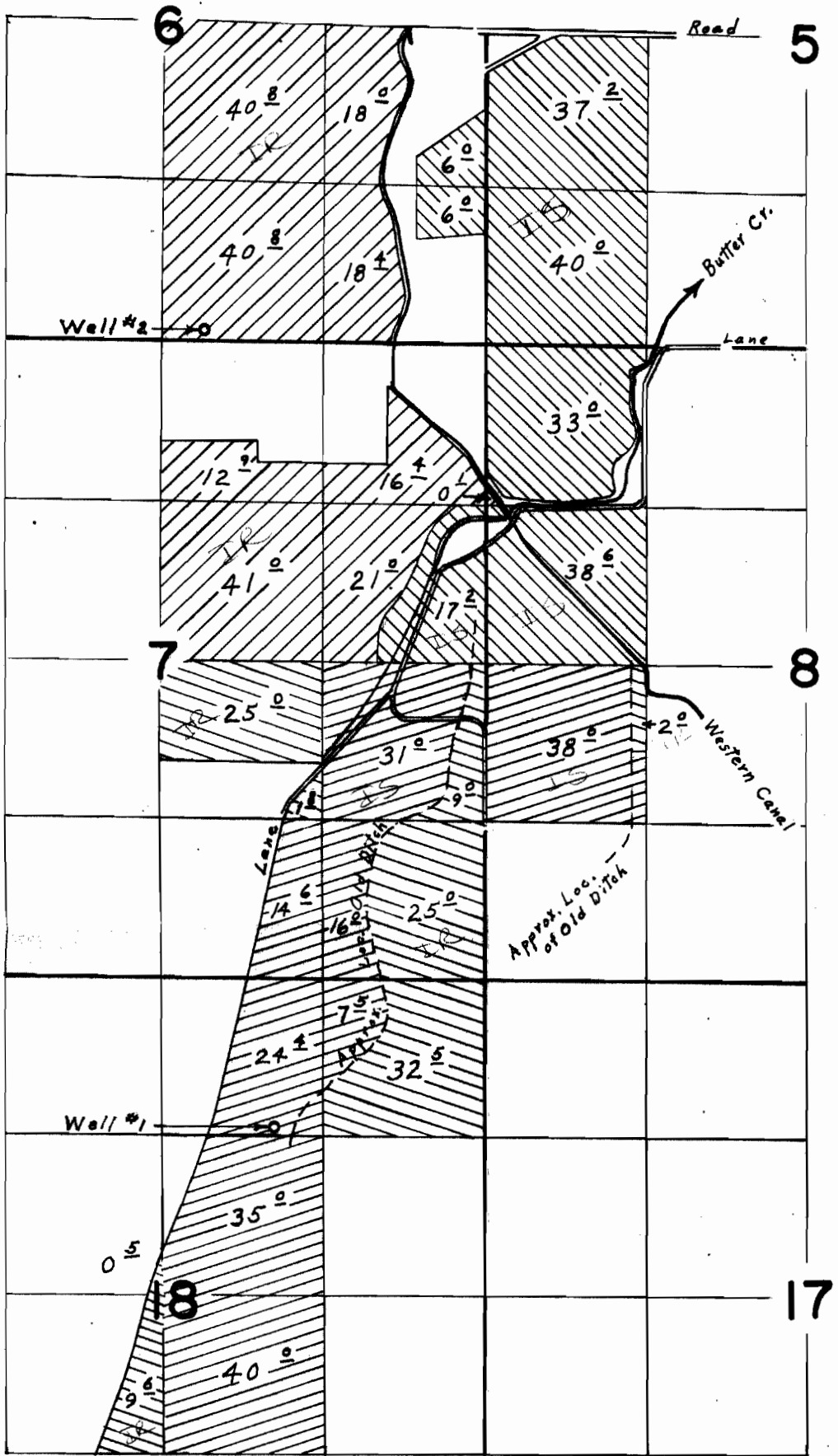

Well # 1 located 1220' S. & 1760' W. from N.E. Corner Section 18  
 Well # 2 located 80' N. & 330' E. from S. 1/4 Corner Section 6

- Well # 1 Primary
- Well # 1 Supplemental
- Well # 2 Primary
- Well # 2 Supplemental

## FINAL PROOF SURVEY

UNDER

Application No. G-3939 Permit No. G-3530

IN NAME OF

STONE MACHINERY CO.

Surveyed April 14, 1973, by L. E. Gould