

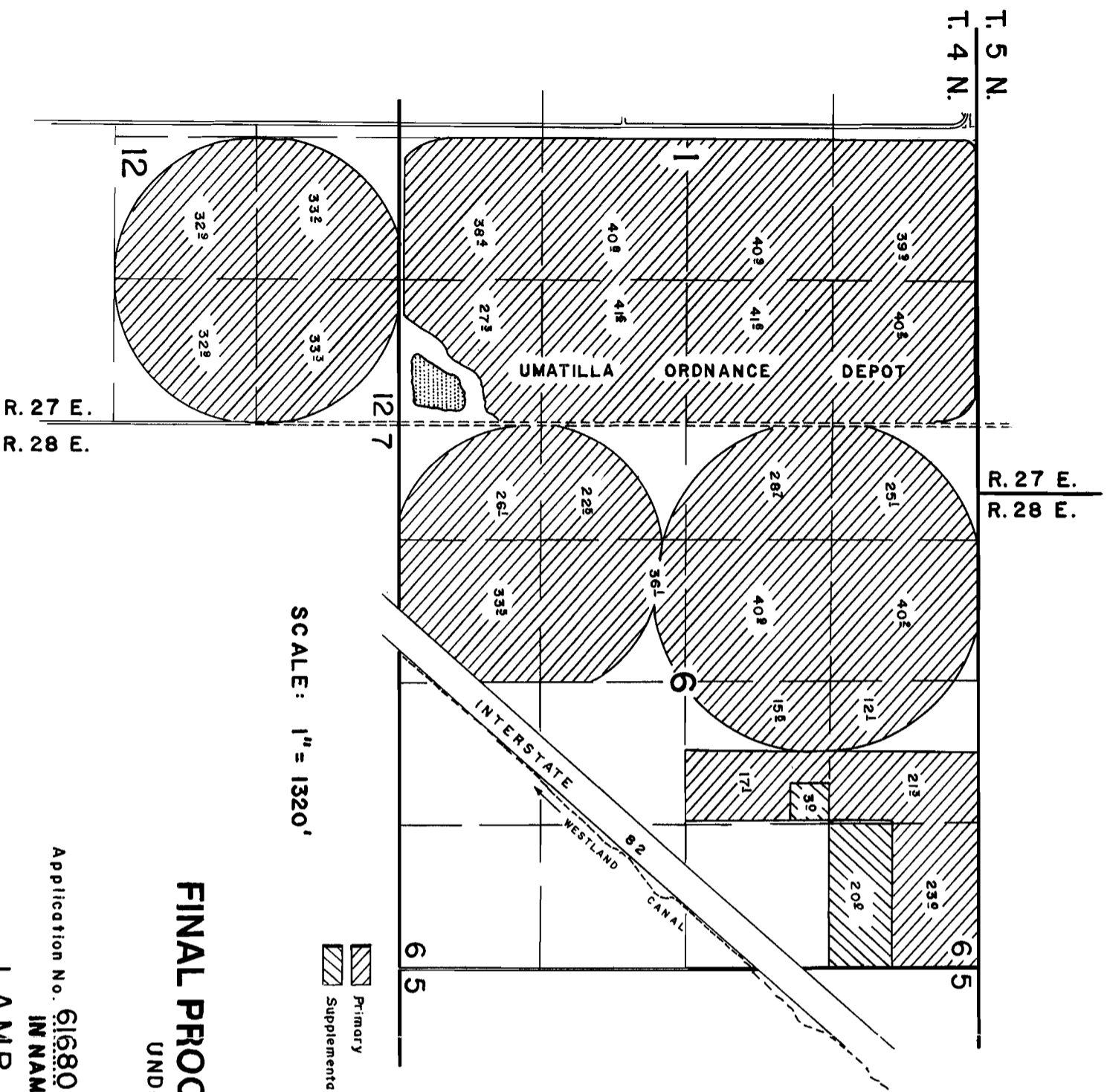

T. 4 & 5 N., R. 27 & 28 E., W.M.



SCALE: 1" = 1320'

 Primary
 Supplemental

FINAL PROOF SURVEY UNDER

Application No. 61680 Permit No. 46678
 IN NAME OF

LAMB WESTON

Surveyed Sept. 21, 1989, by V. CHURCH

T. 5 N., R. 28 E., W.M.

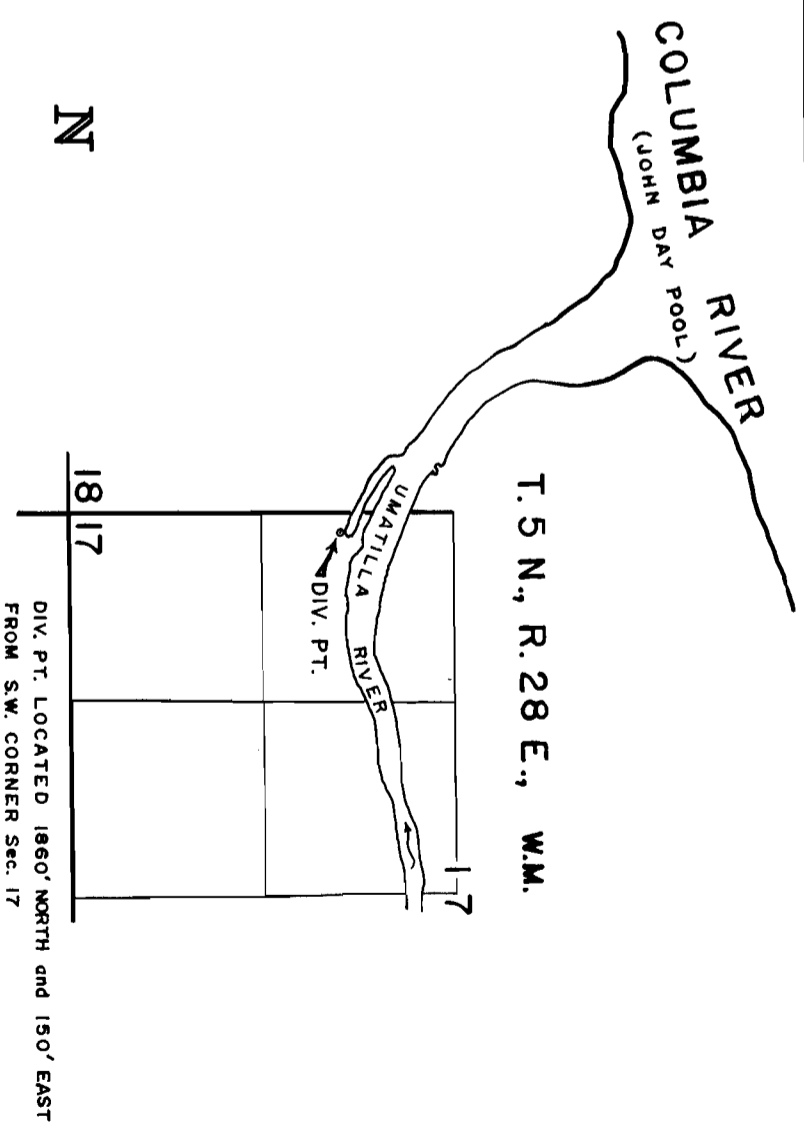

DIV. PT. LOCATED 1860' NORTH and 150' EAST FROM S.W. CORNER Sec. 17

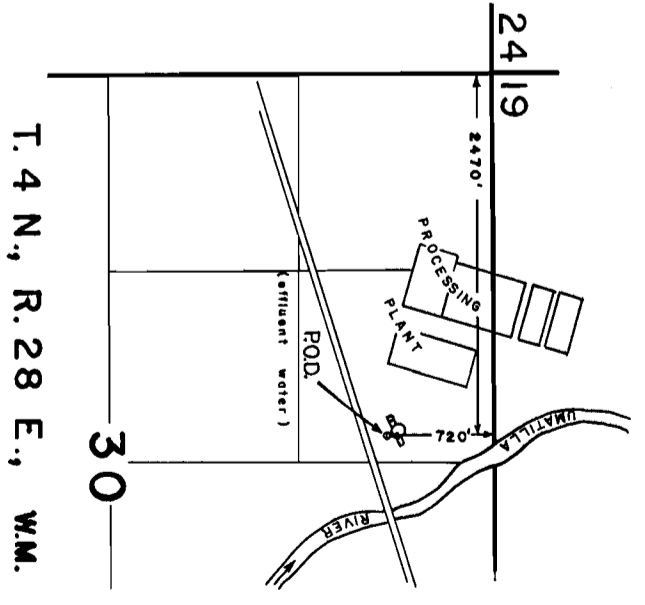

T. 4 N., R. 28 E., W.M.