

T.6S., R.2W. W.M.

RECEIVED

JUL 14 1996

WATER RESOURCES DEPT.  
SALEM, OREGON

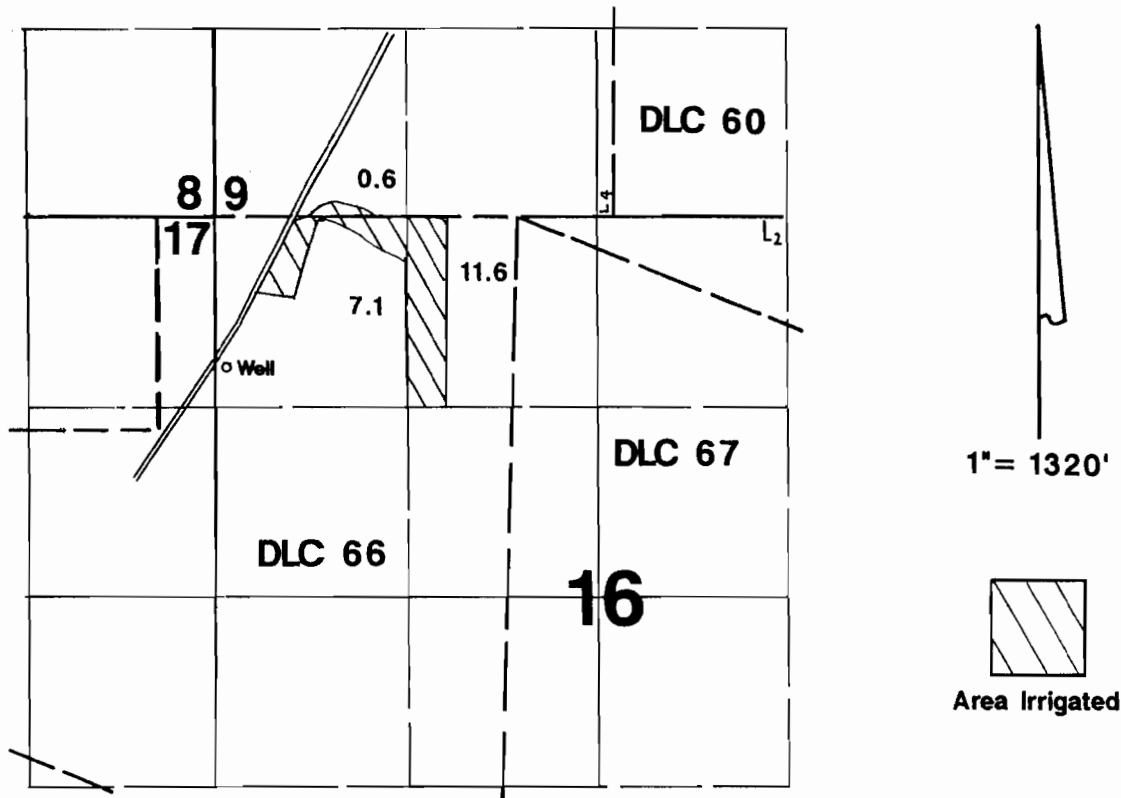

Well located 1040'S & 2000'W from NW corner DLC 67.

### Final Proof Survey

Application #: G-12890

Permit: G-12051

In Name Of

## Terry & Deborah Beilke

Surveyed on July 11, 1996 by James Grimm

James Grimm