

W1/2 SW1/4 Section 14, T.36 S.,R.6 W.,W.M.

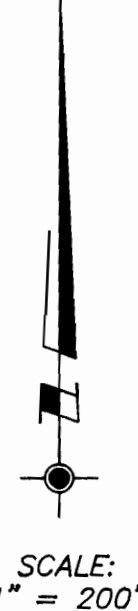
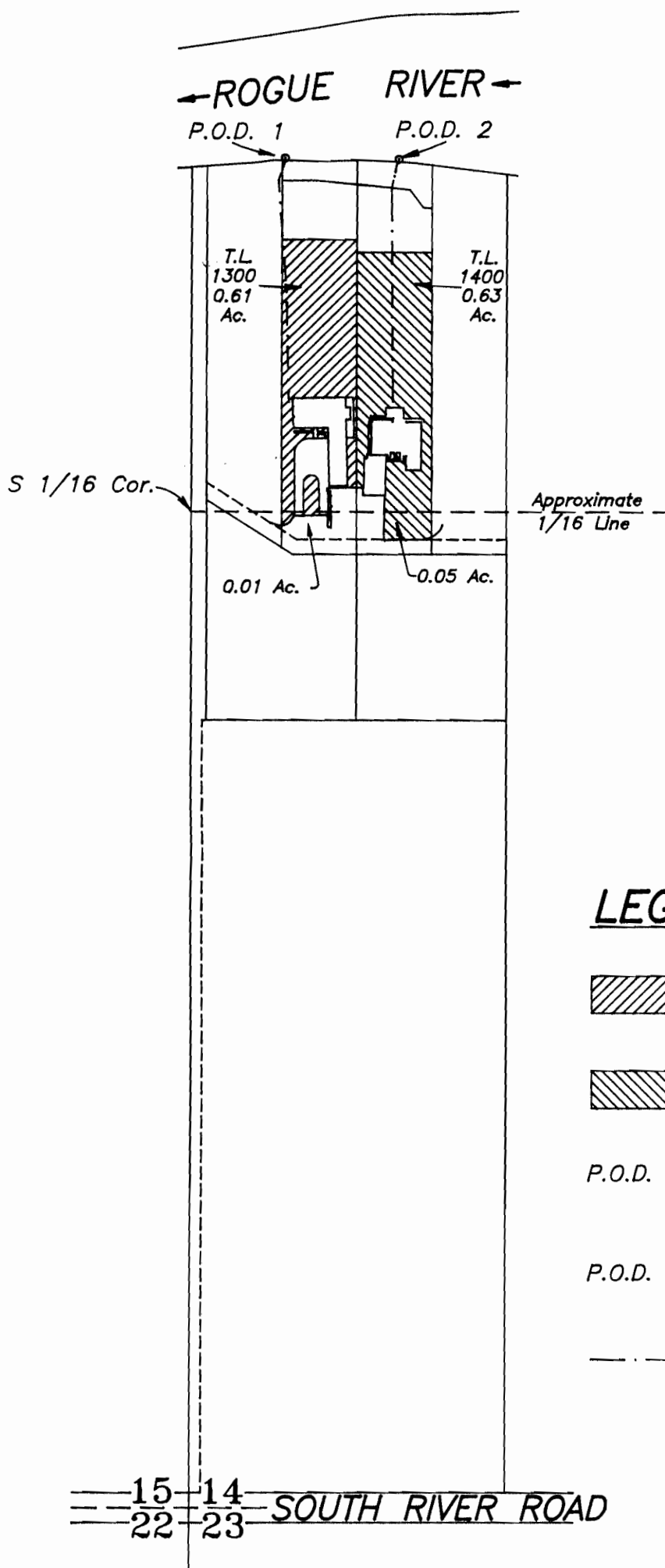

RECEIVED

SEP 2000

WATER RESOURCES DEPT.
SALEM, OREGON

LEGEND:

- Place of use for J.A. Moore Authorized by Permit No. 52313 (0.62 Acres)
Tax Lot 1300, Map No. 36-6-14
- Place of use for Richard Miller Authorized by Permit No. 52393 (0.68 Acres)
Tax Lot 1400, Map No. 36-6-14
- P.O.D. 1 Point of diversion for J.A. Moore (1810' North and 124' East of SW corner of Sec. 14)
Authorized by Transfer Order No. T-7609
- P.O.D. 2 Point of diversion for Richard Miller (1808' North and 276' East of SW corner of Sec. 14)
- 1 1/2" PVC Under Ground Pipe
(Approximate Location)

This plat was prepared for the purpose of identifying the location of the water rights only. There is no intent to provide dimensions or locations of property ownership lines.

PROJECT NO.
426-95-307

DRAWING NO.
46-11.17

DATE
12-9-97
Rev 9-13-00

SCALE
1" = 200'

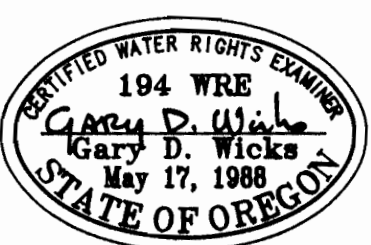

PLAT OF CLAIM OF BENEFICIAL USE

LOCATED IN
W1/2 SW1/4 Section 14, T.36 S.,R.6 W.,W.M.
Josephine County, Oregon

PREPARED FOR:

J.A. Moore 2992 S. River Rd. Grants Pass, OR 97527 Tel. (541) 474-3364	Richard Miller 2994 S. River Rd. Grants Pass, OR 97527 Tel. (541) 476-4319
---	---

PREPARED BY:
WICKS ENGINEERING & SURVEYING
311 N.E. "D" Street
Grants Pass, Oregon 97526
Tel. (541) 479-3436