

T. 1 & 2 N., R. 1 W. & 1 E., W.M.

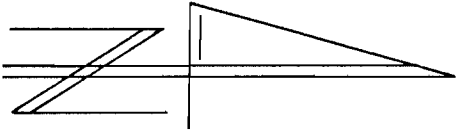

1" = 1320'

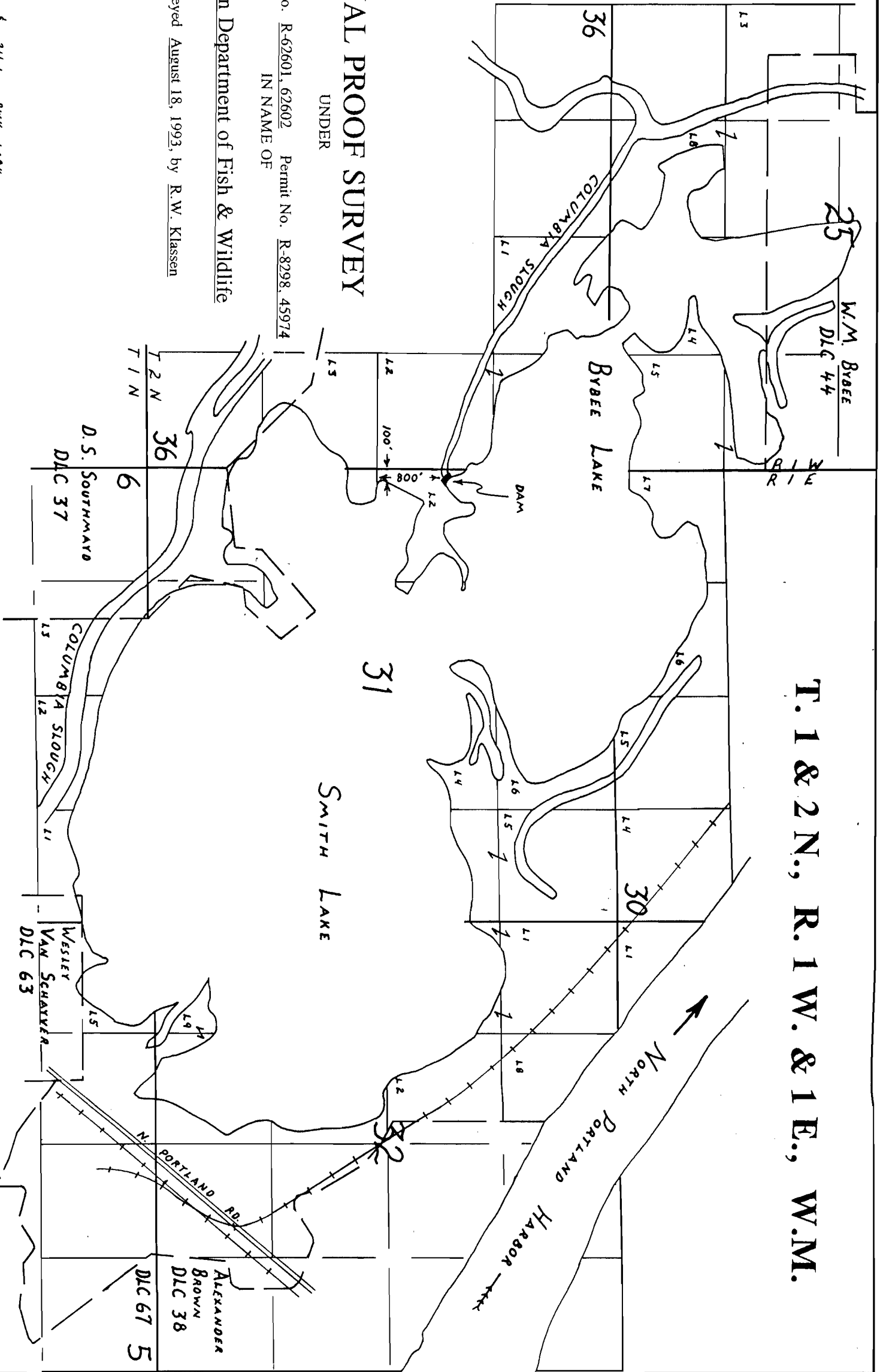

FINAL PROOF SURVEY

UNDER

Application No. R-62601, 62602 Permit No. R-8298, 45974

IN NAME OF

Oregon Department of Fish & Wildlife

Surveyed August 18, 1993, by R.W. Klassen