

10686

Sec. 8-17-18

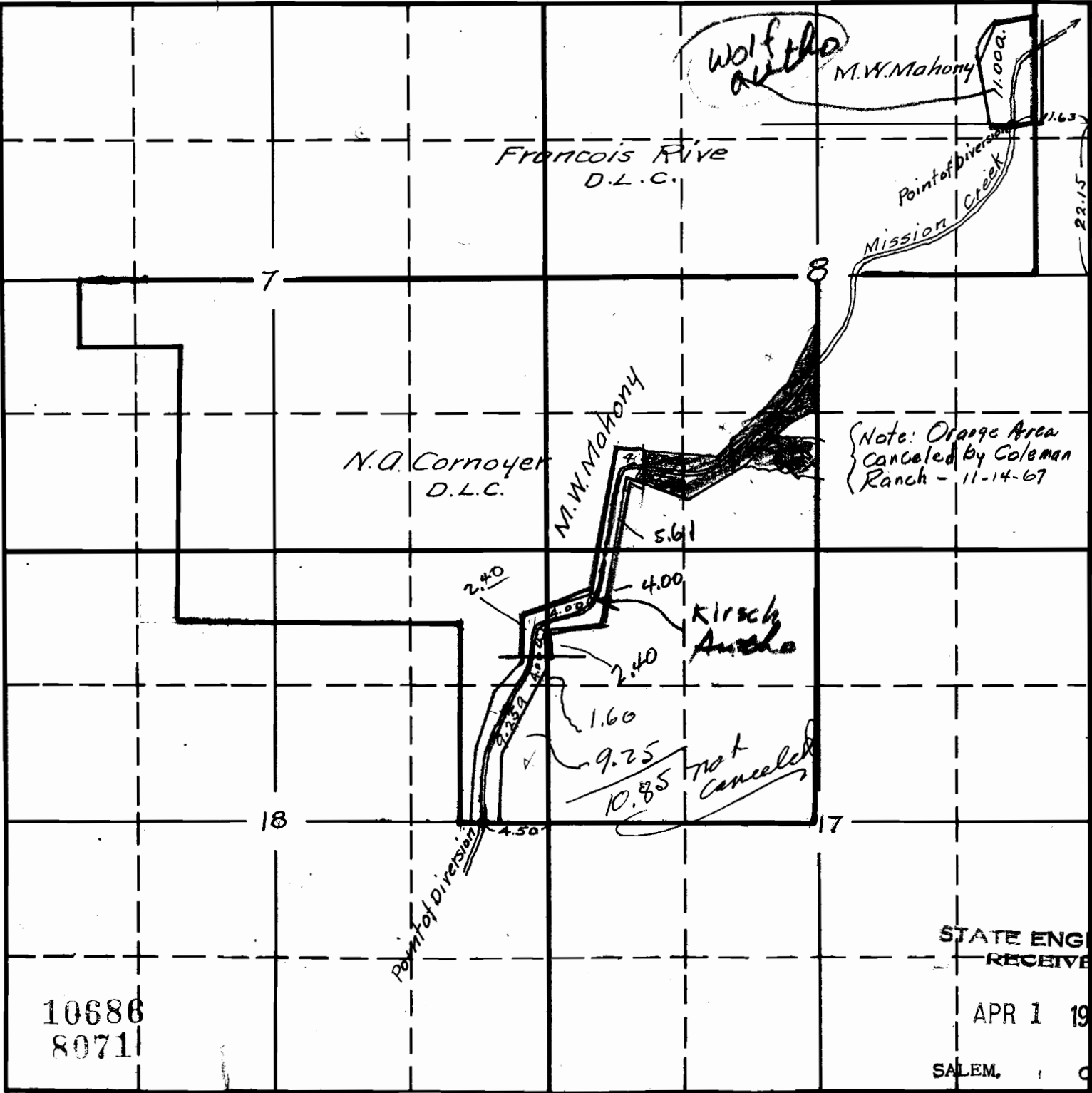

N.A. Cornoyer  
D.L.C.

Francois Rive  
D.L.C.

M.W. Mahony

Kirsch  
Ancho

Note: Orange Area  
Canceled by Coleman  
Ranch - 11-14-67

Wolf Ancho

M.W. Mahony

11.000

Point of Diversion  
Mission Creek

22.15

Tp. 5 S.

R. 2 W.

Application No.  
Permit No.

10686  
8071

STATE ENGINEER  
RECEIVED

APR 1 1926

SALEM, OREGON