

G-9018

53855
72628
T7909
76941
76942

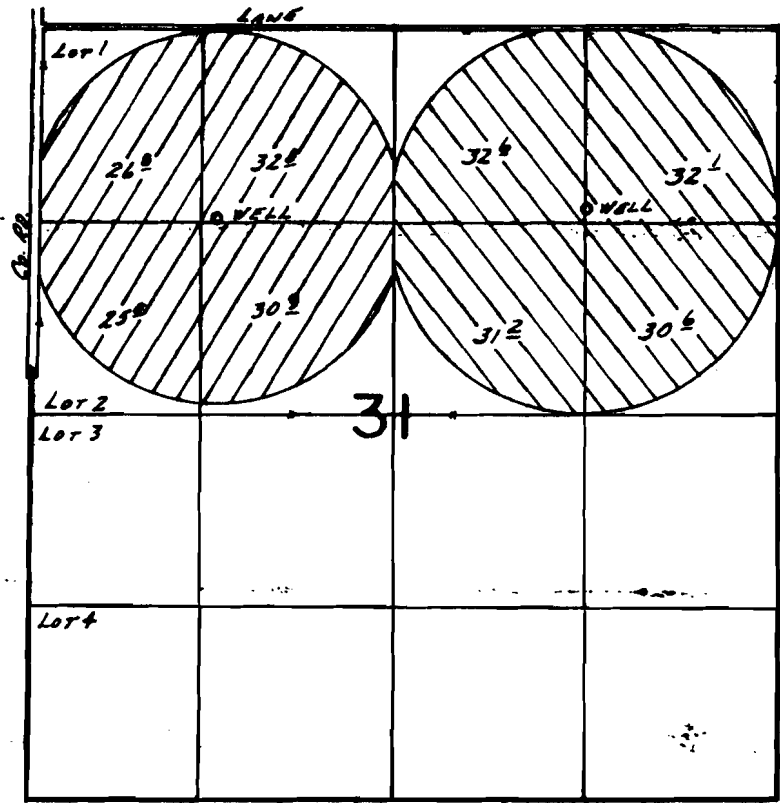

T. 26S., R. 18E., W.M.



Wells Loc.: 1350' N. & 1220' W., 1410' N. & 1320' E., BORN FROM THE C. 1/4 COR. SEC. 31.

SCALE: 1" = 1320'

FINAL PROOF SURVEY UNDER

G-9755 G-9148 
Application No. G-9758. Permit No. G-9018... 
IN NAME OF

.....MARVIN C. MORSE.....

Surveyed Oct. 24... 19.84, by J. G. OLSON.....
Oct. 10 1985 B.W. BISHOP