

FINAL PROOF SURVEY MAP

IN THE NAME OF RONALD MEINTS

SECTIONS 9 & 16, T. 22S, R. ~~6~~⁸ W., W.M.

APPLICATION 56707

PERMIT 42481

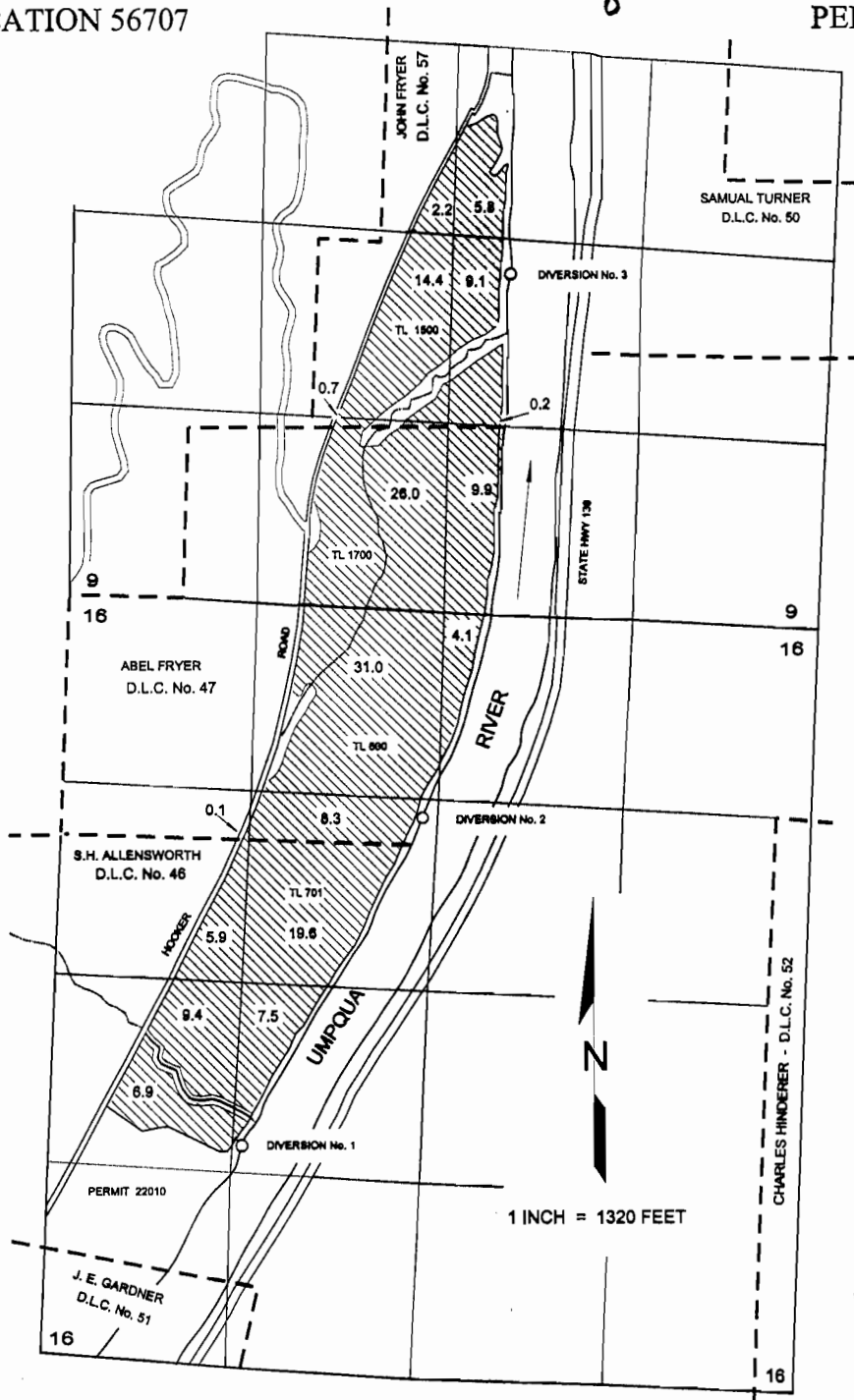

RECEIVED

JUL 1 2000

**WATER RESOURCES DEPT
SALEM OREGON**

POINT OF DIVERSION No. 1 IS 3,890 FEET SOUTH AND 1,200 FEET EAST, WITHIN THE NE¹/₄SW¹/₄ OF SECTION 16 (WITHIN DLC 46); POINT OF DIVERSION No. 2 IS 1,600 FEET SOUTH AND 2,480 FEET EAST, WITHIN THE SE¹/₄NW¹/₄ OF SECTION 16 (WITHIN DLC 47); AND POINT OF DIVERSION No. 3 IS 2,230 FEET NORTH AND 3,100 FEET EAST, WITHIN THE NW¹/₄SE¹/₄ OF SECTION 9 (WITHIN DLC 57); ALL FROM THE NORTHWEST CORNER OF SECTION 16, TOWNSHIP 22 SOUTH, RANGE 8 WEST, W.M.; DOUGLAS COUNTY.

THE PURPOSE OF THIS MAP IS TO IDENTIFY THE LOCATION OF THE WATER RIGHT. IT IS NOT INTENDED TO PROVIDE INFORMATION RELATIVE TO THE LOCATION OF PROPERTY OWNERSHIP BOUNDARY LINES.

corrected JEB