

G-7111

T.4S., R.13E., W.M.

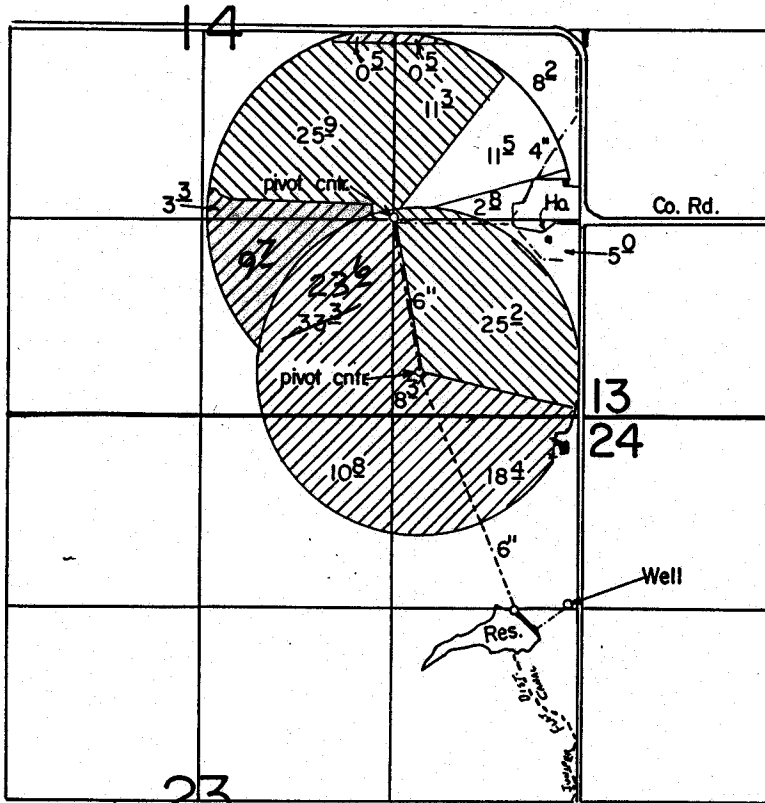

Well Loc. : 1360 N. & 80' W. from E. 1/4 Cor. Sec. 23.

-  Primary
-  Supplemental

Scale: 1" = 1320'

for Cert 76971  
(post HB 3111)

**FINAL PROOF SURVEY**  
UNDER

 Primary

Rest is  
supplemental

Application No. G-8646 Permit No. G-7958  
IN NAME OF

MARSHALL McELHERAN

Surveyed Oct. 19 1982, by T.J. Paul