

RECEIVED

JUN 18 1999

WATER RESOURCES DEPT.  
SALEM, OREGON

EXHIBIT 'A'

MAP TO ACCOMPANY APPLICATION  
FOR HYDROELECTRIC LICENSE

LYNNE MARTIN JUNE 1999

SECTION 32

TOWNSHIP 16 SOUTH RANGE 3 EAST, W. M.

4

N

1" = 200'

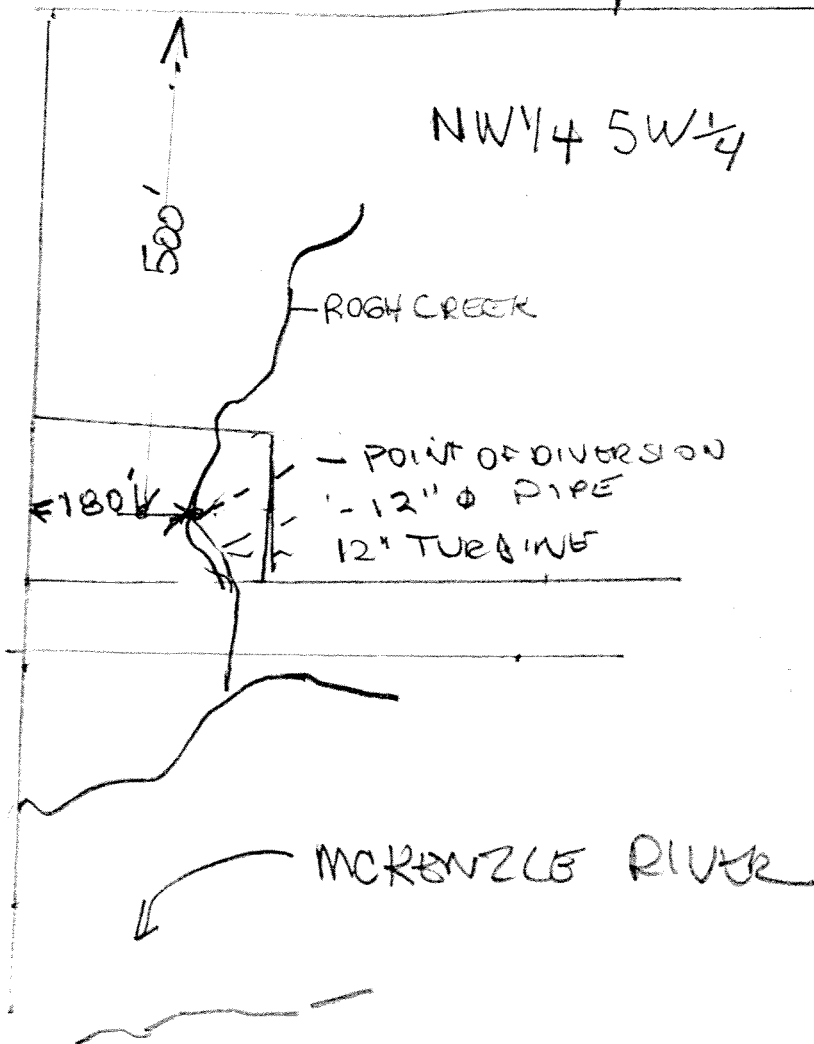

Lynn Martin