

3. NAME

TOWNSHIP 10.5, RANGE 26.E., W. M.

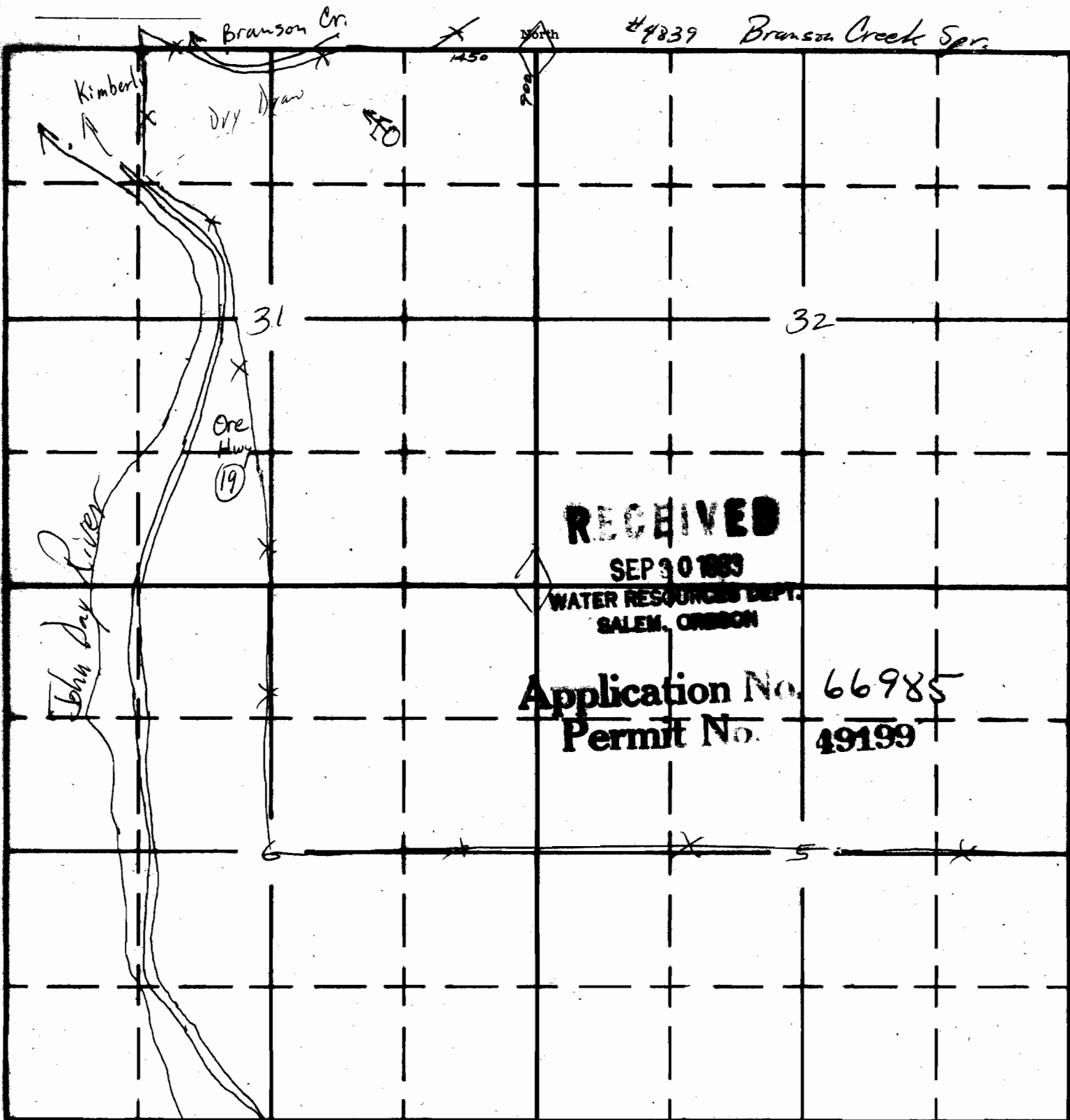

Branson Cr.

#4839 Branson Creek Spr.

North

1450

200

Kimberly

Dry Draw

TO

31

32

Ore Hwy

(19)

RECEIVED

SEP 30 1983

WATER RESOURCES DEPT.
SALEM, OREGON

Application No. 66985

Permit No. 49199

South

Dayville