

to irrigate South 65 acres of SW 1/4 SW 1/4, Lots 5 & 6, Sec. 27, T33S, R7 1/2 E., W.M.

66 46
7761

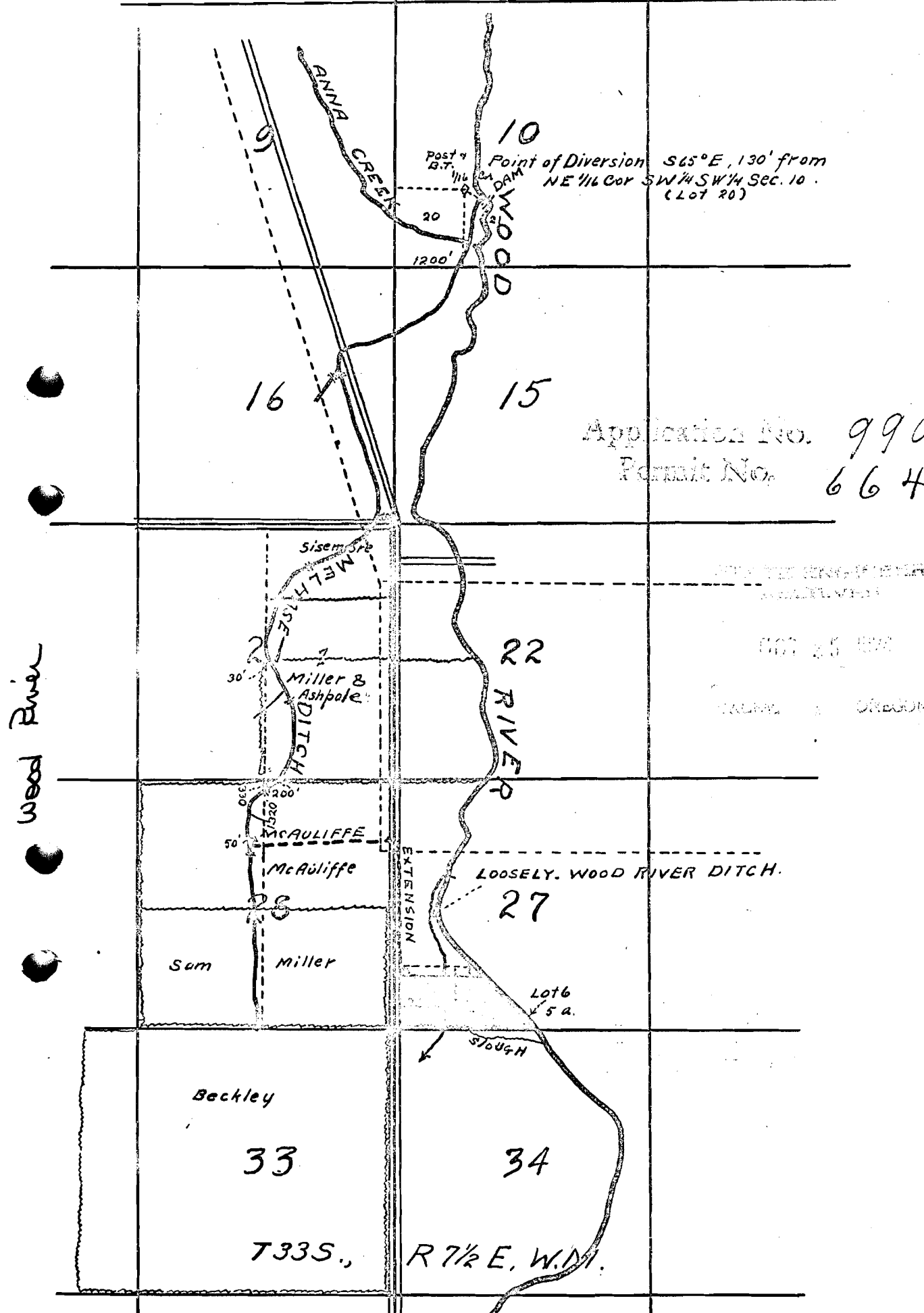

Application No. 9902
Permit No. 6646

Wood River

Beckley
33
T33S., R 7 1/2 E., W.M.

LOOSEELY. WOOD RIVER DITCH.

SCALE 2 IN. = 1 MI. DATE OCT. 23, 1924.

This is to certify that the above map was prepared from notes

65
33
7761