

HB 3111 PETITION

# JUNIPER FLAT DISTRICT IMPROVEMENT COMPANY

TOWNSHIP PLATS SHOWING  
DITCHES & LANDS FOUND IRRIGATED

Surveyed September 9-11, 1991; September 30-October 4, 1991; October 14-18, 1991; October 22-24, 1992; & May 26-27, 1993  
by  
Bruce A. Estes

SCALE 4" = 1 MILE

## LEGEND

 IRRIGATED LAND

 Ownership denoted by change in hatching

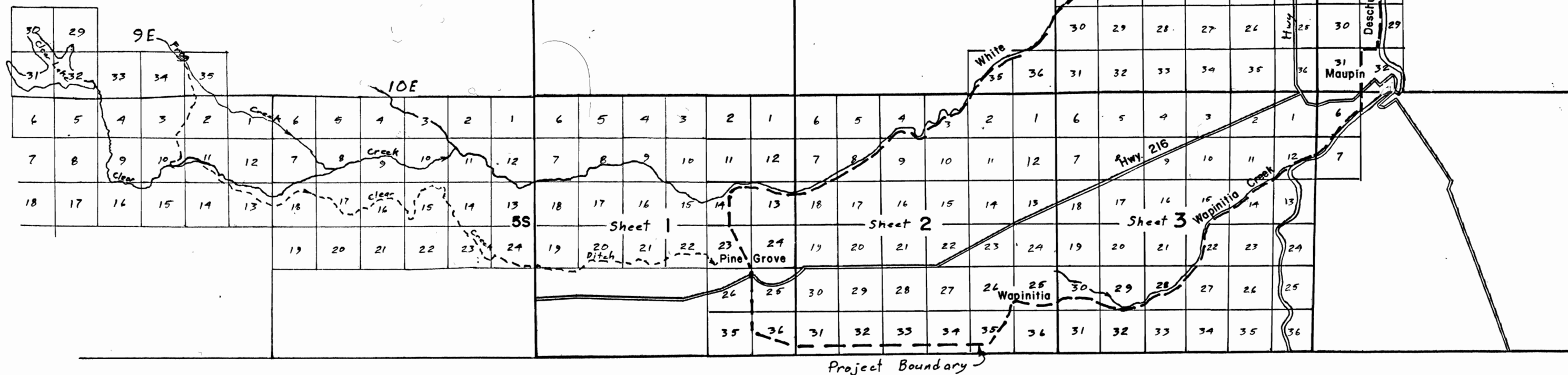
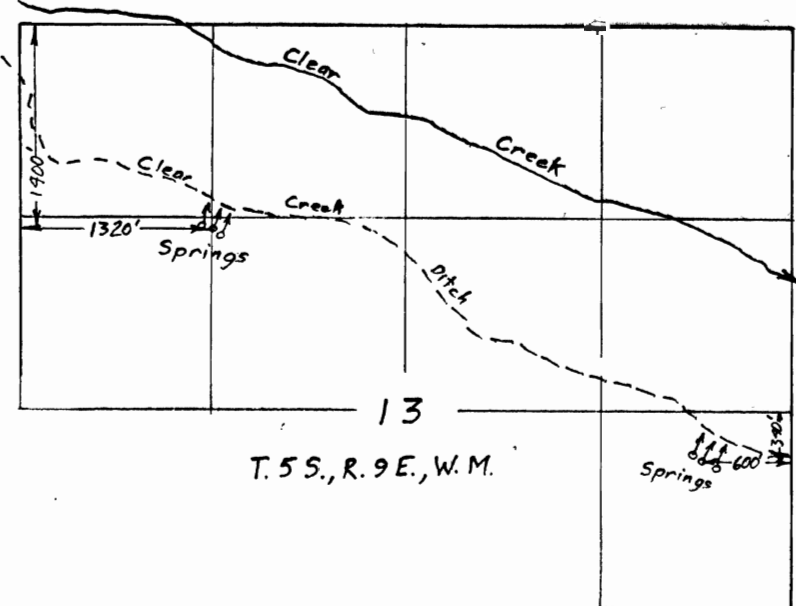
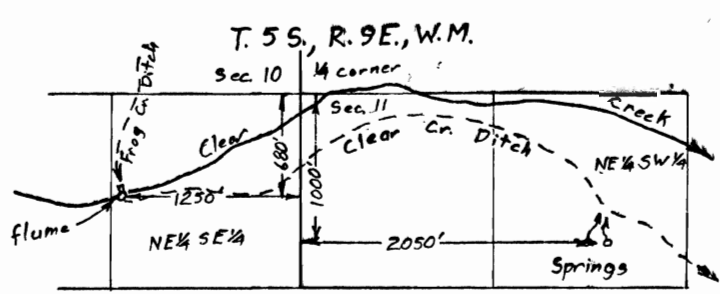
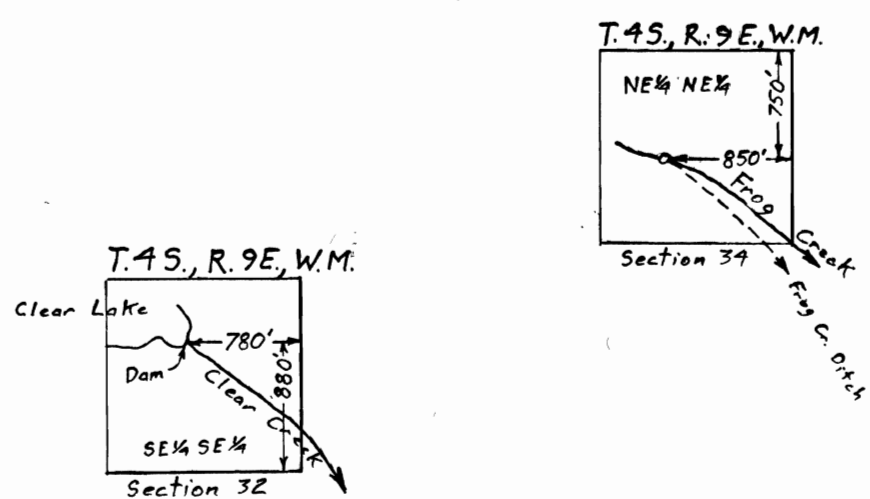

# Township 5 S., Range 11 E.

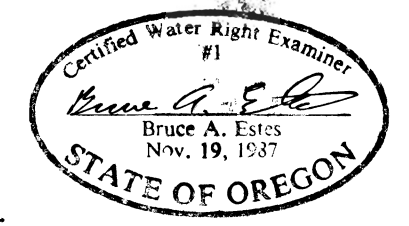
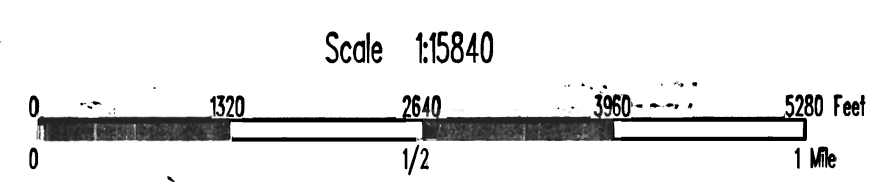
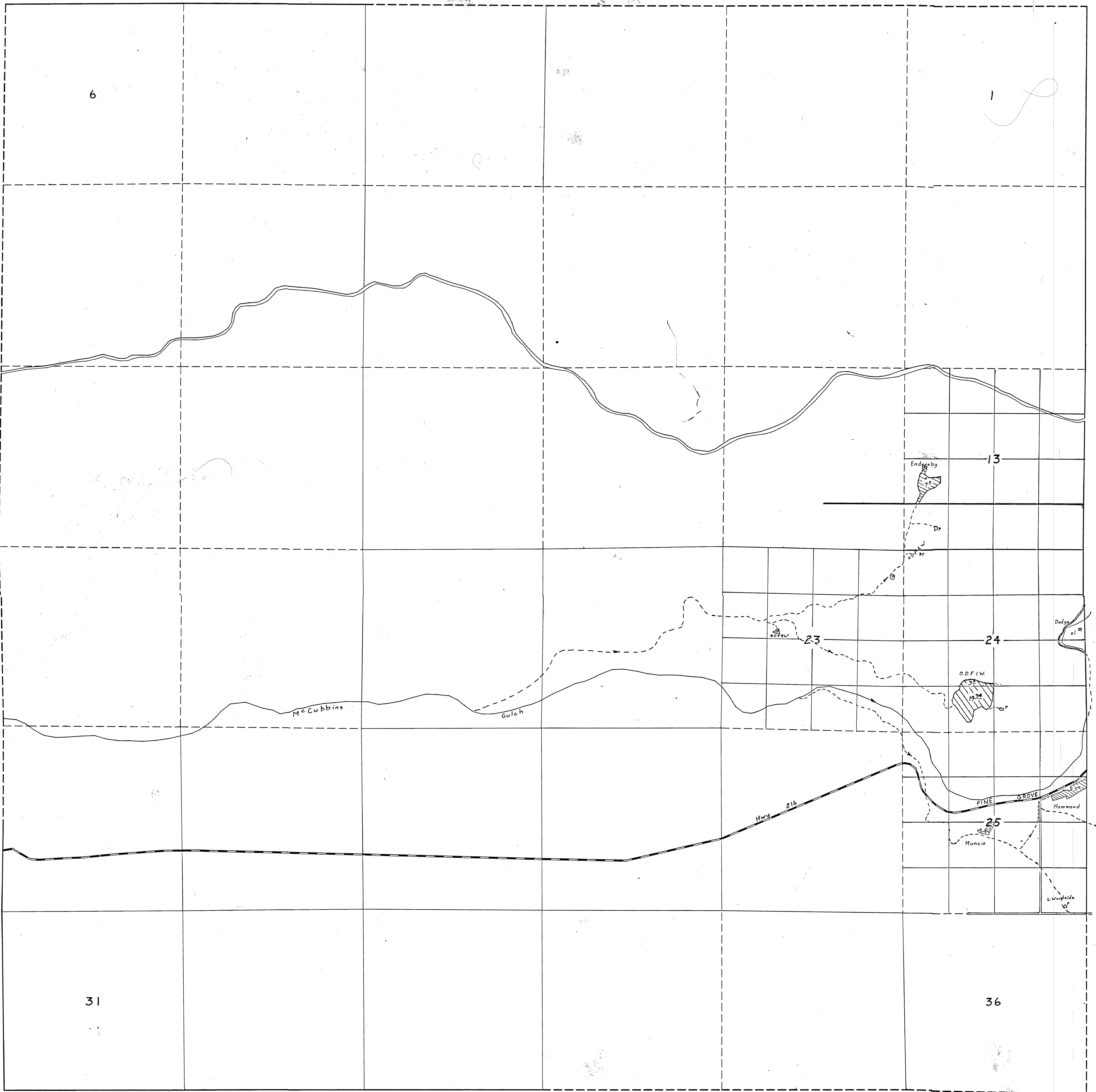

This map is for the purpose of locating a water right only and has no intent to provide the location of property lines or legal dimensions.

Rev June 34

# Township 5 S., Range 12 E.

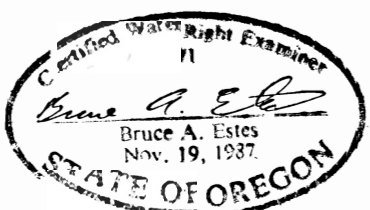
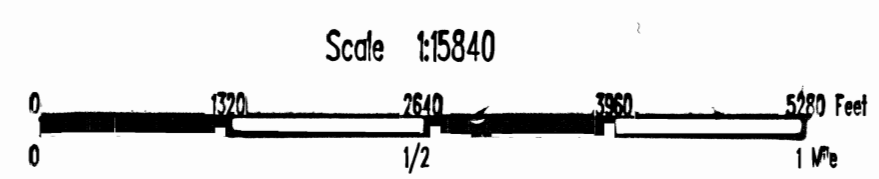
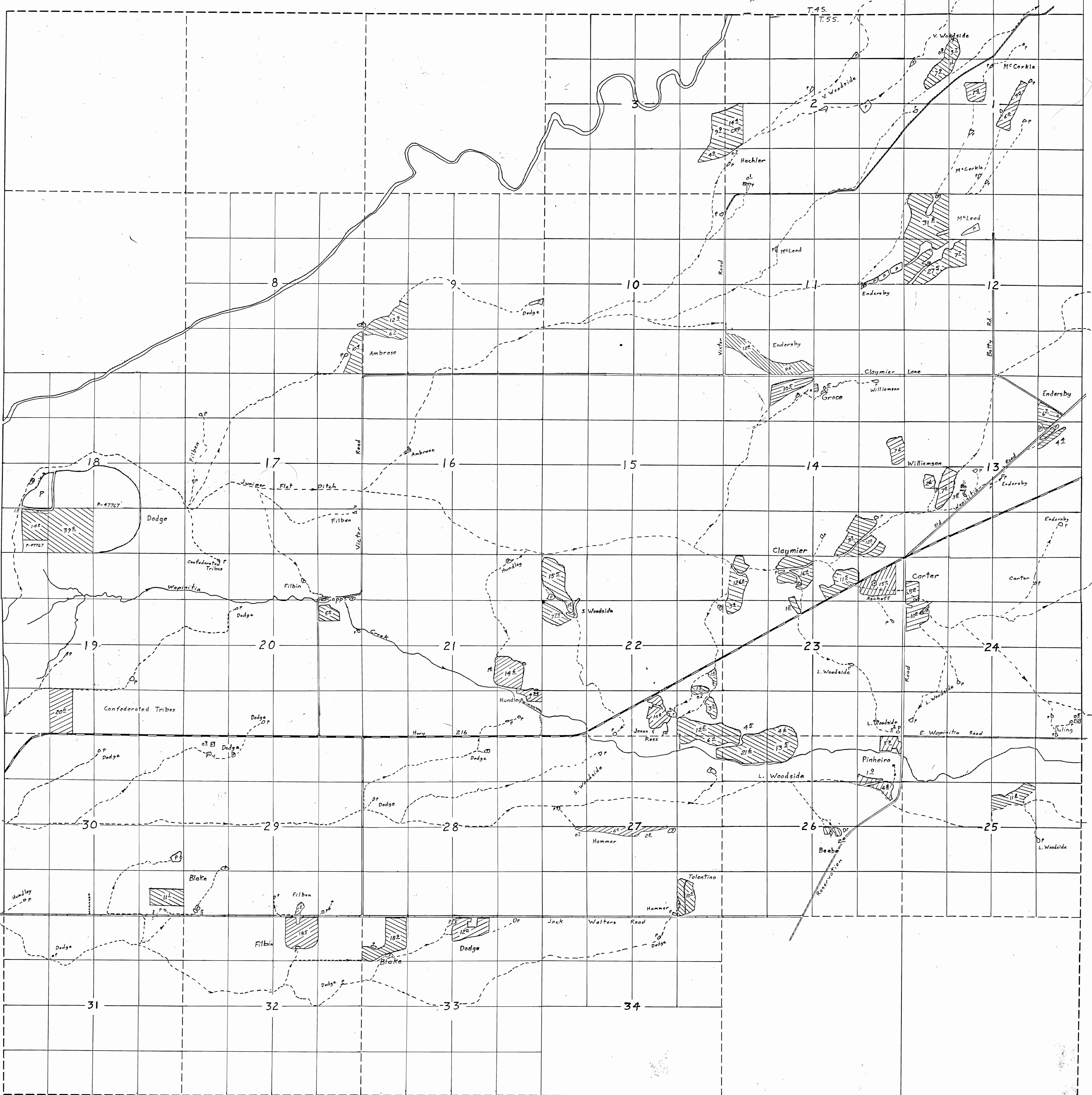

This map is for the purpose of locating a water right only and has no intent to provide the location of property lines or legal dimensions.

# Township 5 S., Range 13 E.



Scale 1:5840

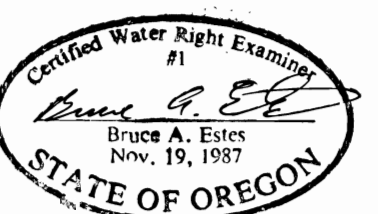
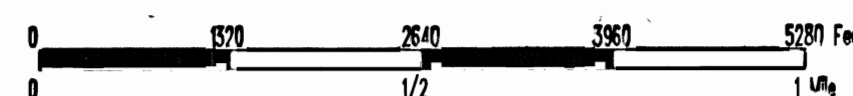

This map is for the purpose of locating a water right

# Township 4 S., Range 13 E.

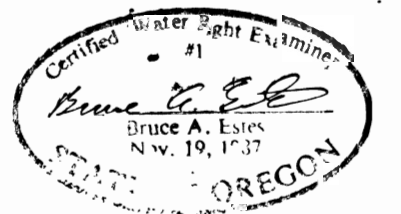
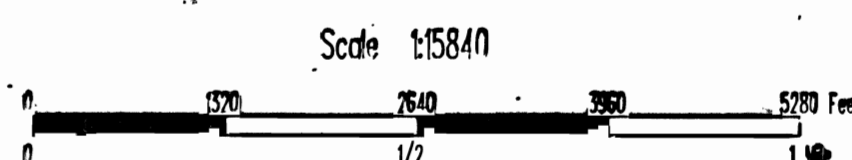
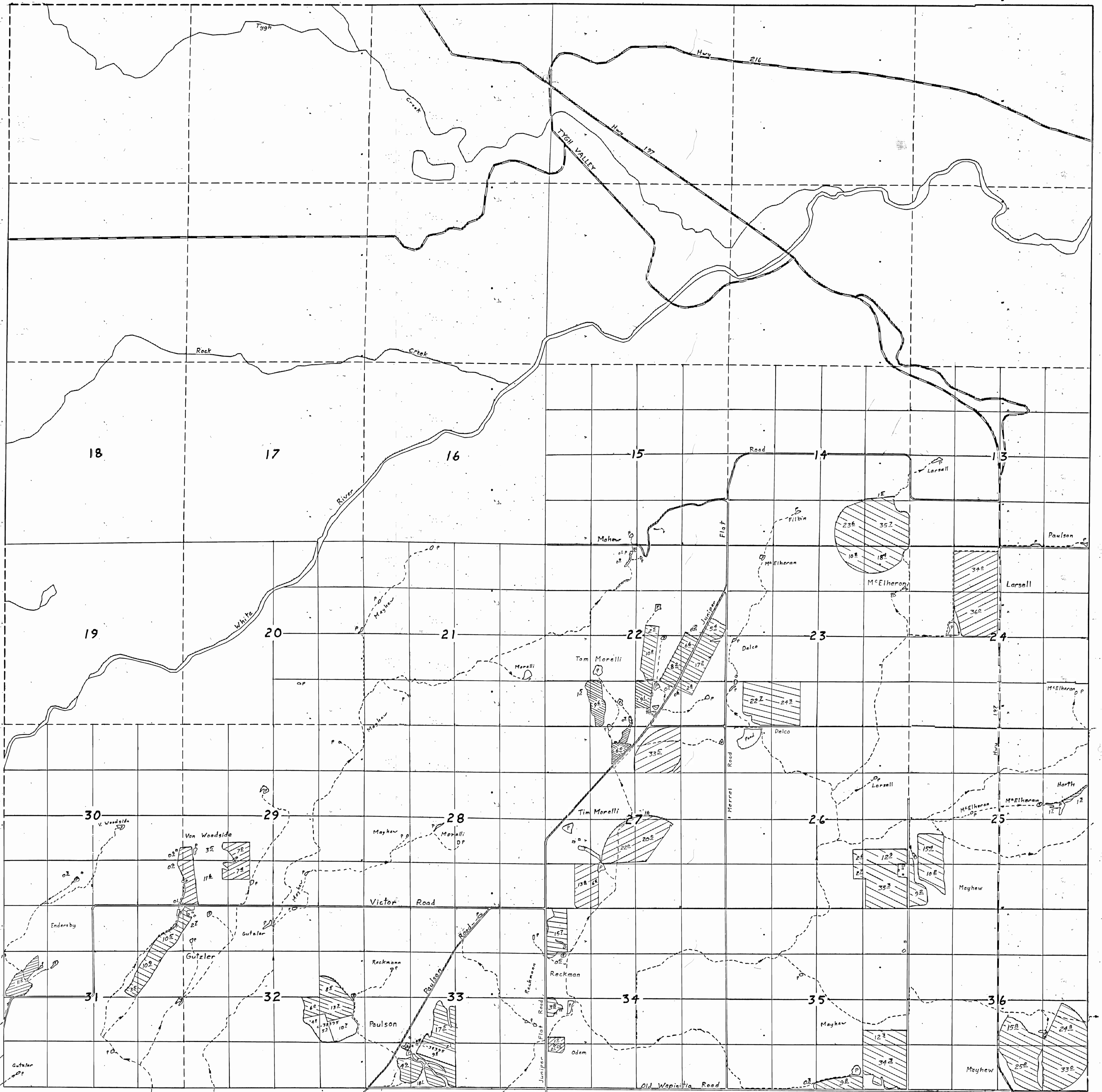

This map is for the purpose of locating a water right only and has no intent to provide the location of property lines or legal dimensions.

# Township 4 S., Range 14 E.

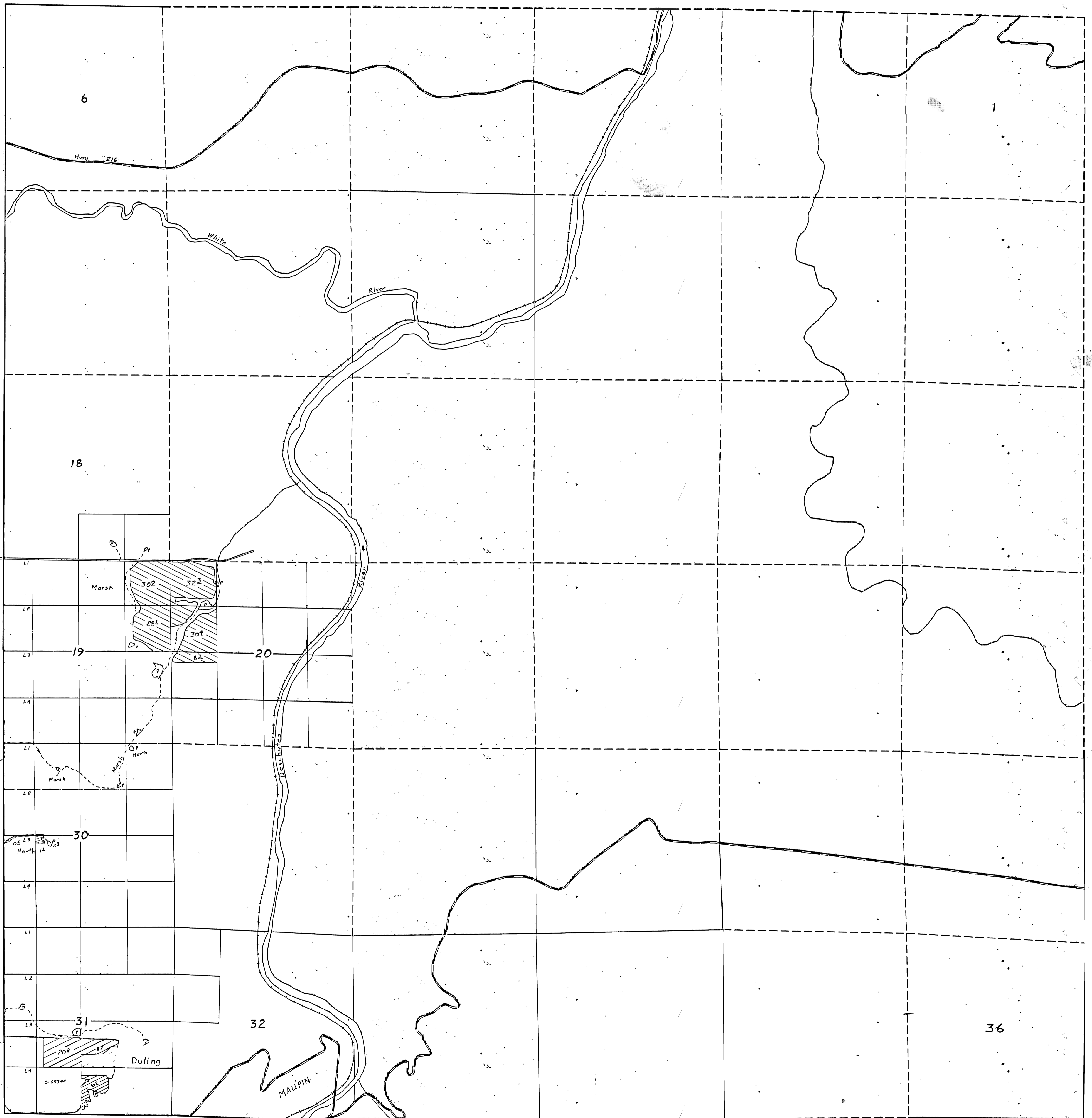

Scale 1:5840

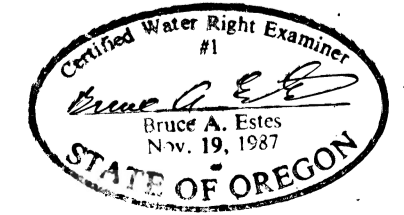
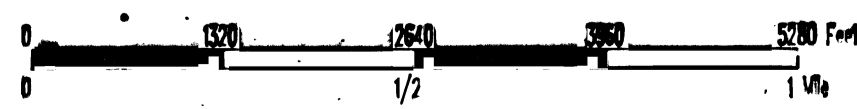

This map is for the purpose of locating a water right only and has no intent to provide the location of property lines or legal dimensions.