

Two Batteries of 3-24"x20" C.I. Culverts for overflow.

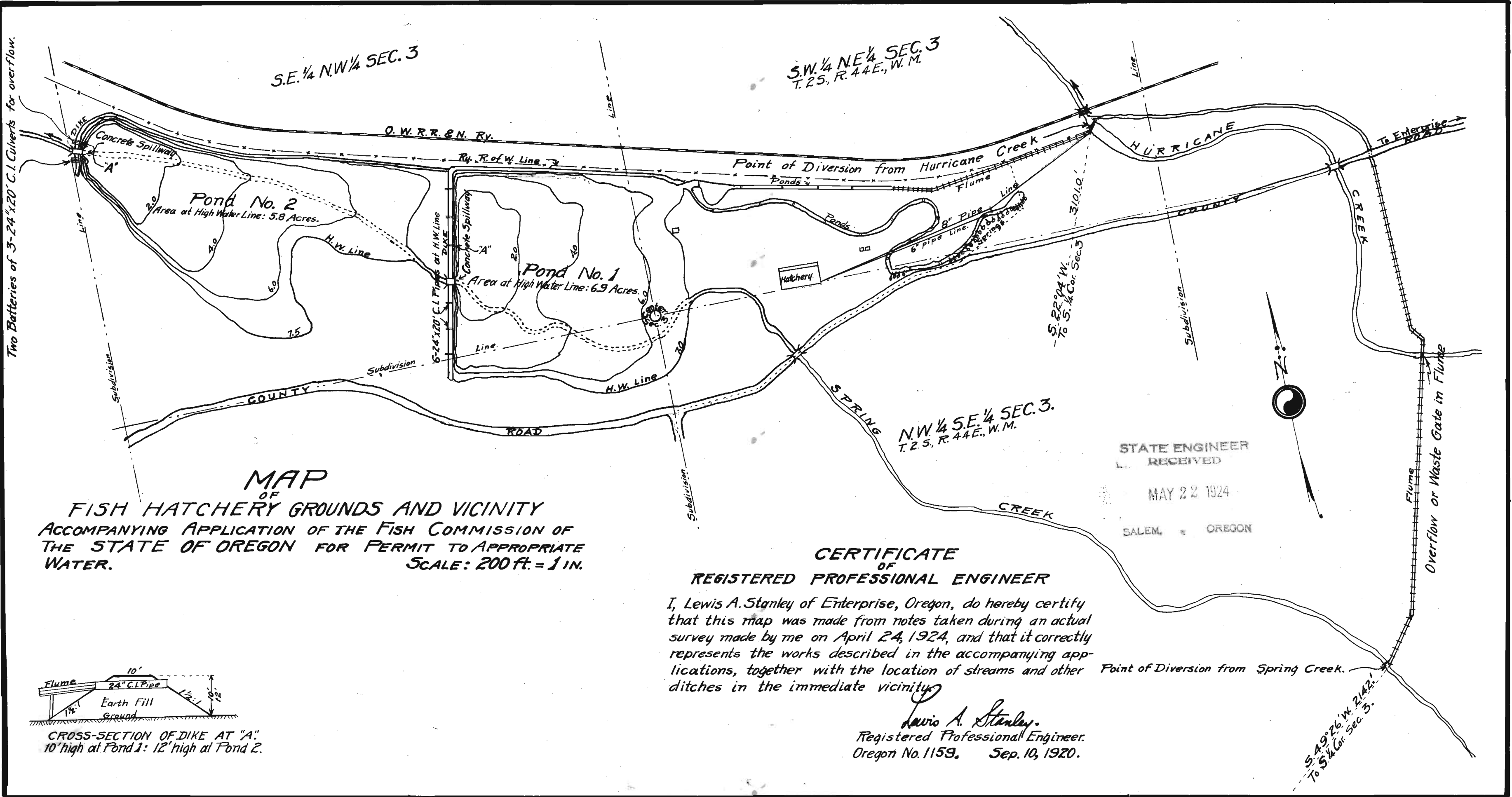

**MAP**  
 OF  
**FISH HATCHERY GROUNDS AND VICINITY**  
 ACCOMPANYING APPLICATION OF THE FISH COMMISSION OF  
 THE STATE OF OREGON FOR PERMIT TO APPROPRIATE  
 WATER.  
 SCALE: 200 ft. = 1 in.

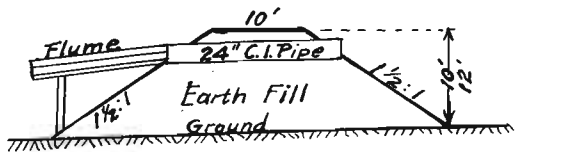

CROSS-SECTION OF DIKE AT "A".  
 10' high at Pond 1: 12' high at Pond 2.

STATE ENGINEER  
 RECEIVED  
 MAY 22 1924  
 SALEM, OREGON

**CERTIFICATE**  
 OF  
**REGISTERED PROFESSIONAL ENGINEER**

I, Lewis A. Stanley of Enterprise, Oregon, do hereby certify that this map was made from notes taken during an actual survey made by me on April 24, 1924, and that it correctly represents the works described in the accompanying applications, together with the location of streams and other ditches in the immediate vicinity.

*Lewis A. Stanley.*  
 Registered Professional Engineer.  
 Oregon No. 1159. Sep. 10, 1920.

Application No. 9534 and 9533, 9535, 9536, 9537  
 Permit No. 7817 and R591, 7819, R592, 7818