

Sprague B. Mac

T. 34S R. 9E. W. 80M

19

20

SPRAGUE

RIVER

N 46° 37' W
118.37'

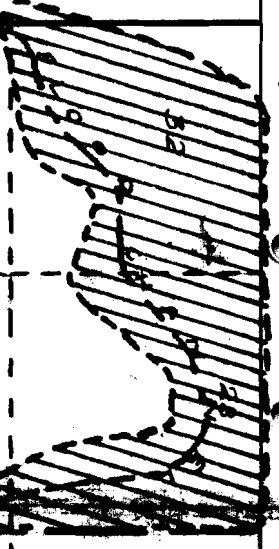
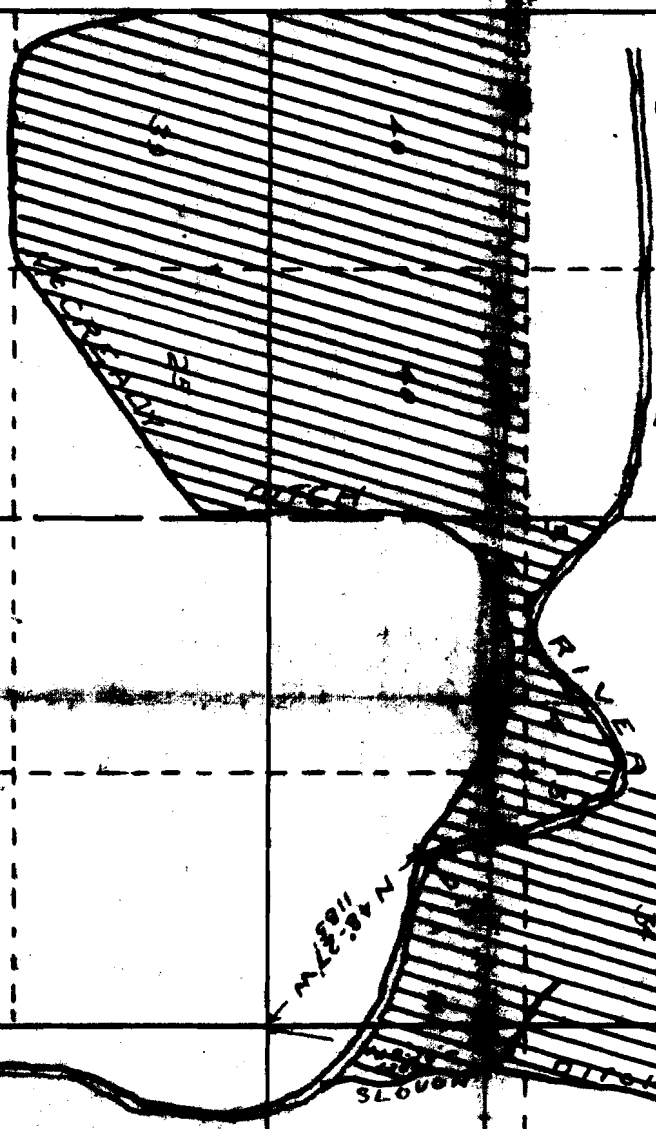

App# 2010251, 10250
R# 201011, 2012

MAP

ACCOMPANYING APPLICATION FOR

WATER RIGHT BY F.F. McCREAD

SCALE 1"=1000'

7012
7871