

— NENA —
WATER STATION

Application No. 1673
Permit No. 812

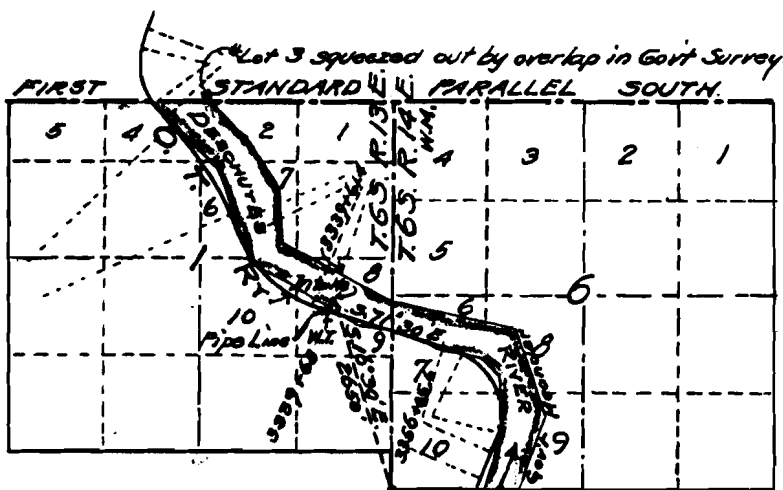

I, K. K. Kuney of Fallbridge, Washington, do hereby certify that this map was made from notes taken during an actual survey made under my immediate supervision on the 14th day of April 1911, and that it correctly represents the works described in the accompanying application together with the location of streams in the immediate vicinity.

K. K. Kuney
Surveyor.

OREGON TRUNK RY.

MAP ACCOMPANYING APPLICATION FOR PERMIT TO
APPROPRIATE WATER FROM DESCHUTES RIVER IN
SEC. 1, T. 6 S. R. 13 E. W. M.

Office of Chief Engineer

Scale: 2 in. = 1 mi.

July 24th 1911.