

Two Batteries of 3-24"x20" C.I. Culverts for overflow.

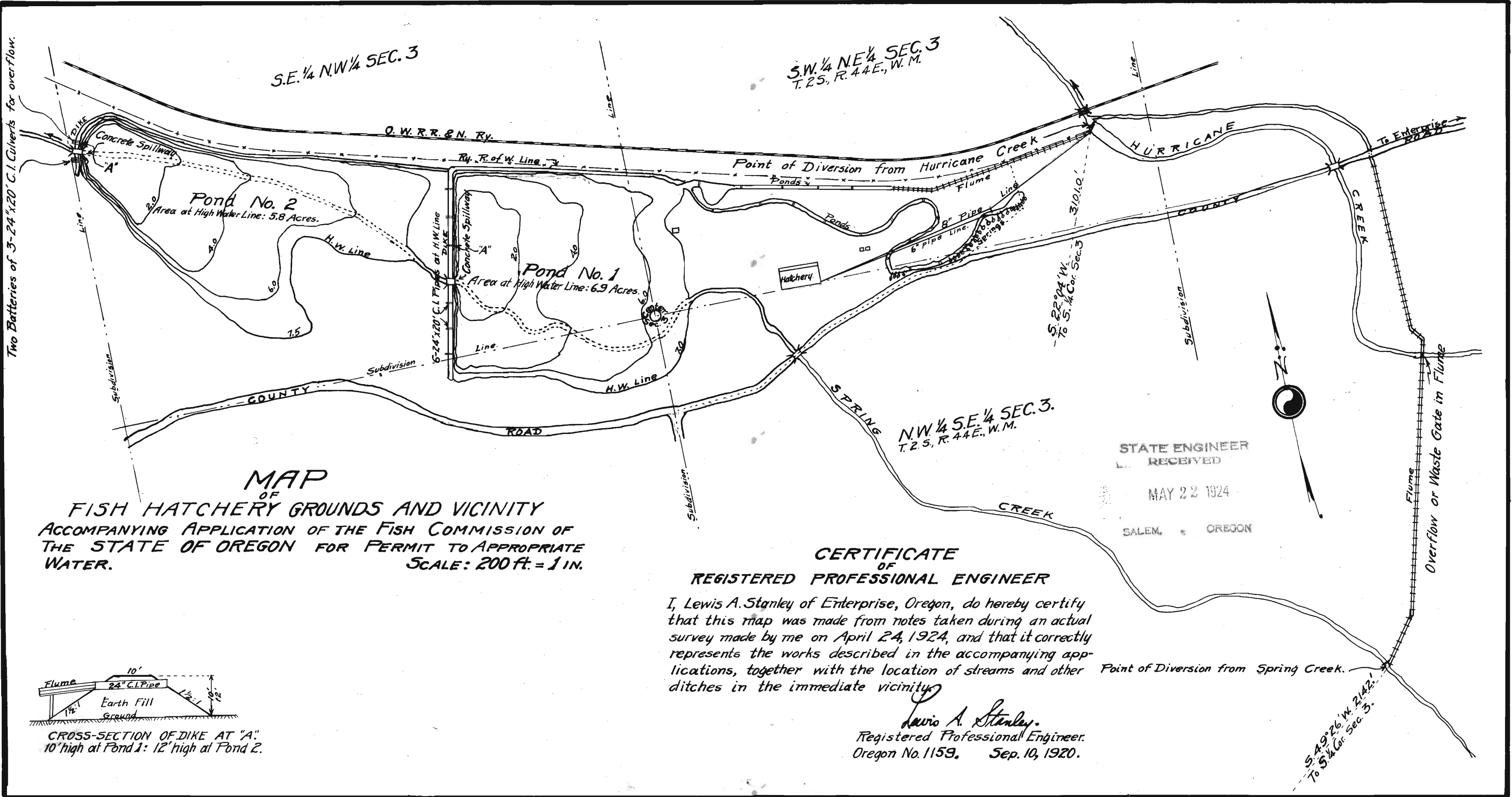

MAP
OF
FISH HATCHERY GROUNDS AND VICINITY
ACCOMPANYING APPLICATION OF THE FISH COMMISSION OF
THE STATE OF OREGON FOR PERMIT TO APPROPRIATE
WATER.
SCALE: 200 ft. = 1 in.

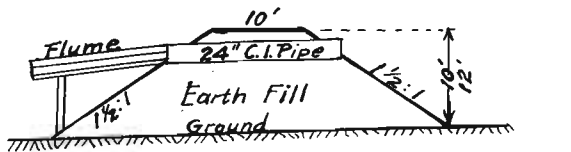

CROSS-SECTION OF DIKE AT "A".
10' high at Pond 1: 12' high at Pond 2.

CERTIFICATE
OF
REGISTERED PROFESSIONAL ENGINEER

I, Lewis A. Stanley of Enterprise, Oregon, do hereby certify that this map was made from notes taken during an actual survey made by me on April 24, 1924, and that it correctly represents the works described in the accompanying applications, together with the location of streams and other ditches in the immediate vicinity.

Lewis A. Stanley.
Registered Professional Engineer.
Oregon No. 1159. Sep. 10, 1920.

STATE ENGINEER
RECEIVED
MAY 22 1924
SALEM, OREGON

Application No. 9534 and 9533, 9535, 9536, 9537
Permit No. 7817 and R591, 7819, R592, 7818

