

RECEIVED

AUG 6 - 1979

WATER RESOURCES DEPT
SALEM, OREGON

SECTION 0

NW 1/4 SE 1/4

TOWNSHIP 26^S RANGE 40^E W.M.

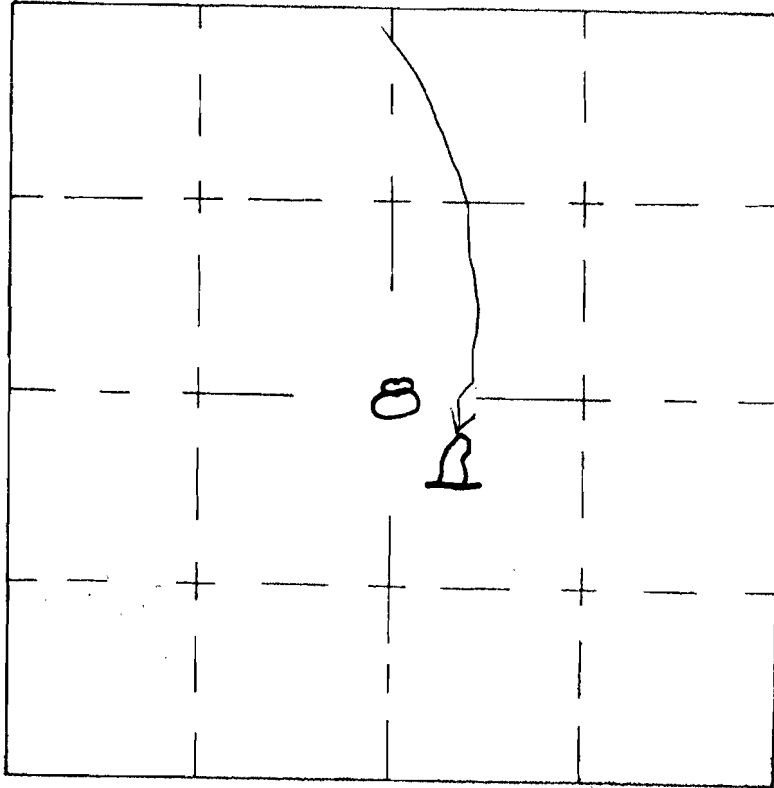

Application No. R59046

Permit No. R 8693

U. S. DEPARTMENT OF THE INTERIOR
BUREAU OF LAND MANAGEMENT

TIFFIN #1

DESIGNED _____	RECOMM. _____
DRAWN _____	RECOMM. _____
CHECKED _____	APPROVED _____

CHIEF, DIV. OF ENG.





SCALE _____	
DATE _____	SHEET _____ OF _____
DRAWING NO. _____	

APPLICATION MAP FOR PERMIT TO CONSTRUCT A RESERVOIR

SE1/4 NW1/4 SEC 8 T 26S R 40E W.M.

U.S.G.S. QUAD - BURNT FLAT, OREG. - 7 1/2'

LEGEND

-  RESERVOIR
-  ROAD
-  CHANNEL
-  FD SEC COR

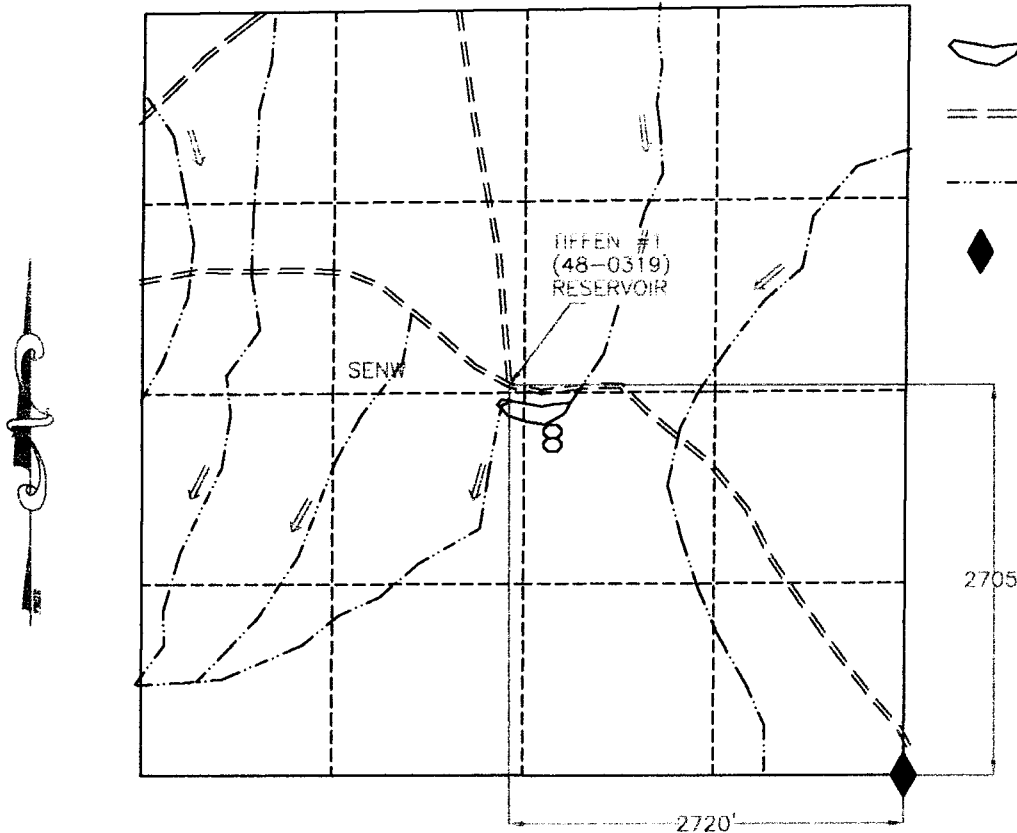

TIFFEN #1 (48-0319) RESERVOIR

RECEIVED

MAR 07 2002

WATER RESOURCES DEPT.
SALEM, OREGON

TIFFEN #1 (48-0319)
RESERVOIR PROJECT MON.:
LAT 43°19'40.61977"
LONG 117°50'43.47868"
U.S. 1927 NADCON

1320 660 0 1320

SCALE 1"=1320'

THIS MAP IS FOR THE PURPOSE OF LOCATING
A WATER RIGHT AND IS NOT INTENDED TO
PROVIDE LEGAL DIMENSIONS FOR LOCATION
OF PROPERTY BOUNDARIES.



UNITED STATES DEPARTMENT OF THE INTERIOR
BUREAU OF LAND MANAGEMENT
DIVISION OF OPERATIONS VALE DISTRICT

TIFFEN #1 (48-0319) RESERVOIR

DESIGNED _____

REVIEWED _____

APPROVED _____

CHIEF, BRANCH OF ENGINEERING

DRAWN: CG

SCALE: 1"=1320'

DATE: 10/31/00

SHEET 1 OF 1

ACAD14
DWG FILE: TIFFEN.DWG

DRAWING NO. OR-03-9172.45-1069