

FOOTHILLS IRRIGATION PROJECT

JACKSON CO.

OREGON

From the Office of  
Osgood and Cummings  
Civil Engineers,  
Medford, Oregon.

R-214  
79213

Kinn Creek (1)

T 39 S.  
16 15  
21 22  
R 3 E.

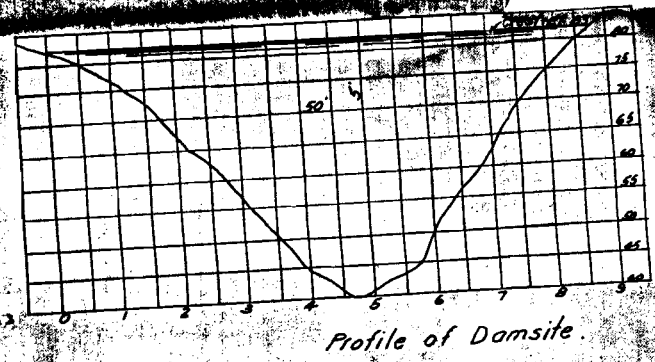

Profile of Dam site.

OFFICE OF STATE ENGINEER  
RECEIVED  
AUG 14 1912  
MEDFORD, OREG.

Application No. 2327  
Reservoir Permit No. 214

OK

5357

OFFICE OF STATE ENGINEER  
RECEIVED  
AUG 14 1912

2327

2327

5359

5359

5359

2327

2327

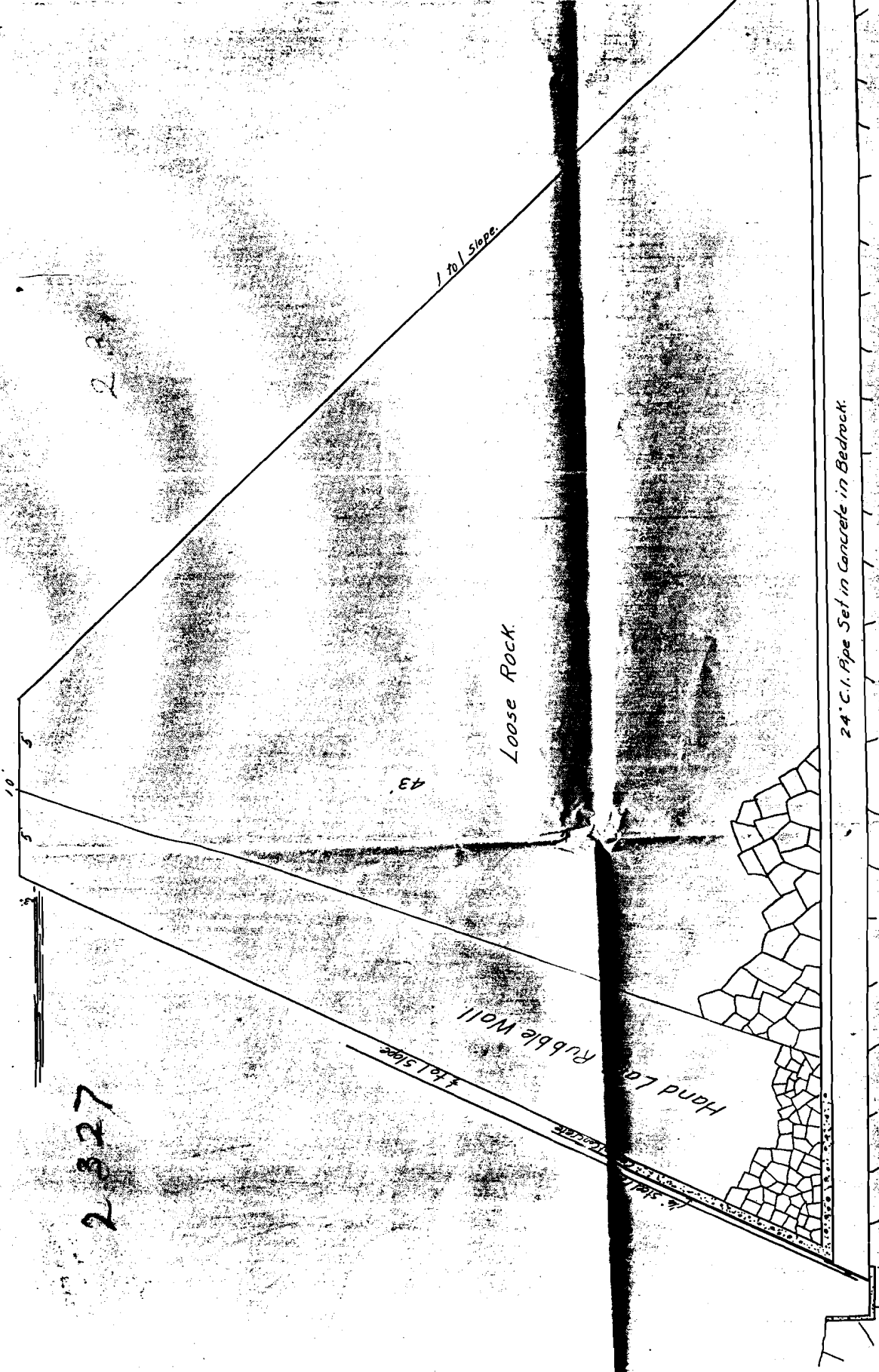

43

1 to 1 slope.

Loose Rock.

Rubble Wall

Hand Laid

24" C.I. Pipe Set in Concrete in Bedrock.

Scale: 1/10" = 10ft

Maximum Section of Dam

R-219

Map of Dam Site  
Scale - 1 in = 200 ft.

2327

5355

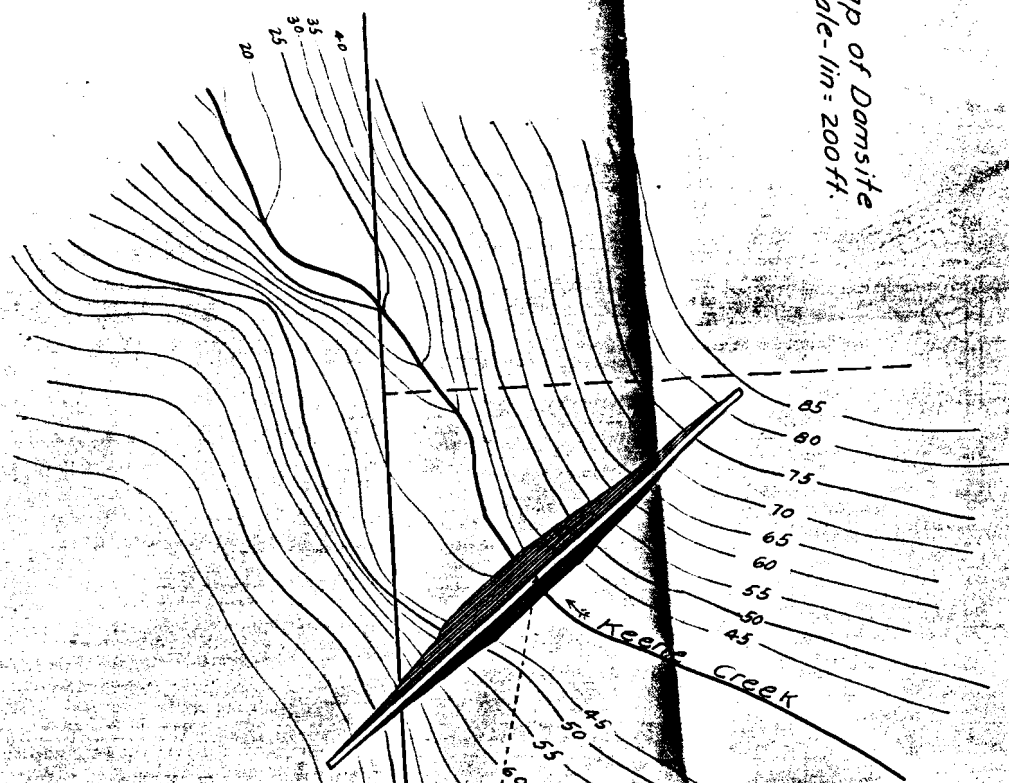

N 29° 35' W 1030  
 T 39 S  
 R 3 E  
 21 22  
 16 15

2327

5355

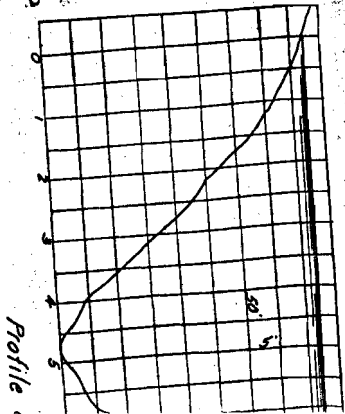

5355