

RECEIVED

SEP 18 1999

WATER RESOURCES DEPT  
SALEM, OREGON

CLAIM OF BENEFICIAL USE

APPLICATION NO. 74001 PERMIT NO. 52929

SURVEYED SEPTEMBER 8, 1999 BY DUANE W. KIRBY

FOR ROBERT J. LANE

SECTION 10, T 23 S, R 5 W, W M

SE 1/4 SW 1/4

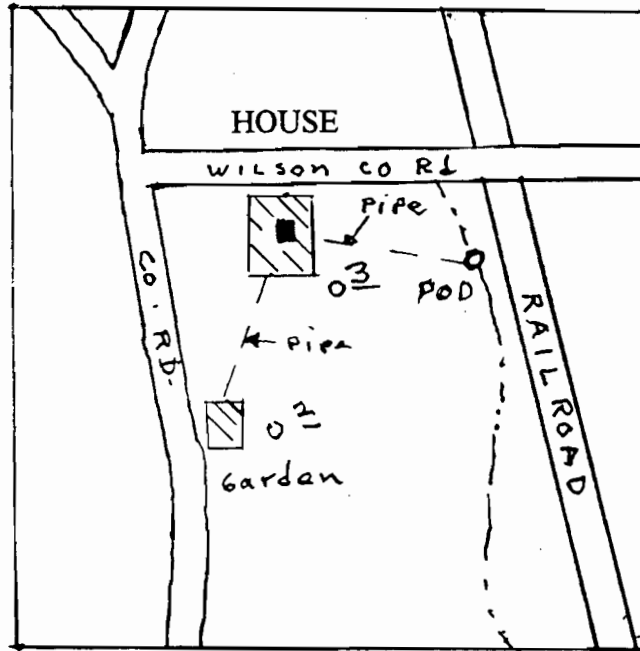

1 INCH = 400 FEET

THE POINT OF DIVERSION IS LOCATED  
805 FEET NORTH AND 2260 FEET EAST  
FROM THE SW CORNER OF SECTION 10.

THE PURPOSE OF THIS MAP IS TO IDENTIFY THE  
LOCATION OF THE WATER RIGHT. IT IS NOT  
INTENDED TO PROVIDE LEGAL DIMENSIONS OR  
THE LOCATION OF PROPERTY OWNERSHIP LINES.

