

T. 20S., R. 9 W., W. M.

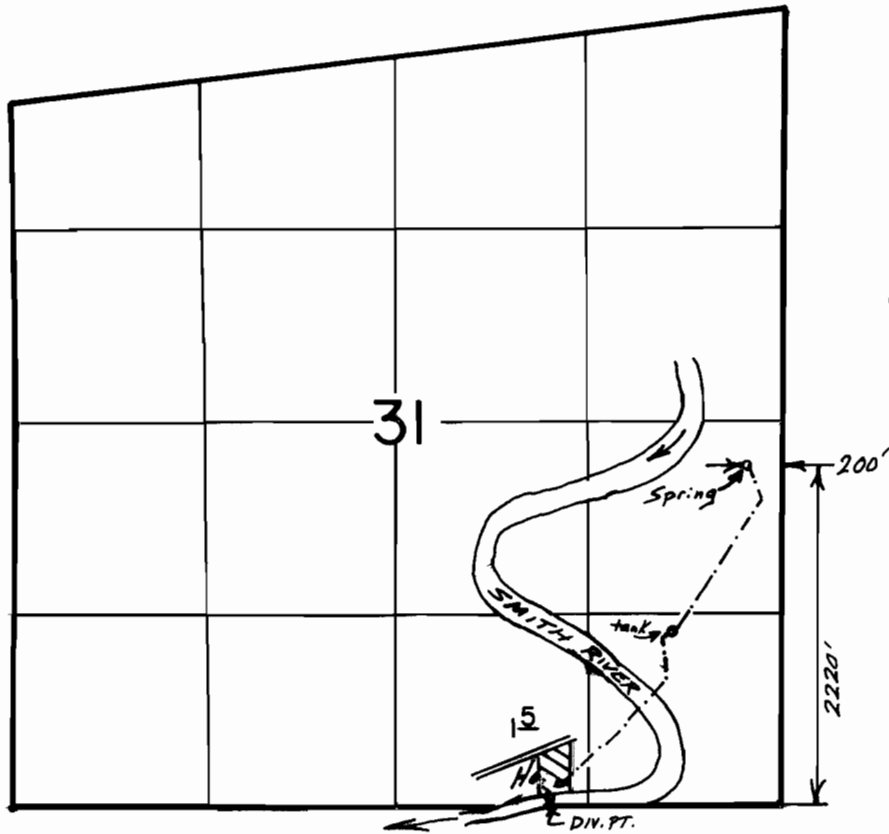

RIVER DIV. PT. : 80' N & 1580' W FROM SE 1/4 COR.

Scale 1" = 1320'

**FINAL PROOF SURVEY
UNDER**

Application No. 58685. Permit No. 44289...
IN NAME OF

...ARTHUR O. & ISOBEL...TOLLEFSON

Surveyed Sept. 14, 1994, by B.S. DeHaas....