

# FINAL PROOF SURVEY MAP

**RECEIVED**

SEP 8 1993

IN THE NAME OF TONY DOMINGUEZ

WATER RESOURCES DEPT.  
SALEM, OREGON

SECTION 34, TOWNSHIP 28 SOUTH, RANGE 4 WEST, W.M.

APPLICATION R-69857  
APPLICATION 69858

PERMIT R-11106  
PERMIT 50667

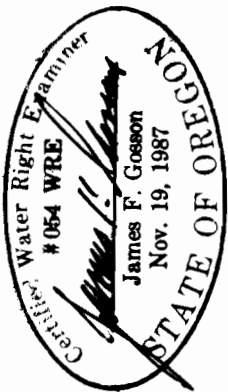
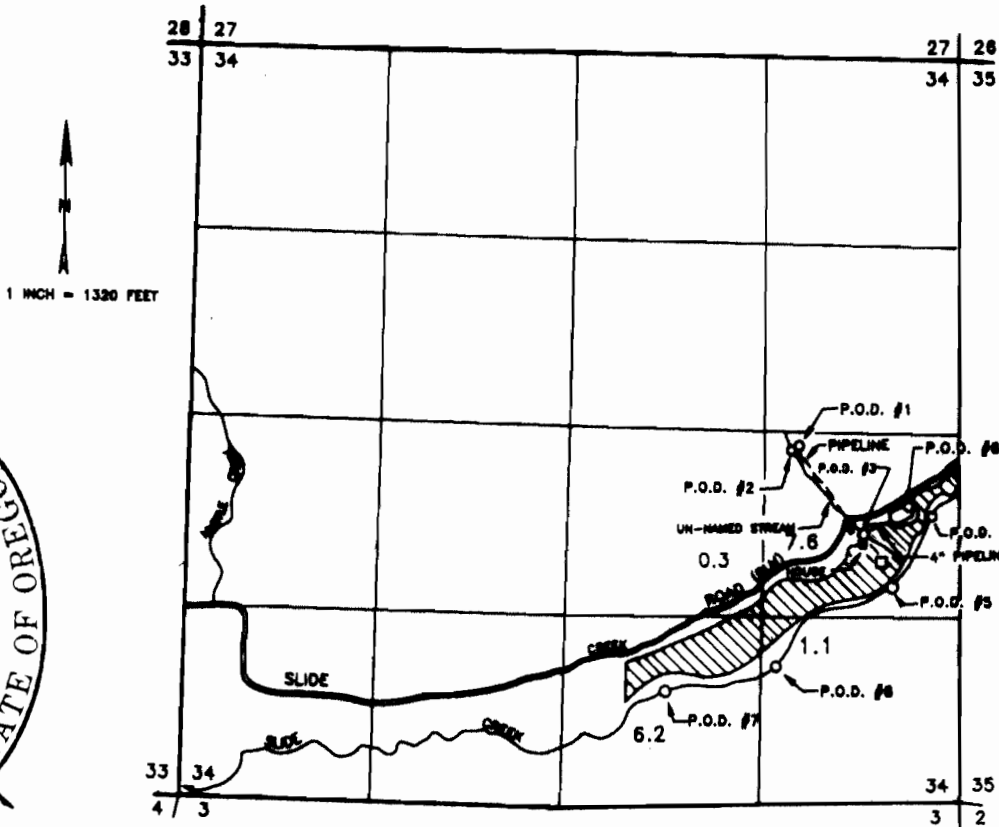

P.O.D. #	FT. SOUTH	FT. WEST	FROM	1/4 1/4	SOURCE
1	120	1080	EAST 1/4 COR. SEC. 34	NE1/4 SE1/4	SPRING
2	130	1110	"	NE1/4 SE1/4	UN-NAMED STREAM
3	870	830	"	NE1/4 SE1/4	UN-NAMED STREAM
4	880	200	"	NE1/4 SE1/4	SLIDE CR
5	1010	480	"	NE1/4 SE1/4	SLIDE CR
6	1800	1240	"	SE1/4 SE1/4	SLIDE CR
7	1780	1880	"	SW1/4 SE1/4	SLIDE CR
8	480	340	"	NE1/4 SE1/4	RESERVOIR

THE PURPOSE OF THIS MAP IS TO IDENTIFY THE LOCATION OF THE WATER RIGHT. IT IS NOT INTENDED TO PROVIDE INFORMATION RELATIVE TO THE LOCATION OF PROPERTY OWNERSHIP BOUNDARY LINES.