

FINAL PROOF SURVEY MAP

RECEIVED

IN THE NAME OF RICHARD PIERCE

MAR 18 1993

SECTIONS 29 & 32, T 26 S, R 3 W, W.M.

WATER RESOURCES DIVISION  
SALEM, OREGON

APPLICATION 70209

PERMIT 51086

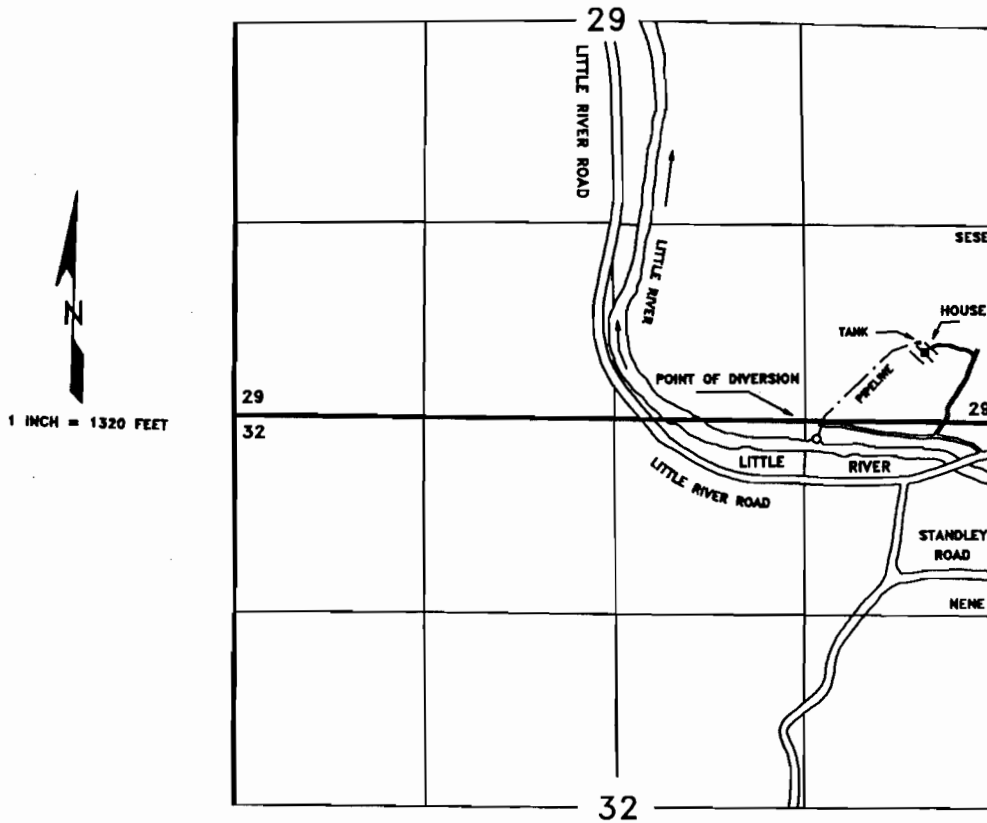

THE POINT OF DIVERSION IS LOCATED 140 FEET SOUTH AND 1240 FEET WEST FROM THE NORTHEAST SECTION CORNER OF SECTION 32, BEING WITHIN THE NE $\frac{1}{4}$ NE $\frac{1}{4}$  OF SECTION 32, TOWNSHIP 26 SOUTH, RANGE 3 WEST, W.M.; WITHIN DOUGLAS COUNTY.

THE PURPOSE OF THIS MAP IS TO IDENTIFY THE LOCATION OF THE WATER RIGHT. IT IS NOT INTENDED TO PROVIDE INFORMATION RELATIVE TO THE LOCATION OF PROPERTY OWNERSHIP BOUNDARY LINES.

Certified Water Right Examiner  
#054 WRE  
*James F. Gosson*  
James F. Gosson  
Nov. 19, 1987  
STATE OF OREGON