

FINAL PROOF SURVEY MAP

IN THE NAME OF HOLM BROTHERS LUMBER COMPANY

SECTIONS 9 & 16, TOWNSHIP 26 SOUTH, RANGE 3 WEST, W.M.

APPLICATION 70855

PERMIT 51373

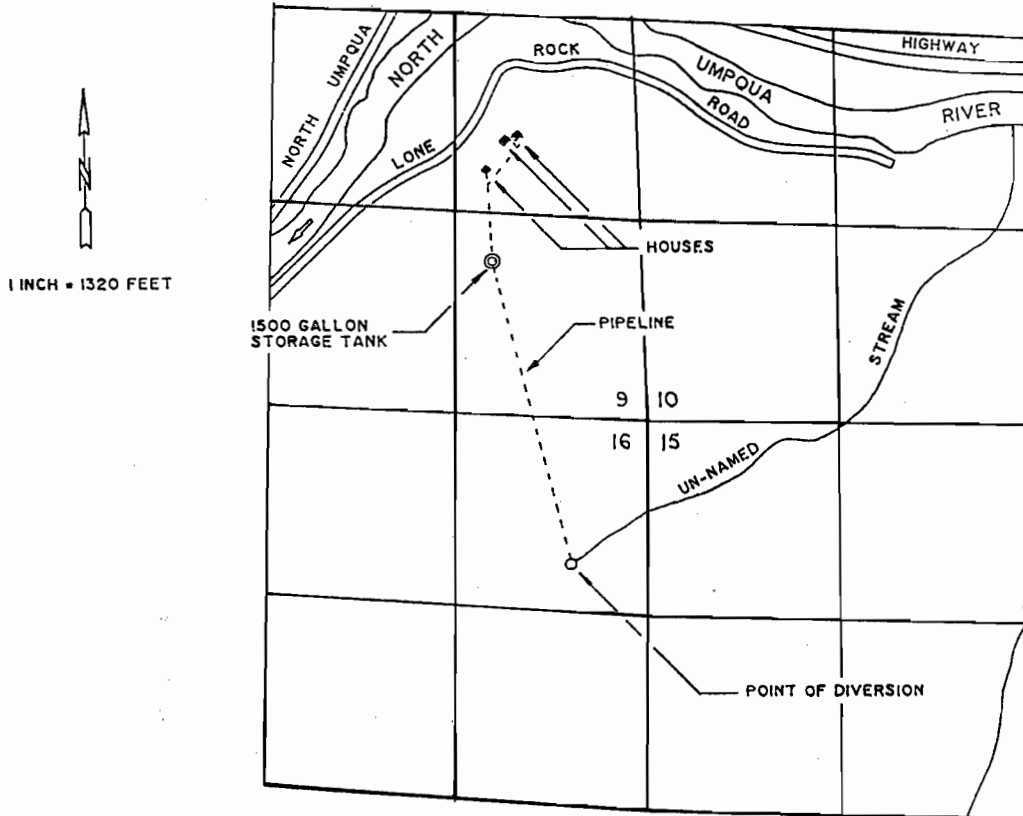

THE POINT OF DIVERSION IS LOCATED 1000 FEET SOUTH AND 500 FEET WEST FROM THE NORTHEAST CORNER OF SECTION 16, BEING WITHIN THE NE 1/4 OF THE NE 1/4 OF SECTION 16, TOWNSHIP 26 SOUTH, RANGE 3 WEST, W.M., DOUGLAS COUNTY.

THE PURPOSE OF THIS MAP IS TO IDENTIFY THE LOCATION OF THE WATER RIGHT. IT IS NOT INTENDED TO PROVIDE INFORMATION RELATIVE TO THE LOCATION OF PROPERTY OWNERSHIP BOUNDARY LINES.

