

RECEIVED

NOV 04 1998

WATER RESOURCES DEPT.
SALEM, OREGON

T24S.R7W.W.M.

1 INCH = 1320 FEET

SECTION 15

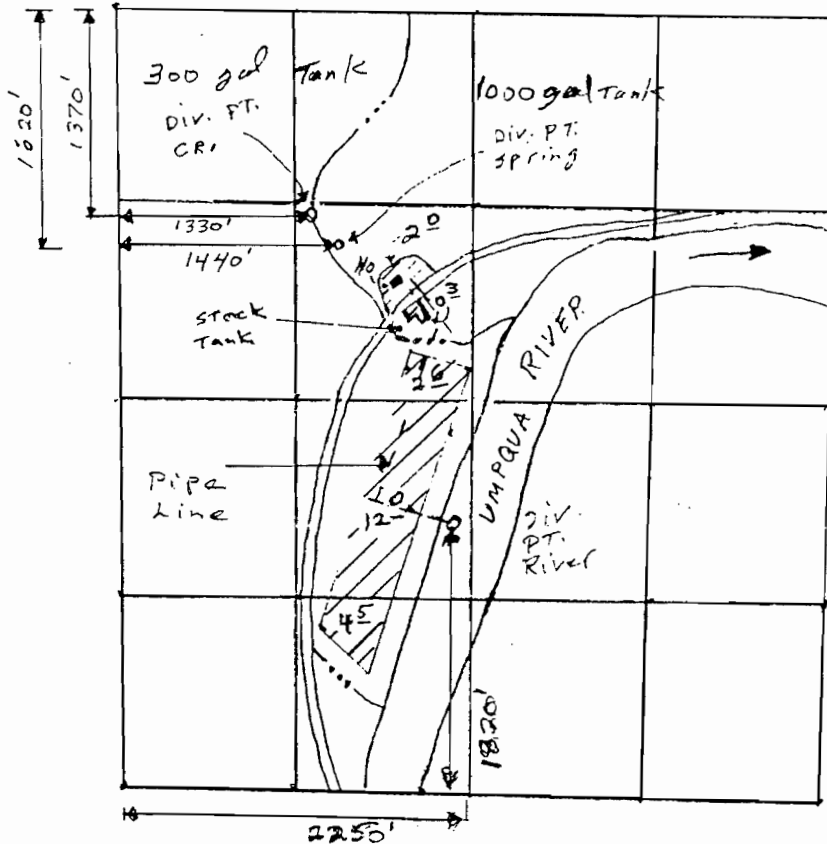

THE PURPOSE OF THIS MAP IS TO IDENTIFY THE LOCATION OF THE WATER RIGHT. IT IS NOT INTENDED TO PROVIDE INFORMATION RELATIVE TO THE LOCATION OF PROPERTY OWNERSHIP BOUNDARY LINES.



FINAL PROOF SURVEY UNDER

Application No. 71997 Permit No. 54017

IN NAME OF

ROBERT J. AND NORMA L. SCHARF

Surveyed OCT 10 1998 by DUANE KIRBY