

T26S, R5W, WM

SCALE 1" = 400'

DOUGLAS COUNTY

RECEIVED

SEP 28 1998

WATER RESOURCES DEPT.  
SALEM, OREGON

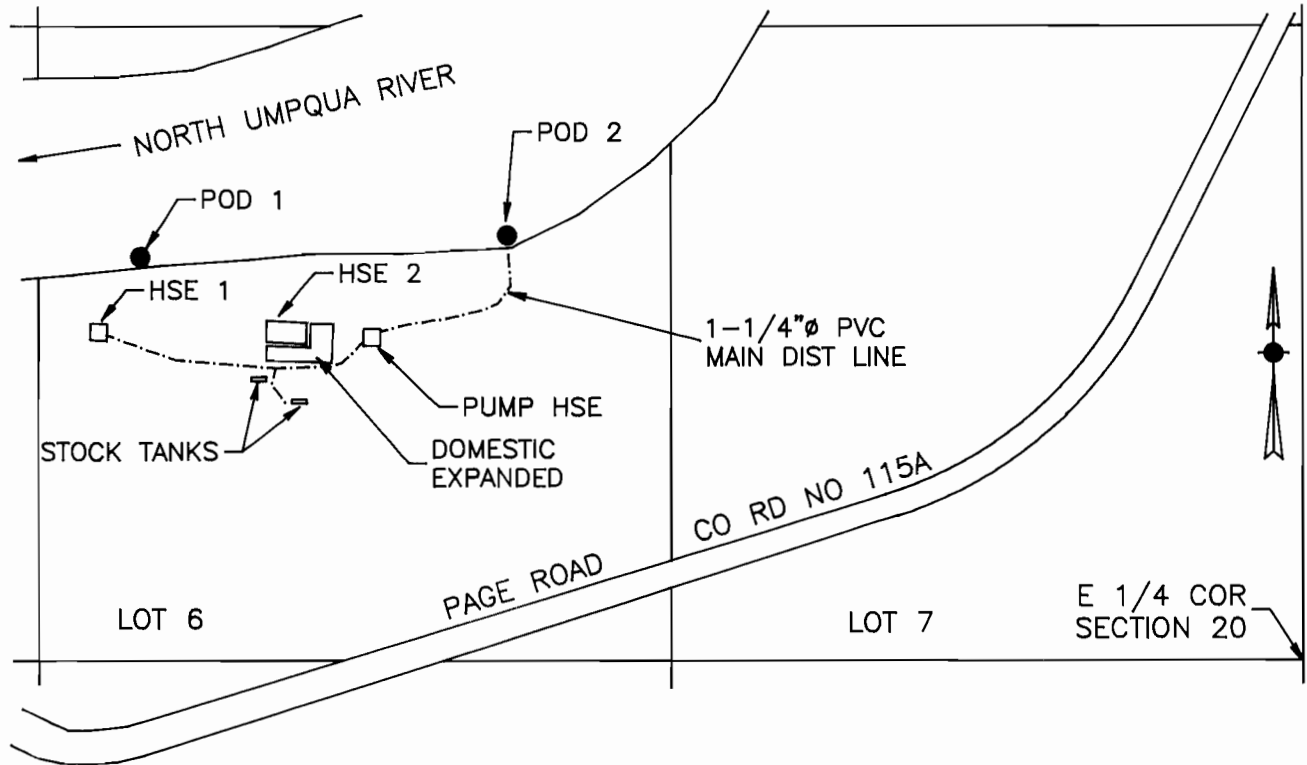

POD 1 IS 840 FT N AND 2425 FT W FROM E 1/4 COR, SEC 20  
 POD 2 IS 885 FT N AND 1660 FT W FROM E 1/4 COR, SEC 20

FINAL PROOF SURVEY  
 UNDER

MAURICE E FARR, CWRE  
 395 NE KIRBY AVENUE  
 ROSEBURG, OR 97470

Application No. S-72055 Permit No. 51574

IN NAME OF  
 HJALMER A. JOHNSON ESTATE & BETTY JANE HENBEST

Surveyed September 7, 1998 by M E Farr



THIS IS A LOCATION MAP FOR A FINAL PROOF SURVEY BY HJALMER A. JOHNSON ESTATE AND BETTY JANE HENBEST. THIS MAP IS FOR THE PURPOSE OF IDENTIFYING THE LOCATION OF THE WATER RIGHT ONLY AND IS NOT INTENDED TO PROVIDE LEGAL DIMENSIONS OR LOCATIONS OF PROPERTY OWNERSHIP LINES.

EXPIRES 12-31-99