

T.30S., R.3&4 W., W.M.

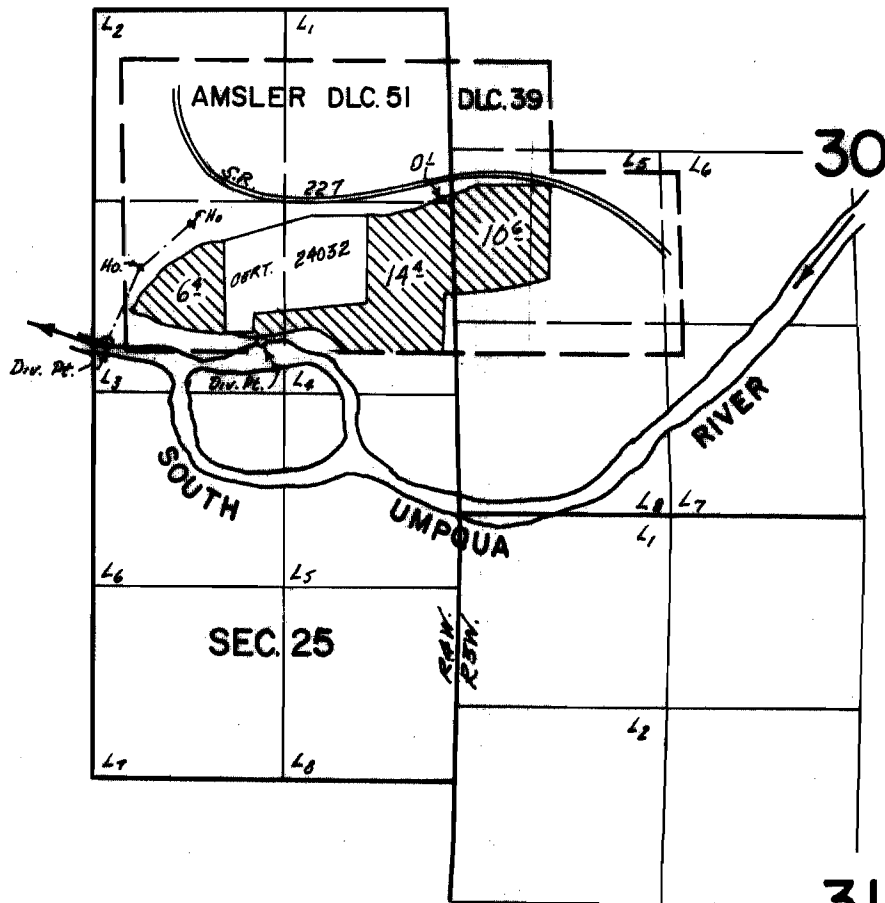

Div. Pts. loc. 1960' S. & 80' W.; 980' E. & 1930' S. from the NW cor.

DLC. 51.

FINAL PROOF SURVEY UNDER

Application No. 43778 Permit No. 32713
IN NAME OF

ARTHUR MILLER

Surveyed Sept. 15, 1972, by D. Norby