

T.37 S. R.07 W. W.M.

IN THE NAME OF:
DONALD D. SIMPSON
2090 WATERS CREEK RD.
WILDERVILLE, OR 97543

SOURCE:
WATERS CREEK, A TRIBUTARY
OF SLATE CREEK

FINAL PROOF SURVEY
UNDER
TRANSFER T - 7268

FORMER
POINT OF DIVERSION:

PRIMARY (CERT. 3431):
990' NORTH & 2970' WEST
FROM NE COR. SECTION 5

SUPPLEMENTAL (CERT. 3957):
BOMGARDNER RESERVOIR
IN THE SE 1/4, SW 1/4
OF SECTION 32.



SE 1/4, SW 1/4
SECTION 32

T.36 S. R.07 W.

T.37 S. R.07 W.

31 | 32

6 | 5

20.75 CHAINS G.L.O. RECORD



SCALE : 1" = 400'

NE 1/4 NW 1/4

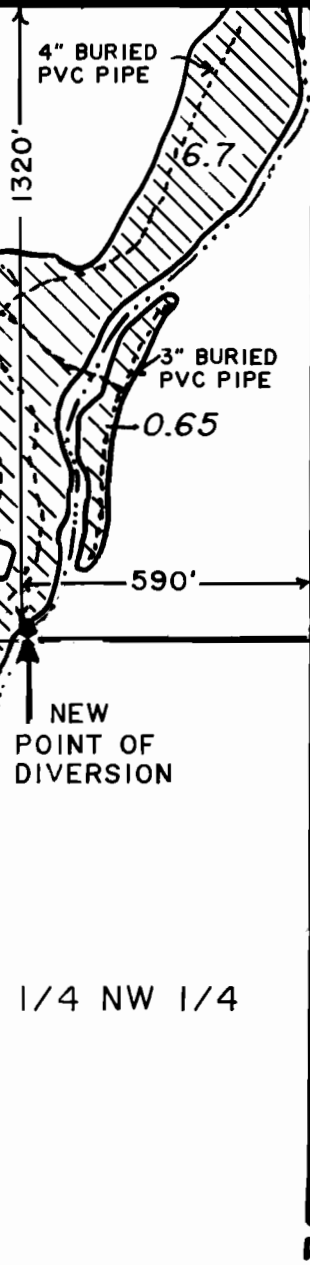

4" BURIED
PVC PIPE

3" BURIED
PVC PIPE

2" BURIED
PVC PIPE

4" BURIED
PVC PIPE

NEW
POINT OF
DIVERSION

SE 1/4 NW 1/4

WATERS CREEK

5

THIS MAP IS FOR THE PURPOSE OF
IDENTIFYING THE LOCATION OF THE
WATER RIGHT ONLY AND IS NOT IN-
TENDED TO PROVIDE LEGAL DIMEN-
SIONS OR LOCATIONS OF PROPERTY
OWNERSHIP LINES.

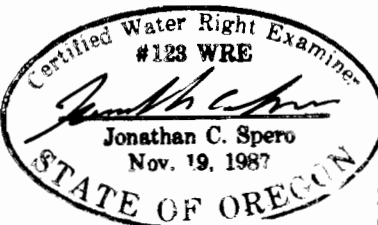

EXPIRES 06/30/98

PREPARED BY:
JONATHAN C. SPERO C.W.R.E. 123
1002 KINCAID RD./P.O. BOX 16
WILLIAMS, OREGON 97544
PHONE (503) 846-6845

SURVEYED JULY 30, 1997
BY: *Jonathan C. Spero*