

U-238
22844
6867

T. 38S, R. 11E, W. 11

Bucke Ck. : Yanna Valley wells

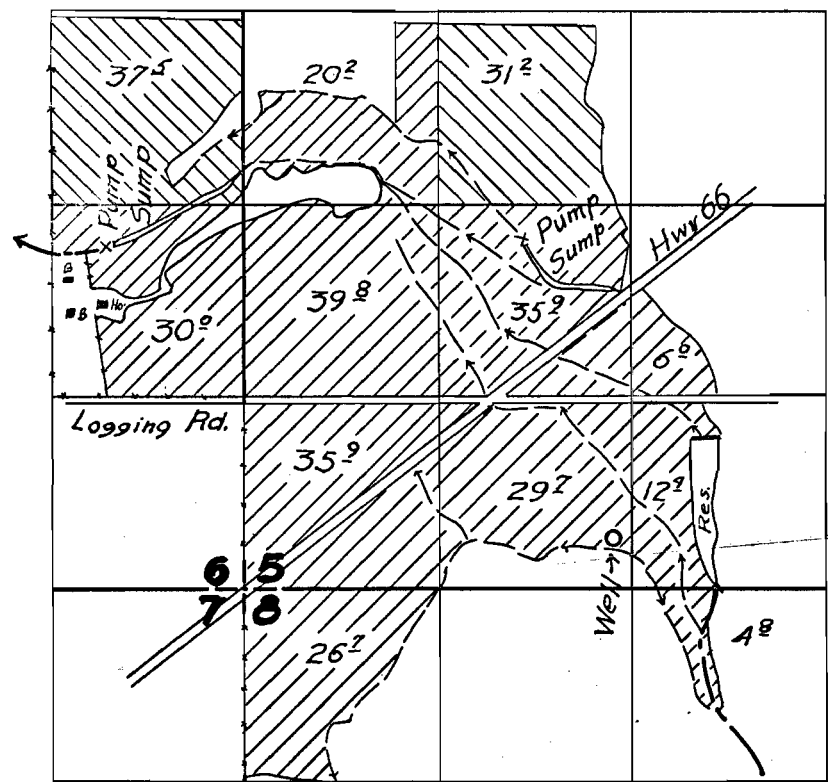

FINAL PROOF SURVEY

UNDER

U-269

U-238



Application No. U-407

Permit No. U-377



IN NAME OF

LEONARD G. RITTER

Surveyed 14 May 1955, by H.L. Coffman