

RECEIVED

DEC 3 1 2001

WATER RESOURCES DEPT.
SALEM, OREGON

FINAL PROOF SURVEY MAP
T25S, R5W, W1M
DOUGLAS COUNTY
SCALE 1" = 1320'

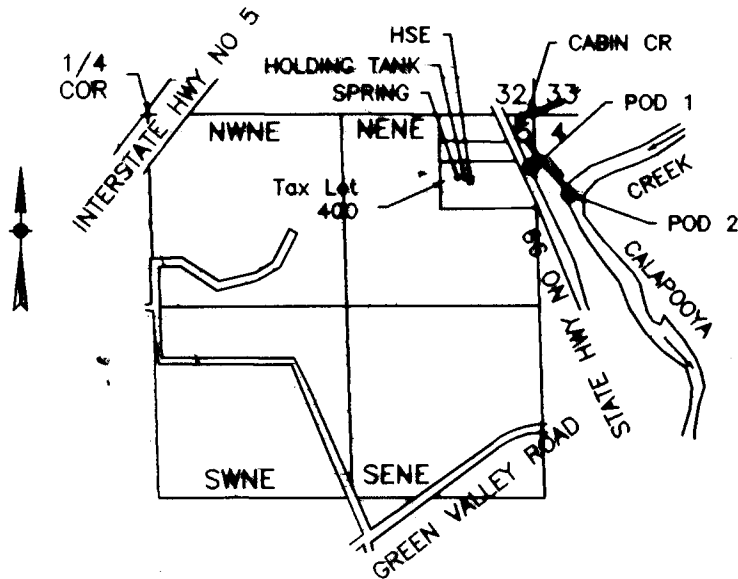

SPRING IS 430 FT S AND 525 FT W FROM NE COR SEC 5
POD 1 IS 360 FT S AND 20 FT W FROM NE COR SEC 5
POD 2 IS 540 FT S AND 240 FT E FROM NE COR SEC 5

FINAL PROOF SURVEY

UNDER

Application No. S-71576 Permit No. S-54016

IN NAME OF
NANCY AUSTIN

Surveyed August 4, 2001 by M.E. Farr

NANCY AUSTIN
18032 STATE HWY 99 N
OAKLAND, OR 97462

MAURICE E FARR
WATER RIGHT EXAMINER
395 NE KIRBY AVENUE
ROSEBURG, OR 97470

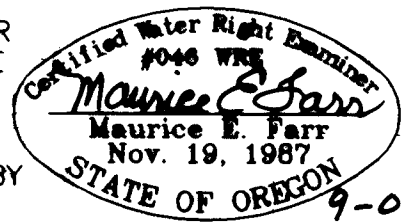

THIS IS A LOCATION MAP FOR A FINAL PROOF SURVEY BY NANCY AUSTIN. THIS MAP IS FOR THE PURPOSE OF IDENTIFYING THE LOCATION OF THE WATER RIGHT ONLY AND IS NOT INTENDED TO PROVIDE LEGAL DIMENSIONS OR LOCATIONS OF PROPERTY OWNERSHIP LINES.

EXPIRES 12-31-01