

FINAL PROOF SURVEY MAP
T26S, R3W, WM

SCALE 1" = 1320'

DOUGLAS COUNTY

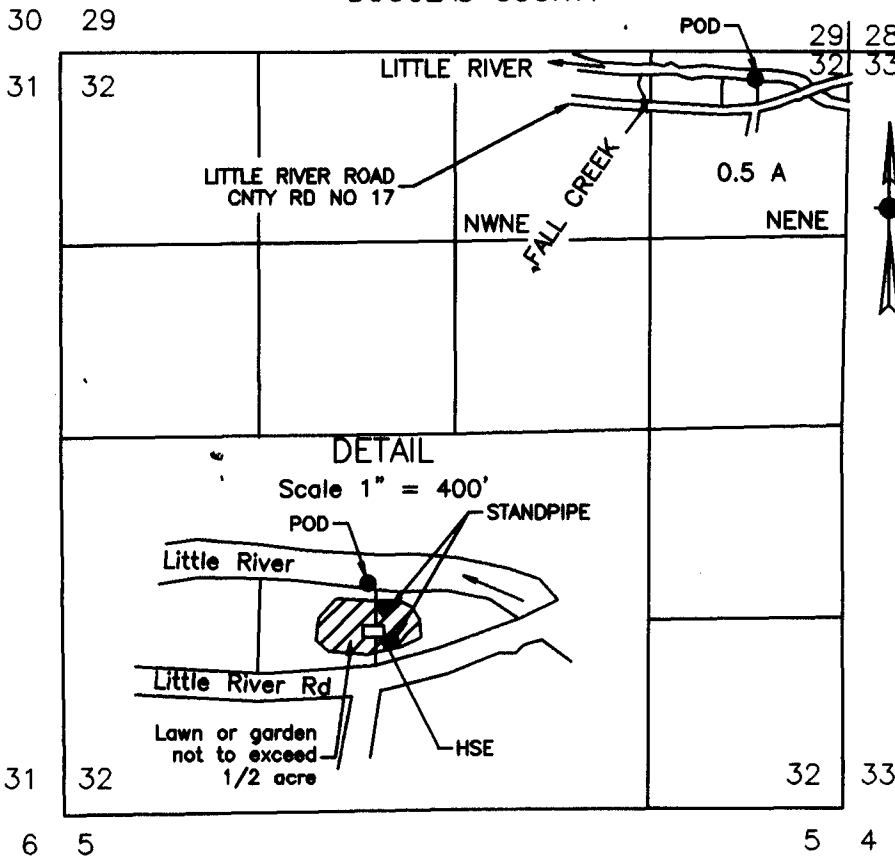

RECEIVED

SEP 28 1999

WATER RESOURCES DEPT.
SALEM OREGON

POD IS 190 FT S AND 660 FT W FROM NE COR SEC 32

FINAL PROOF SURVEY
UNDER

Application No. S-80642 Permit No. 52867

IN NAME OF

Steven J Gobat

Surveyed March 15, 1999 by M E Farr

THIS IS A LOCATION MAP FOR A FINAL PROOF SURVEY BY STEVEN J. GOBAT. THIS MAP IS FOR THE PURPOSE OF IDENTIFYING THE LOCATION OF THE WATER RIGHT ONLY AND IS NOT INTENDED TO PROVIDE LEGAL DIMENSIONS OR LOCATIONS OF PROPERTY OWNERSHIP LINES.

MAP PREPARED FOR:
STEVEN J GOBAT
2545 BIG CREEK ROAD
NEWPORT, OR 97365

MAP PREPARED BY:
MAURICE E FARR, CWRE
395 NE KIRBY AVENUE
ROSEBURG, OR 97470

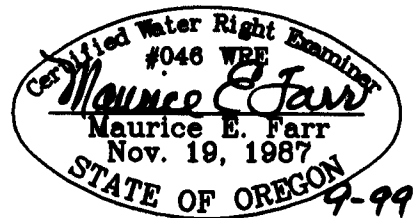

EXPIRES 12-31-99