

RECEIVED

FINAL PROOF SURVEY

IN THE NAME OF DONALD E. PAYNE

SEP 24 1993

WATER RESOURCES DEPT

SALEM, OREGON



1 INCH = 400 FEET

SECTION 19, TOWNSHIP 26 SOUTH, RANGE 4 WEST, W.M.

APPLICATION 69670

PERMIT 50683

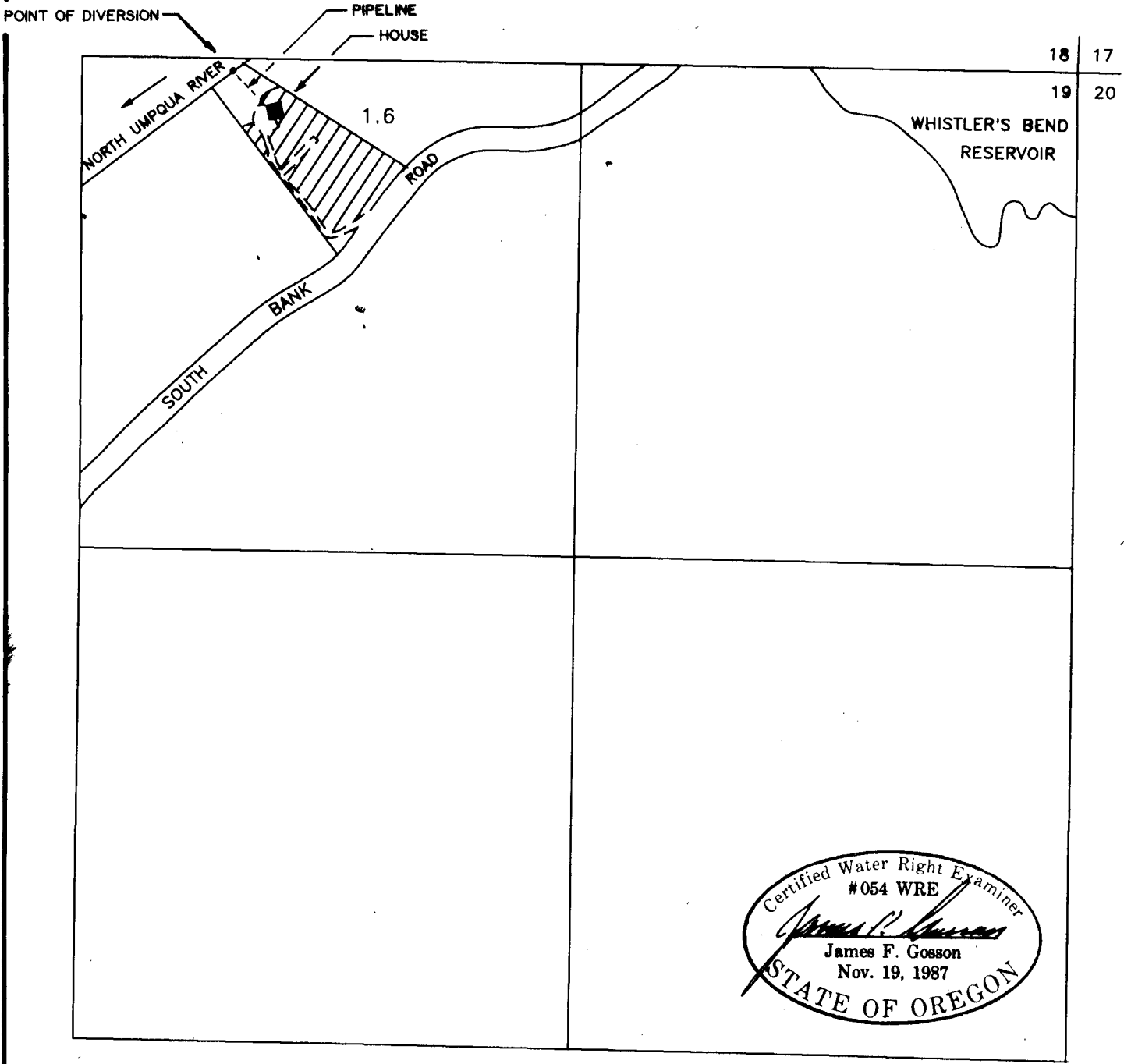

Certified Water Right Examiner  
 #054 WRE  
*James F. Gosson*  
 James F. Gosson  
 Nov. 19, 1987  
 STATE OF OREGON

THE POINT OF DIVERSION IS LOCATED 50 FEET SOUTH AND 2270 FEET WEST FROM THE NORTHEAST CORNER OF SECTION 19, BEING WITHIN THE NW 1/4 OF THE NE 1/4 OF SECTION 19, TOWNSHIP 26 SOUTH, RANGE 4 WEST, W.M., DOUGLAS COUNTY.

THE PURPOSE OF THIS MAP IS TO IDENTIFY THE LOCATION OF THE WATER RIGHT. IT IS NOT INTENDED TO PROVIDE INFORMATION RELATIVE TO THE LOCATION OF PROPERTY OWNERSHIP BOUNDARY LINES.