

T.6N. R.35E. W.M.

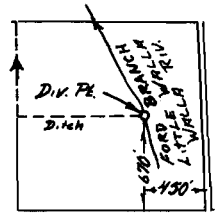
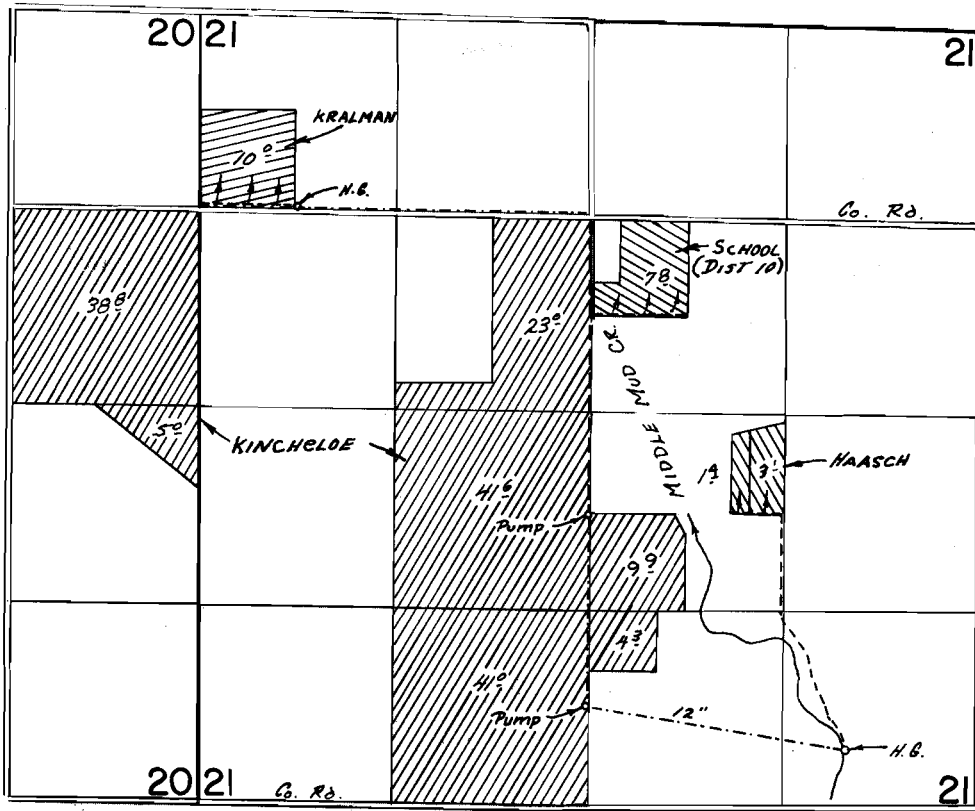

SE 1/4 NE 1/4 SEC 27
T. 6 N. R. 35 E. W.M.

FINAL PROOF SURVEY UNDER

Application No. 44614 Permit No. 33427
IN NAME OF

FRUITVALE WATER USERS ASSOCIATION

Surveyed APRIL 10 1978, by R. G. MUCKEN