

RECEIVED

AUG 6 - 1979

WATER RESOURCES DEPT  
SALEM, OREGON

SECTION 0

~~NW $\frac{1}{4}$  SE $\frac{1}{4}$~~

TOWNSHIP 26<sup>S</sup> RANGE 40<sup>E</sup> W.M.

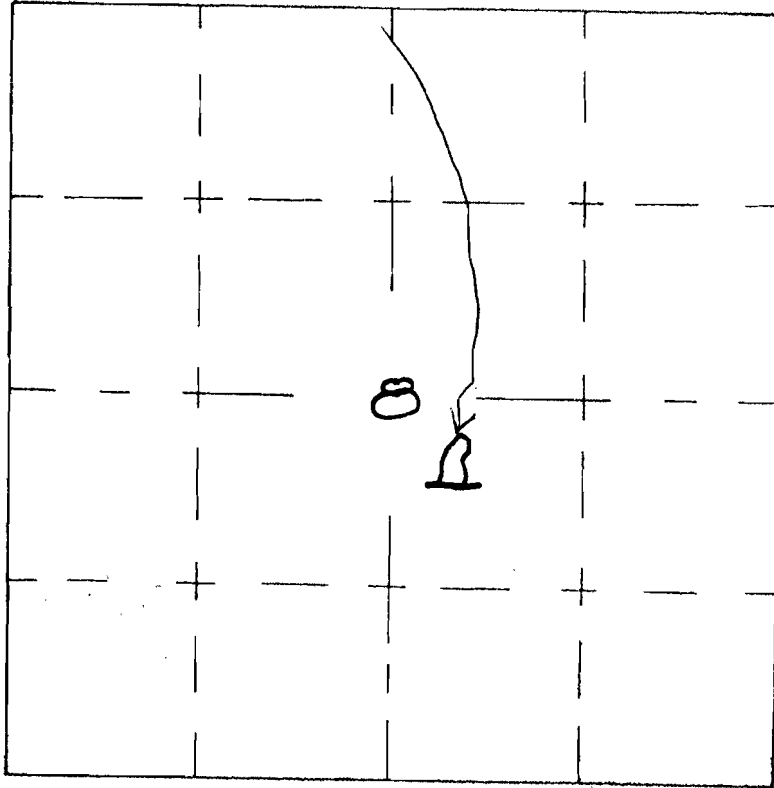

Application No. R59046

Permit No. R 8693

U. S. DEPARTMENT OF THE INTERIOR  
BUREAU OF LAND MANAGEMENT

TIFFIN #1

DESIGNED _____	RECOMM. _____
DRAWN _____	RECOMM. _____
CHECKED _____	APPROVED _____

CHIEF, DIV. OF ENG.





SCALE _____	
DATE _____	SHEET _____ OF _____
DRAWING NO. _____	

# APPLICATION MAP FOR PERMIT TO CONSTRUCT A RESERVOIR

SE1/4 NW1/4 SEC 8 T 26S R 40E W.M.

U.S.G.S. QUAD - BURNT FLAT, OREG. - 7 1/2'

## LEGEND

-  RESERVOIR
-  ROAD
-  CHANNEL
-  FD SEC COR

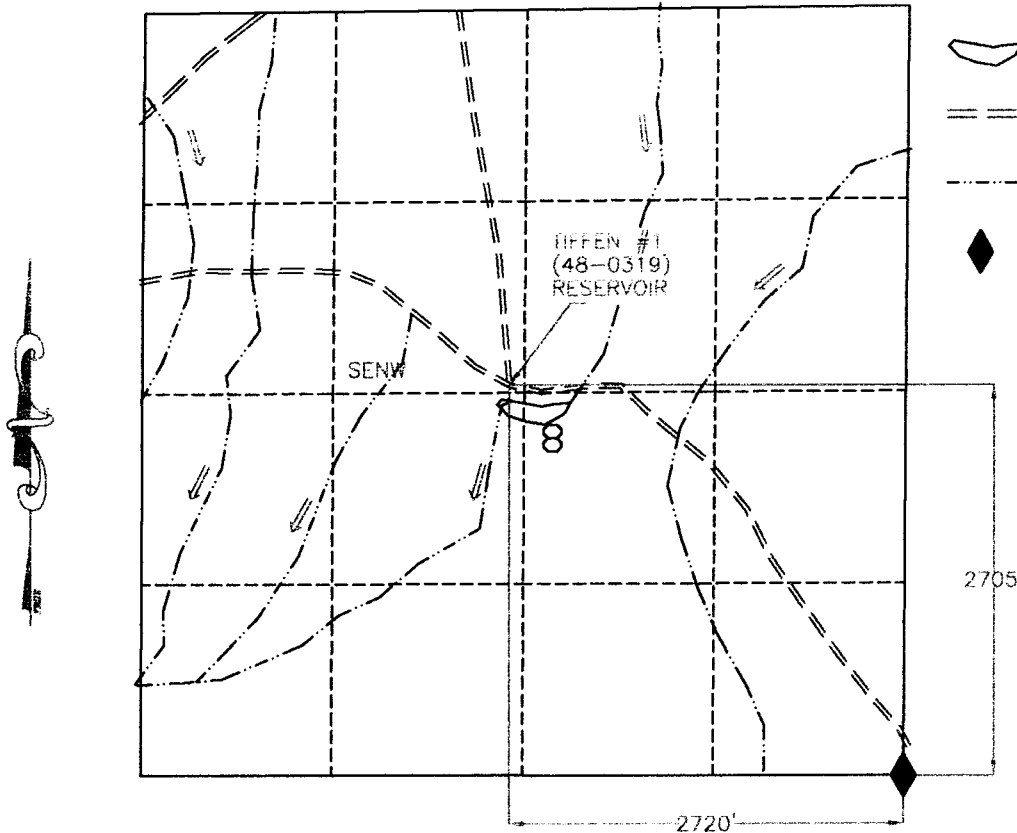

TIFFEN #1 (48-0319) RESERVOIR

RECEIVED

MAR 07 2002

WATER RESOURCES DEPT.  
SALEM, OREGON

TIFFEN #1 (48-0319)  
RESERVOIR PROJECT MON.:  
LAT 43°19'40.61977"  
LONG 117°50'43.47868"  
U.S. 1927 NADCON

1320 660 0 1320

SCALE 1"=1320'

THIS MAP IS FOR THE PURPOSE OF LOCATING  
A WATER RIGHT AND IS NOT INTENDED TO  
PROVIDE LEGAL DIMENSIONS FOR LOCATION  
OF PROPERTY BOUNDARIES.



UNITED STATES DEPARTMENT OF THE INTERIOR  
BUREAU OF LAND MANAGEMENT  
DIVISION OF OPERATIONS VALE DISTRICT

## TIFFEN #1 (48-0319) RESERVOIR

DESIGNED \_\_\_\_\_

REVIEWED \_\_\_\_\_

APPROVED \_\_\_\_\_

CHIEF, BRANCH OF ENGINEERING

DRAWN: CG

SCALE: 1"=1320'

DATE: 10/31/00

SHEET 1 OF 1

ACAD14  
DWG FILE: TIFFEN.DWG

DRAWING NO. OR-03-9172.45-1069