

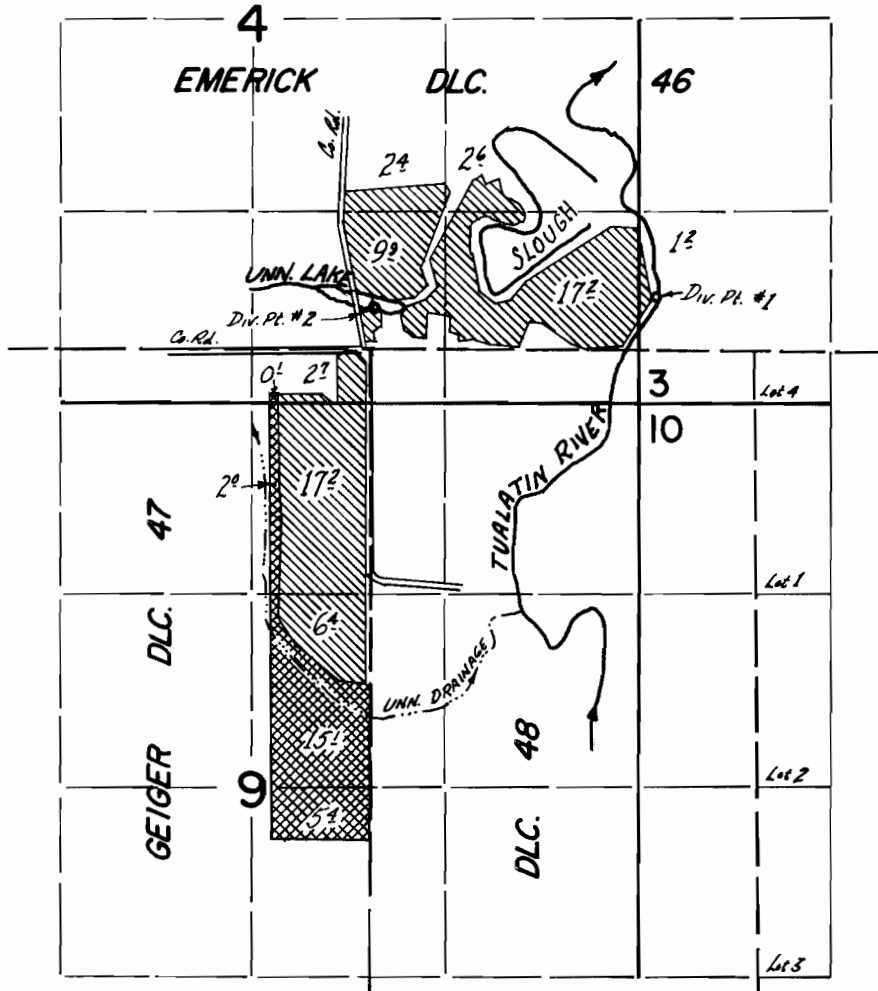

T. 1 S., R. 3 W., W.M.



Div. Pts. located: #1 - 260 ft. N. & 20 ft. E.; #2 - 350 ft. N. & 1950 ft. E., both from NE cor. GEIGER DLC. 47.

PRIMARY - 
(RIVER)

SUPPLEMENTAL - 
(LAKE)

FINAL PROOF SURVEY UNDER

Application No. 43248 Permit No. 32248
IN NAME OF

JOHN V. & LILLIAN J. ELSBERRY

Surveyed 14 JUNE 1972, by D. NORBY