

# FINAL PROOF SURVEY

SITUATED IN THE S1/2 SW1/4 OF SECTION 18, AND THE  
N1/2 NW1/4 OF SECTION 19, T41S, R13EWM,  
KLAMATH COUNTY, OREGON  
DECEMBER, 2001

## MAP PREPARED FOR

LOYAL H. LOVENESS, MILDRED H. LOVENESS,  
AND LOREN AND ELSIE LOVENESS

## MAP PREPARED FROM

--APPLICATION MAP--  
--AERIAL PHOTOGRAPHS--  
--FIELD INSPECTION--

APPLICATION #G-13168

PERMIT #G-12797



SCALE  
1" = 1320'

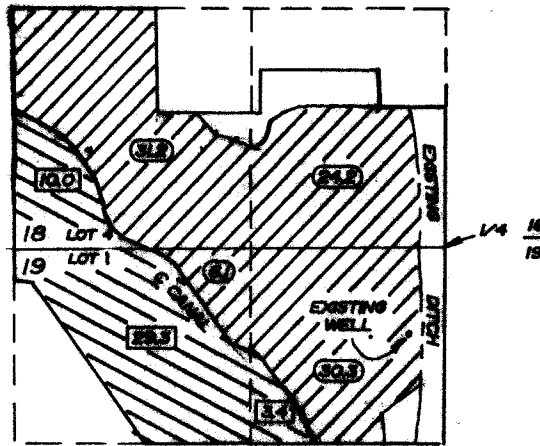

TOTAL AREA  
--134.5 Ac.--

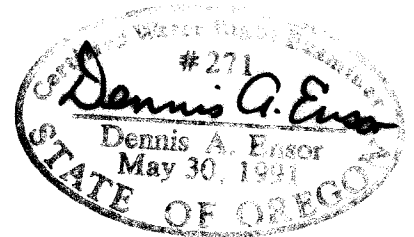

RECEIVED

JAN 17 2002

WATER RESOURCES DEPT.  
SALEM, OREGON

### LOCATION OF WELL

590 FEET SOUTH AND 240 FEET WEST OF THE  
1/4 CORNER BETWEEN SECTION 18 & 19



SUPPLEMENTAL TO MALIN IRRIGATION DISTRICT



PRIMARY LANDS THIS SURVEY

THE PURPOSE OF THIS MAP IS TO IDENTIFY THE LOCATION OF THE  
WATER RIGHT. IT IS NOT INTENDED TO PROVIDE INFORMATION RELATIVE  
TO THE LOCATION OF PROPERTY OWNERSHIP BOUNDARY LINES.

TRU-LINE SURVEYING, INC.  
2333 SUMMERS LANE  
KLAMATH FALLS, OREGON 97603