

T.4N., R.28E., W.M.

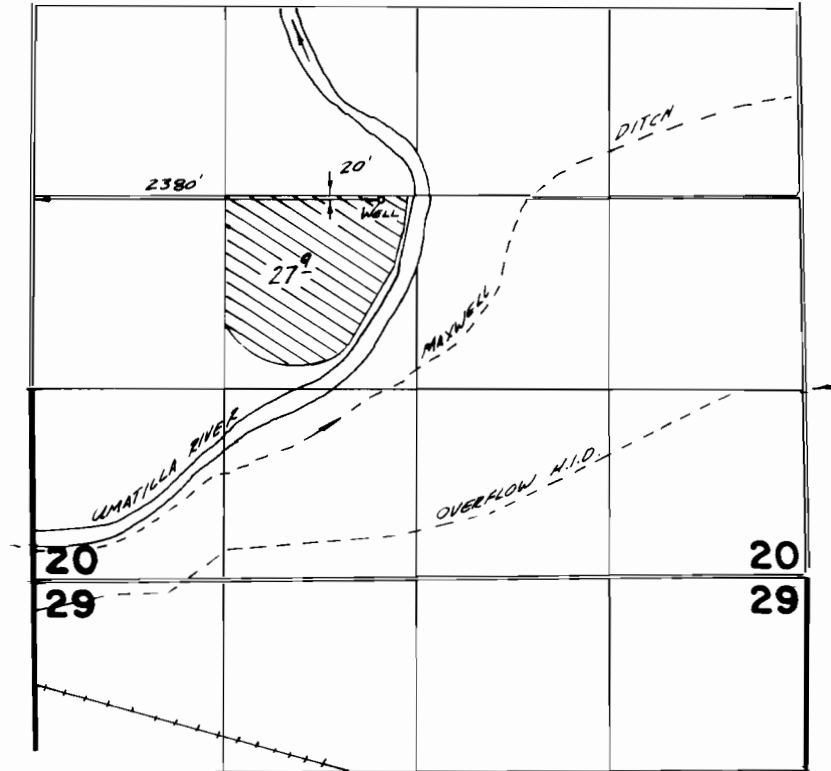

FINAL PROOF SURVEY
UNDER

Application No. **G:5947** Permit No. **G:6785**
IN NAME OF

BENJAMIN J. NEWMAN

Surveyed *July 27* 19*82*, by *V.L. Church*

2002 WESTLAND IRRIGATION DISTRICT 540:580 TRANSFER MAP L. WADEKAMPER TO M. NEWMAN



JULY 1907 CERT 76717
AND PERMIT 7400



MARCH 14, 1903 CERT 76715
AND PERMIT 7400

FROM
T5N., R 28E., W.M.

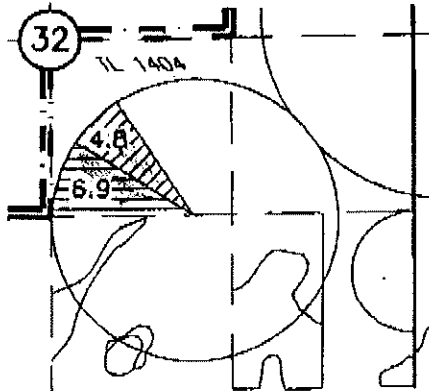

T3N., R 29E., W.M.

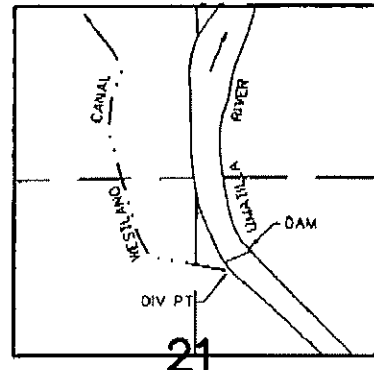

DIV PT LCT N.76°45'56"E. 2913.18' FROM W.1/4 COR. SEC 21
WESTLAND IRRIGATION DISTRICT

TO
T4N., R 28E., W.M.

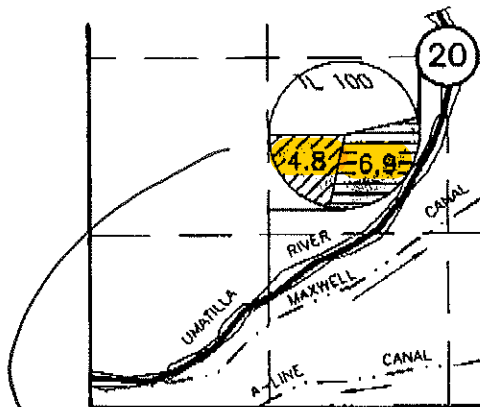

**T-9311 Diminution of 11.7
acres on C. 54736 (CN.)
Issued RR C.79893**

*UNDERLYING GW RIGHT (PRIMARY)
DIMINISHED TO SUPPLEMENTAL
FOR 11.7 ACRES.
SEE AFFIDAVIT. (ATTACHED)*

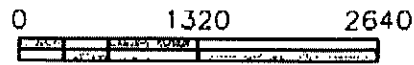

SCALE IN FEET

NOTE: THE PURPOSE OF THIS MAP IS TO IDENTIFY THE APPROXIMATE LOCATION
OF THE WATER RIGHT. IT IS NOT INTENDED TO PROVIDE INFORMATION
RELATIVE TO THE LOCATION OF PROPERTY OWNERSHIP BOUNDARY LINES.

04/20/02
3522.137
3522137WADE.DWG

SCM Architects & Engineers
Consultants, Inc. Kennewick, WA 99336

THIS SUPERSEDES ORIGINAL