

T 13 S, R 30 E, WM

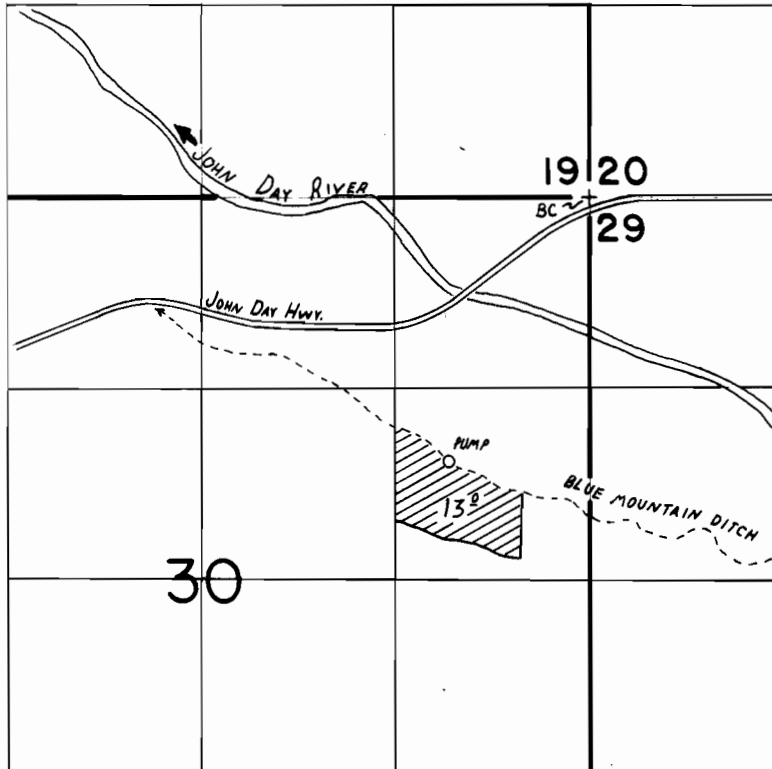

SCALE
1" = 1320'

SECTION 29

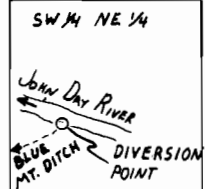

DIVERSION LOCATED
2150' S AND 3000' E
FROM THE NW CORNER
SECTION 29.

FINAL PROOF SURVEY

UNDER

Application No. 65334. Permit No. 47938...
IN NAME OF

NEIL J. & JANICE L. BAUER...

SURVEYED JUNE 20 88 T. M. WARREN
BY JULY 7 1987, by V. L. CHURCH..

RWK
41023 179 2704