

T.6S., R.39E., W.M.

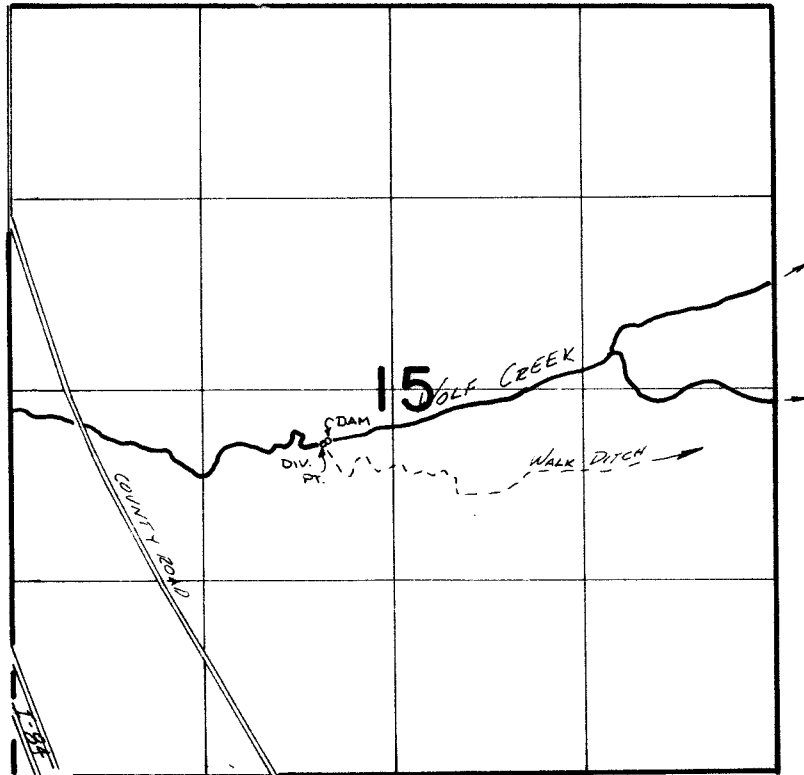

*Div. Pt. Loc.: 370'S. & 490'W. FROM CENTER COR. SEC 15*

**FINAL PROOF SURVEY**  
UNDER

**TRANSFER 4669**

IN NAME OF

.....**DON DODSON**.....

Surveyed *Nov. 20* 19*81*, by *V. L. Church*.....