

CLAIM OF BENEFICIAL USE MAP T.34 S. R.08 W. W.M.

UNDER CERTIFICATE No. 55728
TRANSFER No. T-7121

IN NAME OF:
GILBERT L. and MARY L. THOMASON

SURVEYED MAY 30, 2001

BY:

JONATHAN C. SPERO C.W.R.E. 123
1002 KINCAID RD./P.O. BOX 16
WILLIAMS, OREGON 97544
PH. (541) 846-6845

SCALE: 1" = 400'

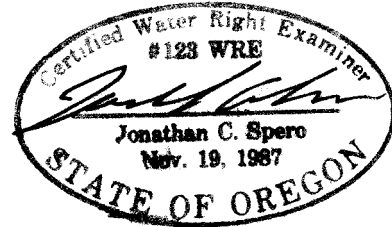
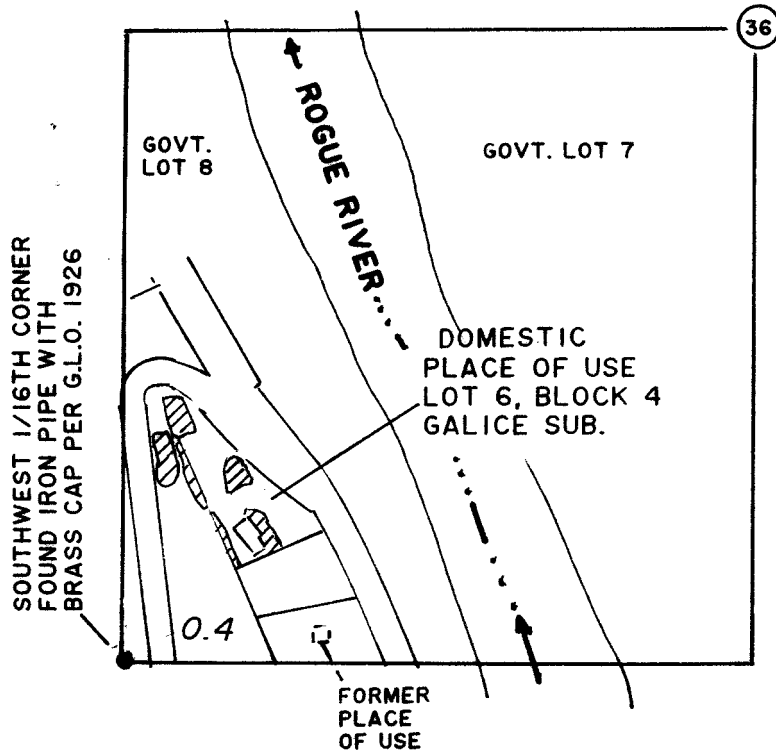

LICENSE RENEWAL DATE:
JUNE 30, 2002

= 0.4 ACRES IRRIGATED LAWN & GARDEN



MAP SHOWING
POINT OF DIVERSION
SCALE: 2" = 1 MILE

NE 1/4, NE 1/4
SECTION 35

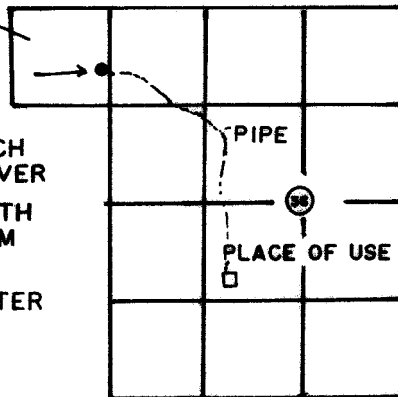

POINT OF DIVERSION:
SOUTH FORK ROCKY GULCH
TRIBUTARY OF ROGUE RIVER

LOCATED 800 FEET SOUTH
AND 90 FEET WEST FROM
NE CORNER SECTION 35

GALICE COMMUNITY WATER
SYSTEM

RECEIVED

SEP 13 2001

WATER RESOURCES DEPT.
SALEM, OREGON

THIS MAP IS FOR THE PURPOSE OF
IDENTIFYING THE LOCATION OF THE
WATER RIGHT ONLY, AND IS NOT IN-
TENDED TO PROVIDE LEGAL DIMEN-
SIONS OR LOCATIONS OF PROPERTY
OWNERSHIP LINES.

T. 34 S., R. 8 W., W.M.

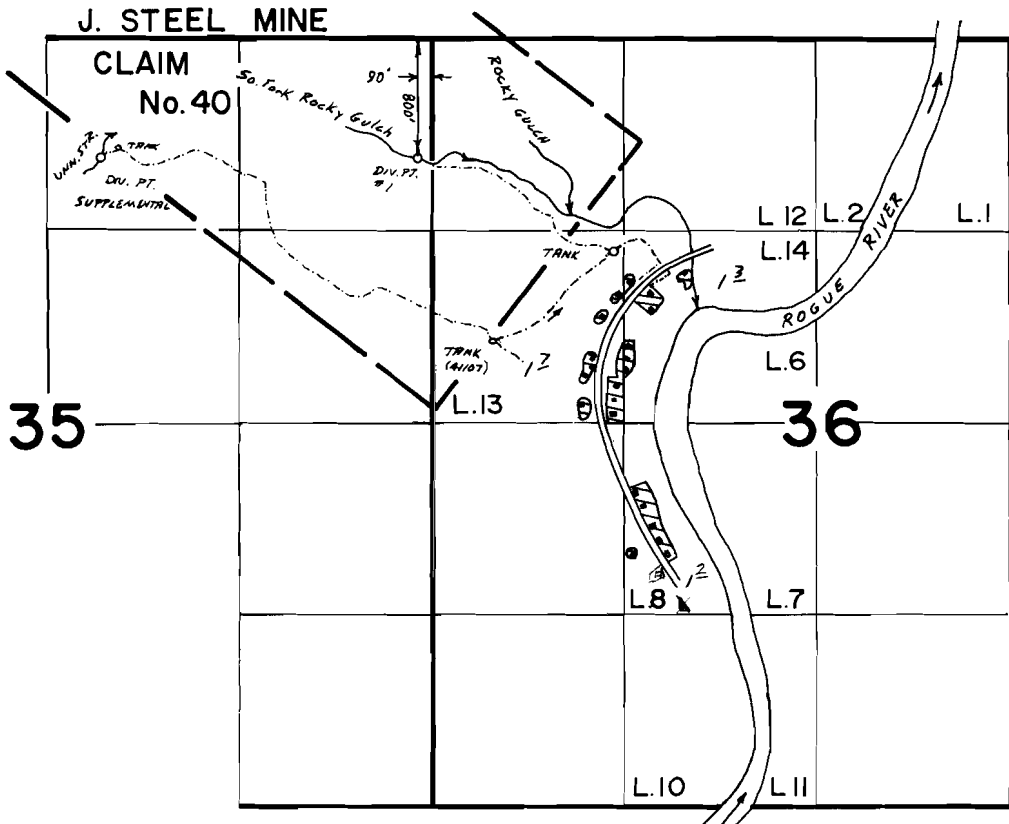

■ = HOUSE

Scale 1" = 1320'

FINAL PROOF SURVEY UNDER

Application No. 54333.. Permit No. 40733...
IN NAME OF

GALICE.....SUBDIVISION WATER CO.

Surveyed JUNE 21 1984, by BS. JAMES.....