

T. 4 N., R. 25 E. W. M.

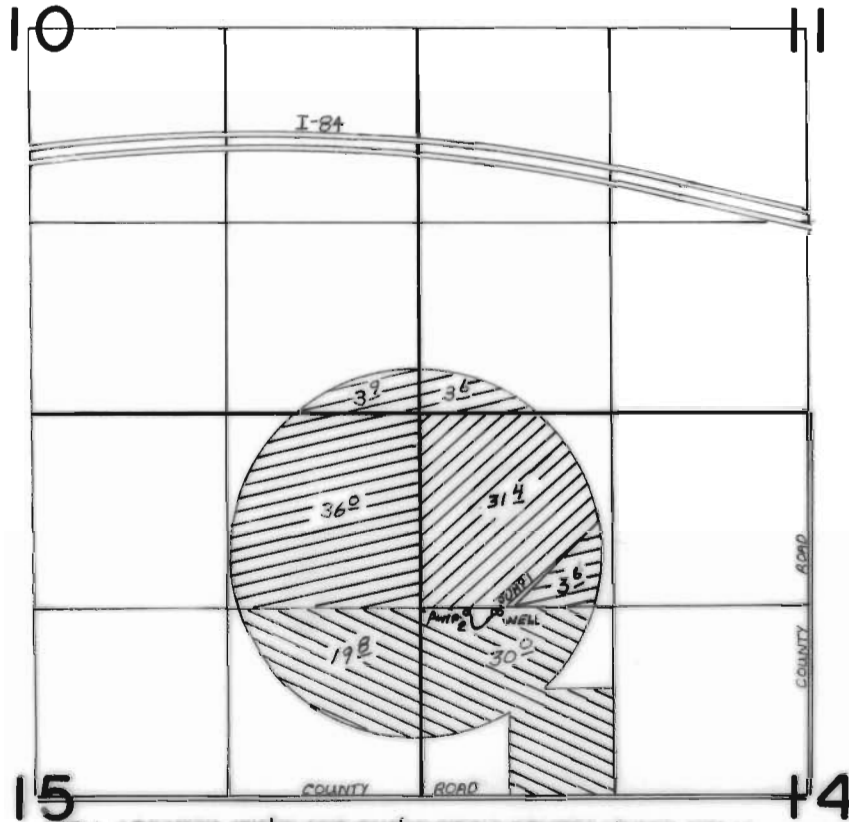
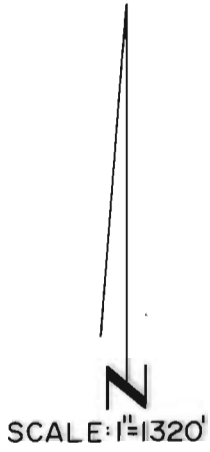

WELL LOCATED 1310' N. AND 2110' W. FROM CENTER 1/4 COR. SEC. 14
 PUMP 1 LOCATED 1310' N. AND 2140' W. FROM CENTER COR. SEC. 14
 PUMP 2 LOCATED 1310' N. AND 2350' W. FROM CENTER COR. SEC. 14

PRIMARY PER. 46207
 SUPPL. PER. G-9516

PER. 46207 & G-9516
 SUPPL.

PER. G-9516 SUPPL.
 PER. 46207 SUPPL.

FINAL PROOF SURVEY UNDER

G-10034 G-9516
 Application No. 61029 Permit No. 46207.....
 IN NAME OF

ROBERT G. SICARD & SONS

Surveyed FEB. 19..... 1985., by V.L. CHURCH.....